

September 14, 2024
 thru March 28, 2025
 Del 14 de septiembre de 2024
 al 28 de marzo de 2025

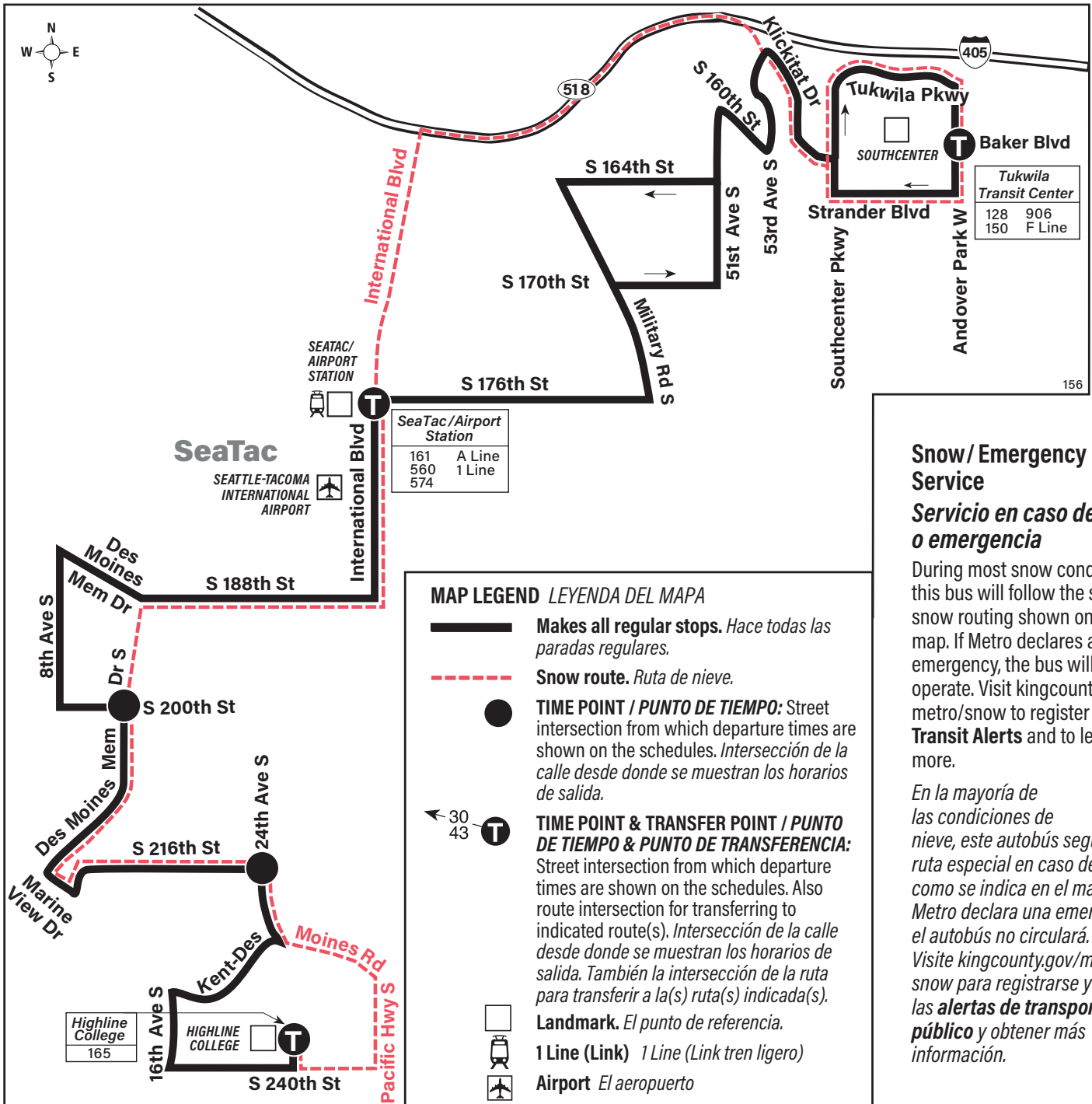

Snow / Emergency Service

Servicio en caso de nieve o emergencia

During most snow conditions, this bus will follow the special snow routing shown on the map. If Metro declares an emergency, the bus will not operate. Visit kingcounty.gov/metro/snow to register for **Transit Alerts** and to learn more.

En la mayoría de las condiciones de nieve, este autobús seguirá la ruta especial en caso de nieve como se indica en el mapa. Si Metro declara una emergencia, el autobús no circulará. Visite kingcounty.gov/metro/snow para registrarse y recibir las **alertas de transporte público** y obtener más información.

Route 156 Monday thru Friday to Southcenter

Servicio de lunes a viernes a Southcenter

| | Des Moines | | SeaTac/Airport Station | Southcenter |
|------------------|-------------------------|----------------------------------|---------------------------|------------------|
| Highline College | 24th Ave S & S 216th St | S 200th St & Des Moines Mem Dr S | S 176th St & Int'l Blvd S | Tukwila TC Bay 1 |
| Stop #47260 | Stop #47403 | Stop #49110 | Stop #60902 | Stop #59312 |
| 5:03 | 5:10 | 5:16 | 5:27 | 5:40 |
| 5:33 | 5:40 | 5:46 | 5:57 | 6:10 |
| 6:03 | 6:10 | 6:16 | 6:27 | 6:40 |
| 6:18 | 6:25 | 6:31 | 6:42 | 6:56 |
| 6:33 | 6:40 | 6:46 | 6:57 | 7:11 |
| 6:48 | 6:55 | 7:01 | 7:12 | 7:26 |
| 7:02 | 7:09 | 7:15 | 7:28 | 7:42 |
| 7:18 | 7:26 | 7:32 | 7:45 | 8:00 |
| 7:32 | 7:40 | 7:46 | 7:59 | 8:14 |
| 8:03 | 8:11 | 8:17 | 8:29 | 8:44 |
| 8:33 | 8:41 | 8:47 | 8:59 | 9:14 |
| 9:03 | 9:11 | 9:17 | 9:29 | 9:44 |
| 9:33 | 9:41 | 9:47 | 9:59 | 10:14 |
| 10:03 | 10:11 | 10:17 | 10:29 | 10:44 |
| 10:33 | 10:41 | 10:47 | 10:59 | 11:14 |
| 11:03 | 11:11 | 11:17 | 11:29 | 11:44 |
| 11:31 | 11:39 | 11:45 | 11:57 | 12:12 |
| 12:01 | 12:09 | 12:15 | 12:27 | 12:43 |
| 12:31 | 12:39 | 12:45 | 12:57 | 1:13 |
| 1:01 | 1:09 | 1:15 | 1:28 | 1:44 |
| 1:31 | 1:39 | 1:45 | 1:58 | 2:14 |
| 2:01 | 2:09 | 2:15 | 2:28 | 2:44 |
| 2:30 | 2:38 | 2:45 | 2:59 | 3:16 |
| 2:59 | 3:07 | 3:14 | 3:28 | 3:45 |
| 3:29 | 3:37 | 3:44 | 3:58 | 4:15 |
| 3:59 | 4:07 | 4:13 | 4:27 | 4:44 |
| 4:29 | 4:37 | 4:43 | 4:56 | 5:13 |
| 4:59 | 5:07 | 5:13 | 5:26 | 5:42 |
| 5:29 | 5:37 | 5:43 | 5:55 | 6:11 |
| 6:02 | 6:09 | 6:15 | 6:27 | 6:43 |
| 6:32 | 6:39 | 6:45 | 6:56 | 7:12 |
| 7:02 | 7:09 | 7:15 | 7:25 | 7:41 |
| 7:32 | 7:39 | 7:45 | 7:55 | 8:11 |
| 8:32 | 8:39 | 8:45 | 8:55 | 9:11 |
| 9:39 | 9:46 | 9:51 | 10:01 | 10:16 |

Bold PM time

Route 156 Monday thru Friday to Des Moines

Servicio de lunes a viernes a Des Moines

| Southcenter | SeaTac/Airport Station | | Des Moines | Highline College |
|------------------|---------------------------|----------------------------------|-------------------------|------------------|
| Tukwila TC Bay 1 | S 176th St & Int'l Blvd S | S 200th St & Des Moines Mem Dr S | 24th Ave S & S 216th St | Highline College |
| Stop #59312 | Stop #60903 | Stop #50330 | Stop #47419 | Stop #47260 |
| 5:55 | 6:07 | 6:17 | 6:24 | 6:33 |
| 6:25 | 6:37 | 6:47 | 6:54 | 7:03 |
| 6:55 | 7:07 | 7:17 | 7:25 | 7:36 |
| 7:10 | 7:22 | 7:32 | 7:40 | 7:51 |
| 7:25 | 7:37 | 7:47 | 7:55 | 8:06 |
| 7:40 | 7:52 | 8:02 | 8:10 | 8:21 |
| 7:55 | 8:07 | 8:17 | 8:25 | 8:36 |
| 8:13 | 8:25 | 8:35 | 8:43 | 8:54 |
| 8:27 | 8:39 | 8:50 | 8:57 | 9:08 |
| 8:57 | 9:09 | 9:20 | 9:27 | 9:36 |
| 9:27 | 9:39 | 9:50 | 9:57 | 10:06 |
| 9:57 | 10:09 | 10:20 | 10:27 | 10:36 |
| 10:27 | 10:39 | 10:50 | 10:57 | 11:07 |
| 10:57 | 11:09 | 11:20 | 11:27 | 11:36 |
| 11:27 | 11:39 | 11:50 | 11:57 | 12:06 |
| 11:57 | 12:10 | 12:21 | 12:28 | 12:37 |
| 12:27 | 12:40 | 12:51 | 12:59 | 1:08 |
| 12:57 | 1:10 | 1:21 | 1:29 | 1:38 |
| 1:27 | 1:40 | 1:51 | 1:59 | 2:08 |
| 1:57 | 2:10 | 2:22 | 2:30 | 2:40 |
| 2:27 | 2:41 | 2:53 | 3:01 | 3:12 |
| 2:57 | 3:11 | 3:24 | 3:32 | 3:43 |
| 3:30 | 3:44 | 3:58 | 4:06 | 4:17 |
| 3:59 | 4:13 | 4:27 | 4:35 | 4:46 |
| 4:29 | 4:43 | 4:57 | 5:05 | 5:16 |
| 4:58 | 5:12 | 5:26 | 5:34 | 5:44 |
| 5:27 | 5:41 | 5:54 | 6:02 | 6:12 |
| 5:57 | 6:10 | 6:22 | 6:30 | 6:40 |
| 6:27 | 6:40 | 6:51 | 6:58 | 7:08 |
| 6:57 | 7:10 | 7:21 | 7:28 | 7:37 |
| 7:25 | 7:38 | 7:49 | 7:56 | 8:05 |
| 7:54 | 8:07 | 8:17 | 8:24 | 8:33 |
| 8:51 | 9:04 | 9:14 | 9:21 | 9:30 |
| 9:50 | 10:03 | 10:13 | 10:20 | 10:29 |
| 10:50 | 11:01 | 11:11 | 11:17 | 11:26 |

Bold PM time

What To Pay Cuánto pagar

| | |
|--|--------|
| Adults (19 and older) <i>Adultos</i> (19 años y mayor) | \$2.75 |
| Children and Youth (0-18 yrs) <i>Niños y jóvenes</i> (0-18 años) | FREE |
| ORCA LIFT Fare* <i>Tarifa ORCA LIFT*</i> | \$1.00 |
| RRFP cardholders , (registered seniors 65+, riders with disabilities, Medicare card holders) <i>Titulares de Regional Reduced Fare Permit</i> (RRFP, Tarjeta Regional de Descuento), (adultos mayores de 65 años registrados, pasajeros con discapacidades, titulares de tarjetas de Medicare) | \$1.00 |

*Income Qualified *Ingresos que reúnan los requisitos

Holiday Information

Información sobre días festivos

This route will operate its Sunday schedule on the following holidays. *Esta ruta operará según su horario de domingo en los siguientes días festivos.*

| | |
|---------------------------------|------------------------------|
| Thanksgiving | Nov. 28 |
| <i>Día de acción de gracias</i> | <i>el 28 de noviembre</i> |
| Christmas | Dec. 25 |
| <i>Navidad</i> | <i>el 25 de diciembre</i> |
| New Year | Jan. 1, 2025 |
| <i>Año nuevo</i> | <i>el 1 de enero de 2025</i> |



Text your bus stop number to 62550 to get real-time bus arrival times on your mobile device.

Transit Alerts



Get service alerts and rider news by email or text. Register at kingcounty.gov/metro/signup

Route 156 Saturday to Southcenter

Servicio de al sábado a Southcenter

| | Des Moines | | SeaTac/Airport Station | Southcenter |
|---------------------|-------------------------|----------------------------------|---------------------------|------------------|
| Highline College | 24th Ave S & S 216th St | S 200th St & Des Moines Mem Dr S | S 176th St & Int'l Blvd S | Tukwila TC Bay 1 |
| Stop #47260 | Stop #47403 | Stop #49110 | Stop #60902 | Stop #59312 |
| 5:36 | 5:42 | 5:48 | 5:58 | 6:11 |
| 6:36 | 6:43 | 6:49 | 6:59 | 7:13 |
| 7:36 | 7:43 | 7:49 | 7:59 | 8:13 |
| 8:34 | 8:41 | 8:47 | 8:58 | 9:13 |
| 9:32 | 9:39 | 9:45 | 9:56 | 10:12 |
| 10:32 | 10:39 | 10:45 | 10:56 | 11:12 |
| 11:32 | 11:39 | 11:45 | 11:56 | 12:13 |
| 12:32 | 12:39 | 12:45 | 12:57 | 1:14 |
| 1:32 | 1:39 | 1:45 | 1:57 | 2:14 |
| 2:32 | 2:39 | 2:45 | 2:57 | 3:14 |
| 3:32 | 3:39 | 3:45 | 3:57 | 4:14 |
| 4:32 | 4:39 | 4:45 | 4:56 | 5:13 |
| 5:32 | 5:39 | 5:44 | 5:55 | 6:12 |
| 6:32 | 6:39 | 6:44 | 6:55 | 7:11 |
| 7:34 | 7:41 | 7:46 | 7:56 | 8:12 |
| 8:36 | 8:43 | 8:48 | 8:58 | 9:13 |
| 9:37 | 9:44 | 9:49 | 9:59 | 10:13 |
| Bold PM time | | | | |

Route 156 Saturday to Des Moines

Servicio de al sábado a Des Moines

| | SeaTac/Airport Station | | Des Moines | |
|---------------------|---------------------------|----------------------------------|-------------------------|------------------|
| Southcenter | S 176th St & Int'l Blvd S | S 200th St & Des Moines Mem Dr S | 24th Ave S & S 216th St | Highline College |
| Stop #59312 | Stop #60903 | Stop #50330 | Stop #47419 | Stop #47260 |
| 5:26 | 5:37 | 5:47 | 5:53 | 6:00 |
| 6:26 | 6:37 | 6:47 | 6:53 | 7:01 |
| 7:26 | 7:37 | 7:47 | 7:53 | 8:01 |
| 8:26 | 8:38 | 8:48 | 8:54 | 9:02 |
| 9:26 | 9:39 | 9:49 | 9:56 | 10:04 |
| 10:26 | 10:39 | 10:49 | 10:56 | 11:04 |
| 11:26 | 11:39 | 11:50 | 11:57 | 12:06 |
| 12:26 | 12:39 | 12:50 | 12:57 | 1:06 |
| 1:26 | 1:40 | 1:51 | 1:58 | 2:07 |
| 2:26 | 2:40 | 2:51 | 2:59 | 3:08 |
| 3:27 | 3:41 | 3:52 | 4:00 | 4:09 |
| 4:26 | 4:40 | 4:51 | 4:59 | 5:08 |
| 5:26 | 5:40 | 5:51 | 5:59 | 6:08 |
| 6:26 | 6:40 | 6:51 | 6:58 | 7:07 |
| 7:26 | 7:39 | 7:50 | 7:57 | 8:06 |
| 8:26 | 8:39 | 8:50 | 8:57 | 9:06 |
| 9:26 | 9:38 | 9:48 | 9:55 | 10:04 |
| 10:25 | 10:37 | 10:47 | 10:53 | 11:01 |
| Bold PM time | | | | |

How to Pay

Métodos de pago

Always pay your fare when you board. Pay with your ORCA card, exact change (drivers do not carry cash), a bus ticket, or the Transit GO app. Show your activated Transit GO ticket or valid transfer (valid on Metro only) to the driver. See "How to Pay" on Metro's website for more information.

Pague siempre su tarifa cuando suba a bordo. Puede pagar con su tarjeta de transporte ORCA, cambio exacto (los conductores no llevan efectivo), boleto de autobús o la aplicación Transit GO. Muéstrela al conductor su boleto Transit GO activado o un boleto de transbordo válido (válidos solo en Metro). Consulte "How to Pay" (Métodos de pago) en kingcounty.gov/metro para obtener más información.

Route 156 Sunday to Southcenter

Servicio de domingo a Southcenter

| | Des Moines | | SeaTac/Airport Station | Southcenter |
|---------------------|-------------------------|----------------------------------|---------------------------|------------------|
| Highline College | 24th Ave S & S 216th St | S 200th St & Des Moines Mem Dr S | S 176th St & Int'l Blvd S | Tukwila TC Bay 1 |
| Stop #47260 | Stop #47403 | Stop #49110 | Stop #60902 | Stop #59312 |
| 5:25 | 5:31 | 5:36 | 5:46 | 5:59 |
| 6:25 | 6:32 | 6:37 | 6:47 | 7:00 |
| 7:25 | 7:32 | 7:37 | 7:47 | 8:00 |
| 8:25 | 8:32 | 8:38 | 8:48 | 9:02 |
| 9:25 | 9:32 | 9:38 | 9:48 | 10:02 |
| 10:22 | 10:29 | 10:35 | 10:46 | 11:01 |
| 11:22 | 11:29 | 11:35 | 11:46 | 12:01 |
| 12:22 | 12:29 | 12:35 | 12:46 | 1:01 |
| 1:22 | 1:29 | 1:35 | 1:46 | 2:02 |
| 2:22 | 2:29 | 2:35 | 2:46 | 3:02 |
| 3:22 | 3:29 | 3:35 | 3:46 | 4:02 |
| 4:21 | 4:28 | 4:34 | 4:45 | 5:01 |
| 5:23 | 5:30 | 5:35 | 5:46 | 6:02 |
| 6:23 | 6:30 | 6:35 | 6:46 | 7:02 |
| 7:25 | 7:32 | 7:37 | 7:48 | 8:02 |
| 8:25 | 8:32 | 8:37 | 8:48 | 9:02 |
| 9:27 | 9:34 | 9:39 | 9:49 | 10:02 |
| Bold PM time | | | | |

Route 156 Sunday to Des Moines

Servicio de domingo a Des Moines

| | SeaTac/Airport Station | | Des Moines | |
|---------------------|---------------------------|----------------------------------|-------------------------|------------------|
| Southcenter | S 176th St & Int'l Blvd S | S 200th St & Des Moines Mem Dr S | 24th Ave S & S 216th St | Highline College |
| Stop #59312 | Stop #60903 | Stop #50330 | Stop #47419 | Stop #47260 |
| 6:13 | 6:23 | 6:32 | 6:38 | 6:46 |
| 7:13 | 7:24 | 7:33 | 7:39 | 7:47 |
| 8:13 | 8:24 | 8:33 | 8:39 | 8:47 |
| 9:13 | 9:24 | 9:33 | 9:40 | 9:49 |
| 10:15 | 10:26 | 10:35 | 10:42 | 10:51 |
| 11:14 | 11:26 | 11:36 | 11:43 | 11:52 |
| 12:14 | 12:26 | 12:36 | 12:43 | 12:52 |
| 1:14 | 1:28 | 1:38 | 1:45 | 1:54 |
| 2:14 | 2:28 | 2:38 | 2:45 | 2:54 |
| 3:14 | 3:28 | 3:38 | 3:45 | 3:54 |
| 4:14 | 4:28 | 4:38 | 4:45 | 4:54 |
| 5:15 | 5:29 | 5:40 | 5:47 | 5:56 |
| 6:16 | 6:30 | 6:40 | 6:47 | 6:56 |
| 7:16 | 7:30 | 7:40 | 7:47 | 7:56 |
| 8:16 | 8:28 | 8:38 | 8:45 | 8:54 |
| 9:15 | 9:27 | 9:37 | 9:43 | 9:52 |
| 10:14 | 10:25 | 10:35 | 10:41 | 10:50 |
| Bold PM time | | | | |

ORCA Card

Use your ORCA card to travel on Metro, Community Transit, Everett Transit, Kitsap Transit, Pierce Transit, Sound Transit, Seattle Streetcar, King County Water Taxi, the Seattle Center Monorail and Washington State Ferries. The ORCA card can accommodate a cash purse and/or a monthly pass, and it automatically tracks the value of your fares and transfers.

Get your ORCA card by one of the following methods.

- Online at www.myORCA.com
- By phone at 1-888-988-6722 (ORCA) or WA Relay: 711 (1-888-889-6368). Non-English 1-800-823-9230.
- At ticket vending machines in Sounder and Link stations
- At a transit agency customer service office

The ORCA website, www.myORCA.com, and any agency customer service office provide information on how to buy and use the card.

Online Trip Planning

Use our Trip Planner to plan trips in King, Pierce, and Snohomish counties. Trip Planner provides details on transit stops, routes, and schedules. The transportation agencies and modes covered by Trip Planner include Metro Transit, Pierce Transit, Community Transit, Everett Transit, ST Express buses, Link trains, Sounder trains, King County Water Taxi, Washington State Ferries, the Seattle Center Monorail and Seattle Streetcar.

Trip Planner does not include information regarding service disruptions and reroutes caused by weather, emergencies, traffic, entertainment events or construction.



This symbol indicates a change in service. Watch for it in buses, at bus stops and at timetable displays.