



King County

Department of
Natural Resources and Parks
Solid Waste Division

Waste
Prevention

Resource
Recovery

Waste
Disposal

South County Recycling and Transfer Station

Design Advisory Group Meeting 5, July 1, 2021, 2 – 4 p.m.

A Few Housekeeping Items

- Use "raise hand" function for questions or comments
- Please mute when not speaking
- Camera on is encouraged!
- Feel free to use the chat box
- Access needs
- If any technical issues arise...

Agenda

- Welcome and introductions
- Icebreaker
- Charter review
- Project overview and design updates
- Public art update by 4Culture
- Community engagement, and equity and social justice
- Next steps
- Thank you and wrap-up

Welcome!

Dawn Dofelmire, City of Algona

Joan Nelson, City of Auburn

Leanne Guier, City of Pacific

Bill McCauley, community resident

Jason Shea, Waste Management

Tina Steiner, Terra Dynamics

Rob Van Orsow, City of Federal Way

King County

- Karen Herndon
- Polly Young
- Tricia Barbachan

HDR team

- Clark Davis
- Ryan Asman
- Dennis Sandstrom
- Harrison Price

4Culture

- Laura Becker

Icebreaker

Follow link in chat, or go to **menti.com** and enter the code **7774 0461**

Charter Review

- Roles and responsibilities
- Time commitment
- Expectations and ground rules

Do you have any suggested changes or updates?

Project Summary

New station will offer...

- Recycling services and moderate risk waste disposal for households and small businesses
- Sustainable building features
- Off-site improvements
- On-site creek enhancements
- Public art installed on-site
- Other community benefits

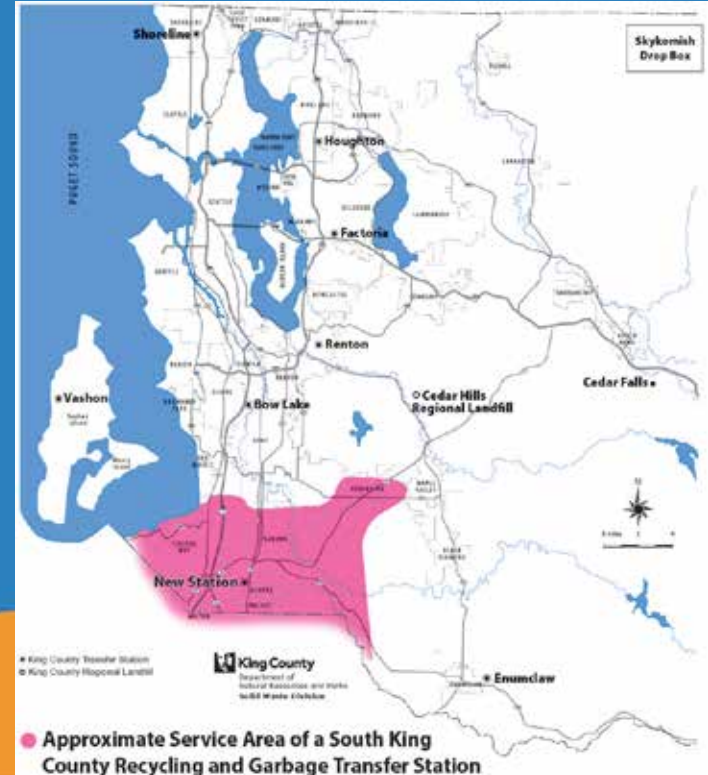

Project Description - Services to be Provided



Recycling



Yard Waste



Moderate
Risk Waste



Garbage



King County

Department of
Natural Resources and Parks
Solid Waste Division

Project Description - Additional Project Elements



Stream
Relocation
and Wetlands
Mitigation



Road
Improvements



Storm water
management



Green
Building



Public Art

Timeline



Changes Since We Last Met

- Site entrance optimized to improve traffic flow to scale plaza
- A setback is being provided from steep hillside at south end of site
- Additional landscaping added near Administration Building
- Rainwater harvesting cisterns are now below ground
- Added provisions for a lighted intersection in case needed in the future
- Yellow blinking light at Iowa Drive
- Addition of a canopy at the Fueling Facility

60% Overall Site Plan

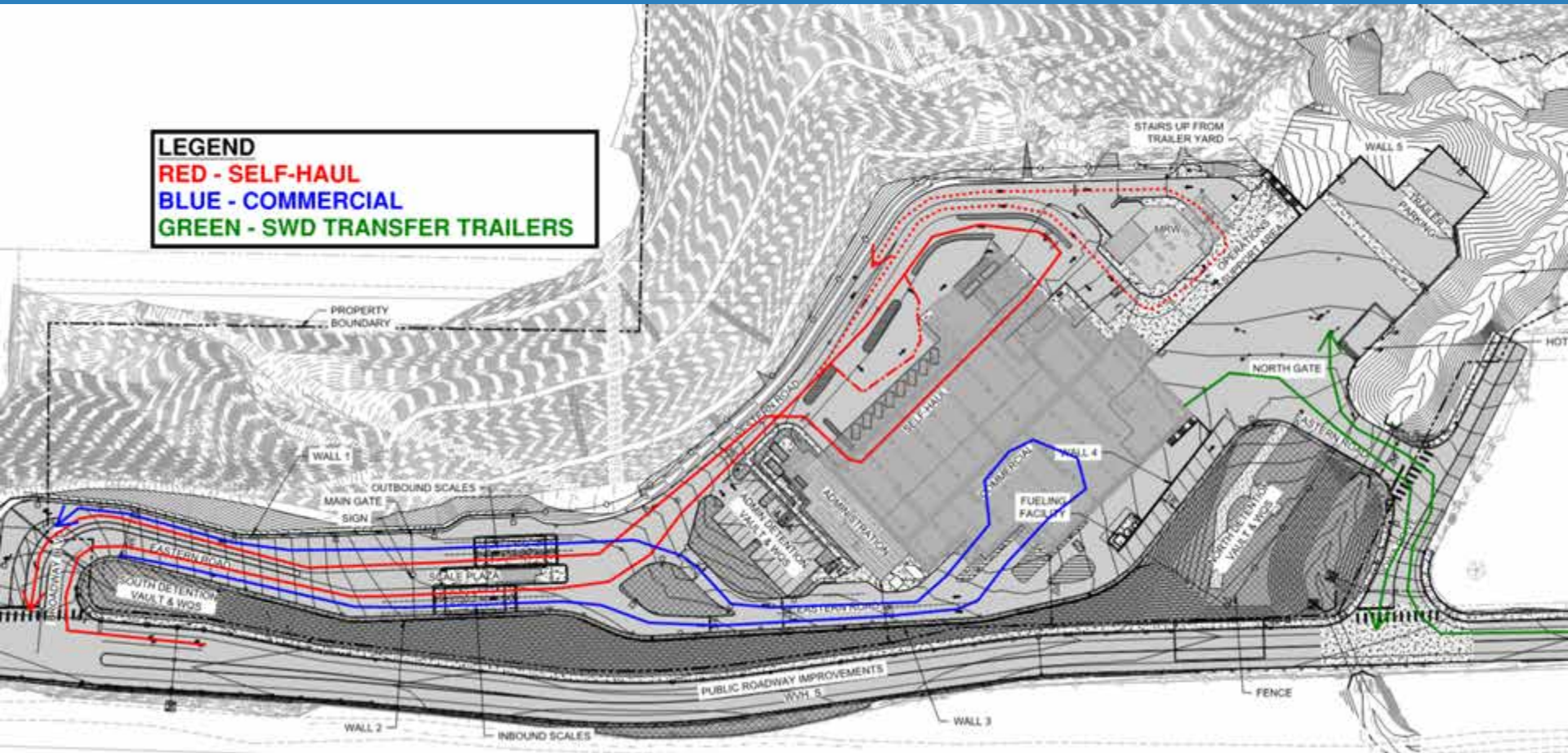

Entrance and Scale Plaza

Changes

- Shifted wall 1 away from the hillside
- Straightened approach to scale plaza
- Changed weigh scale type

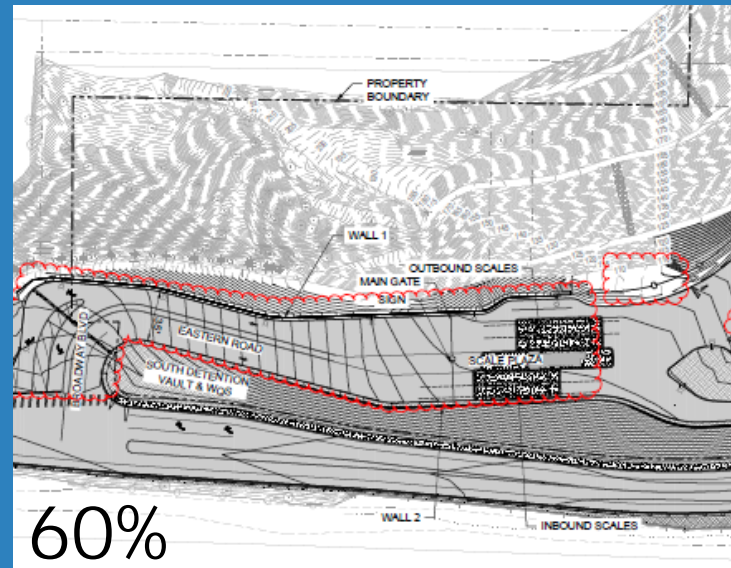
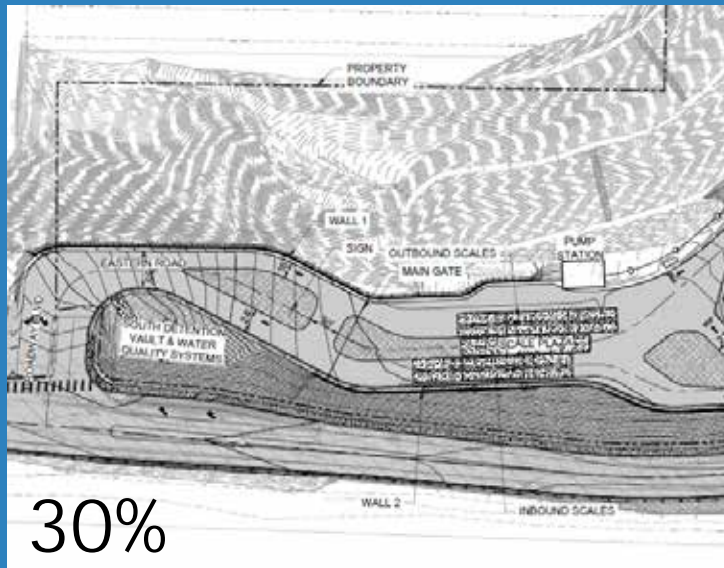



Drop-off Canopy at MRW Facility

Administration and Transfer Building

Changes

- Increased landscape area
- Simplified parking lot
- Added a canopy to the fuel facility

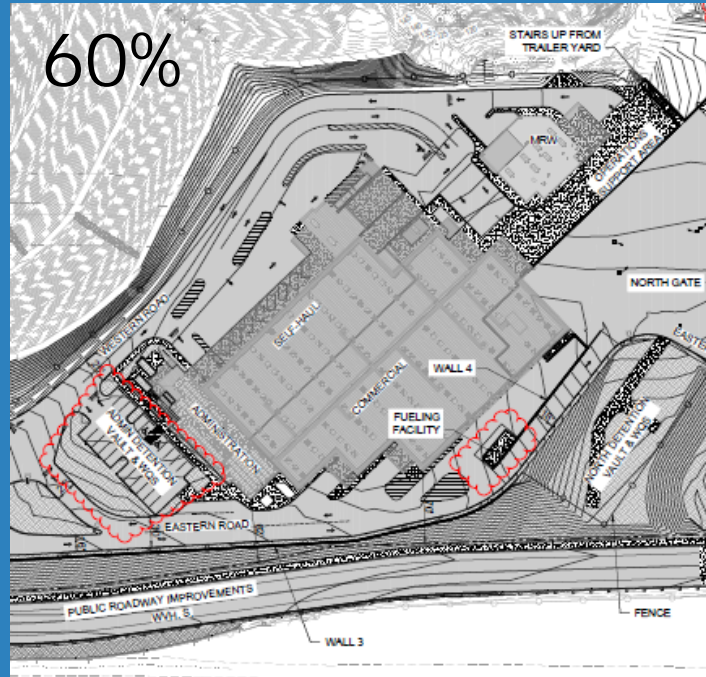
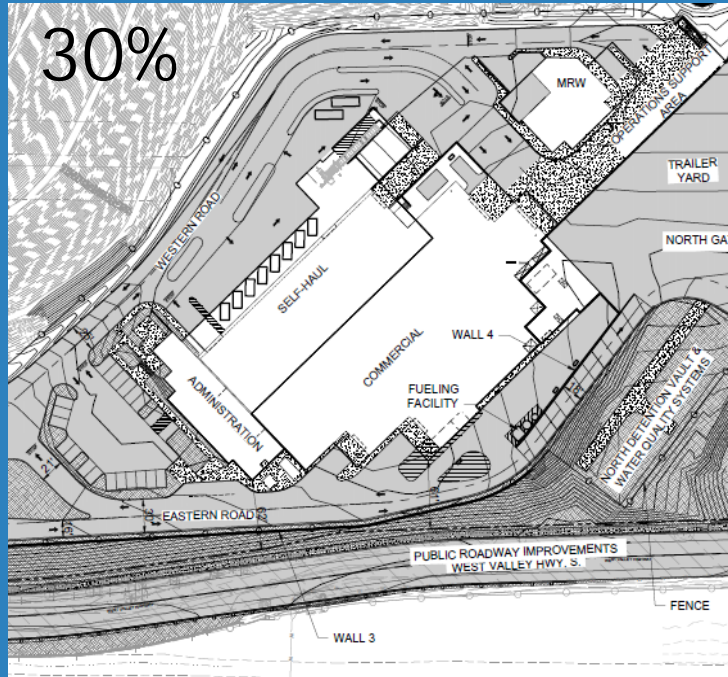

Moderate Risk Waste, Trailer Parking and Stream Re-alignment

Changes

- Added containment vaults for MRW facility
- Re-aligned stream to resemble a more natural meander
- Made enhancements to fish habitat

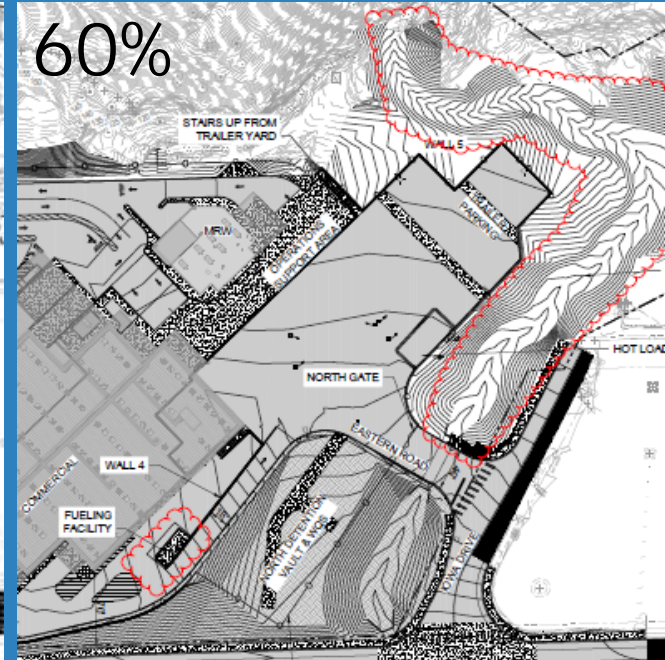
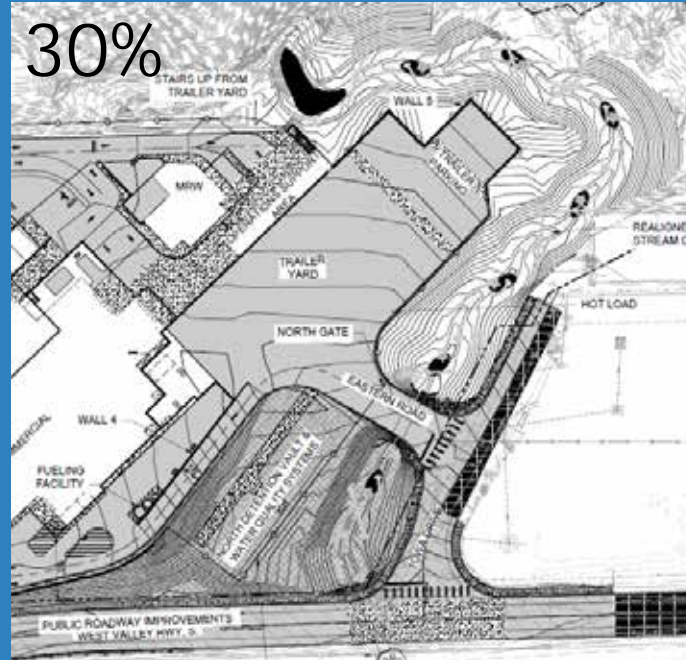

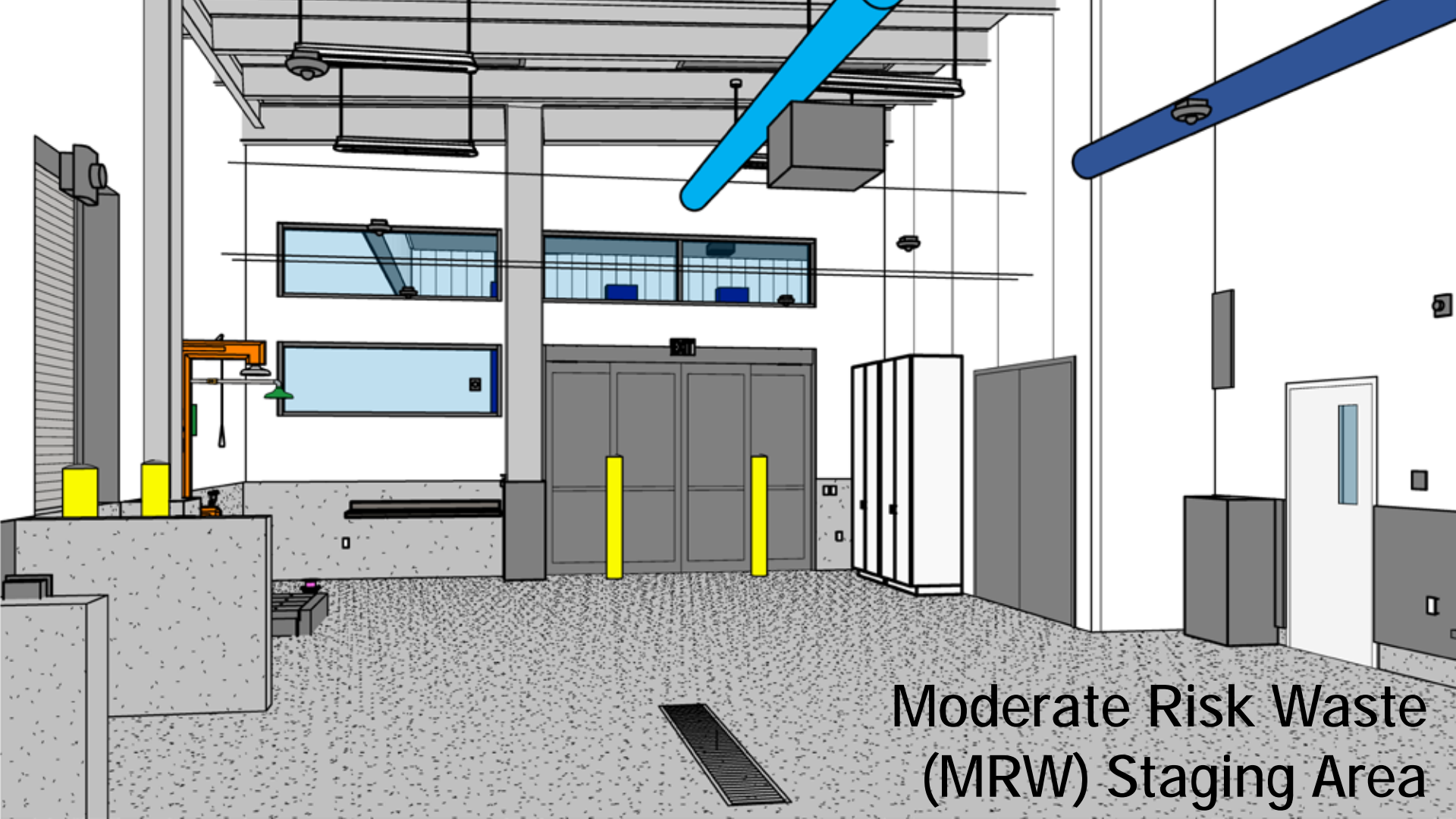

Moderate Risk Waste
(MRW) Staging Area

Sustainability and Environmental Update

- Environmental protection
- Separating clean stormwater from sanitary flows
- Improved habitat
- Noise, odor, glare, surface, and water protections

Questions?

1. What would you like to see in the design that would make a trip here a more positive experience?
 - Self-haul
 - Recycling
 - Moderate Risk Waste (MRW)
2. What could be added as educational features that would promote recycling and environmental stewardship?

Lobby and Multipurpose Room



Follow link in chat or go to menti.com and enter the code **7474 6213**



View of the
outdoor
receiving
area, or
patio





View from
the lobby
to the
outdoor
receiving
area, or
patio



King County

Department of
Natural Resources and Parks
Solid Waste Division



View from
the lobby
to the
multi-
purpose
room



King County

Department of
Natural Resources and Parks
Solid Waste Division

Questions?

1. What could be added to the design that would identify community awareness and values?
2. What materials would you like to see more of expressed in the facility structures?
3. What types of plantings would you like to see in the new landscaping?



SOUTH COUNTY RECYCLING & TRANSFER STATION DESIGN ADVISORY GROUP PUBLIC ART UPDATE

JULY 1, 2021





PUBLIC ART PROCESS – PART ONE

PHASE 1: PLANNING

- MEET WITH THE SWD TO REVIEW PROJECT GOALS.
- VISIT THE PROJECT SITE AND SURROUNDS.
- MEET WITH ADVISORY OR COMMUNITY GROUPS RELATED TO THE PROJECT.
- SHARE PUBLIC ART EXAMPLES TO PRESENT POSSIBILITIES AND ARTICULATE ASPIRATIONS FOR THE PROJECT AND ITS ARTWORK.
- DEVELOP A SCOPE OF WORK, INCLUDING A BUDGET, TIMELINE, AND ARTIST SELECTION PROCESS.
- DEVELOP A PANELIST ROSTER.
- PRESENT THE SCOPE OF WORK AND PANELIST ROSTER TO THE 4CULTURE PUBLIC ART ADVISORY COMMITTEE (PAAC) FOR APPROVAL.





PUBLIC ART PROCESS – PART ONE

PHASE 2: ARTIST SELECTION

- DEVELOP PROJECT SPECIFICS AND INFORMATION PACKET FOR THE PUBLIC ART OPPORTUNITY AND REVIEW WITH CLIENT.
- SOLICIT ARTIST APPLICATIONS THROUGH AN OPEN CALL: 4CULTURE PUBLISHES AN RFQ, WITH SPECIFIC ELIGIBILITY REQUIREMENTS.
- FACILITATE A PANEL REVIEW PROCESS TO SELECT ARTIST(S) FOR THE PROJECT (PANEL COMPRISED OF 3 ARTISTS, 1 SWD REPRESENTATIVE & 1 COMMUNITY MEMBER)
- DEVELOP COMMUNICATIONS MATERIALS TO ANNOUNCE SELECTION OF ARTIST(S).

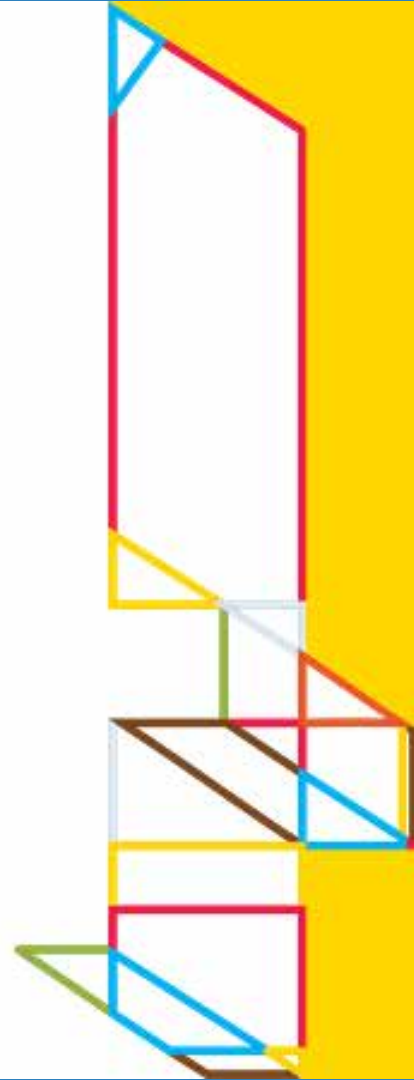



TWO PUBLIC ART PROJECT FOR SCRTS



PROJECT #1:
SITE-BASED, SITE-INTEGRATED PERMANENT
ARTWORK OPPORTUNITY

SELECTED TEAM: MUCKLESHOOT INDIAN TRIBE







Puget Sound Environment a-MUSE-ment

Lightweight, waterproof, and easy to use, the a-MUSE-ment is a portable, interactive, and educational tool that can be used in a variety of settings. It is designed to be used by children and adults alike, and it is a great way to learn about the environment and the importance of sustainable living.

It is a great way to learn about the environment and the importance of sustainable living.

It is a great way to learn about the environment and the importance of sustainable living.

It is a great way to learn about the environment and the importance of sustainable living.

It is a great way to learn about the environment and the importance of sustainable living.

It is a great way to learn about the environment and the importance of sustainable living.

It is a great way to learn about the environment and the importance of sustainable living.

It is a great way to learn about the environment and the importance of sustainable living.

It is a great way to learn about the environment and the importance of sustainable living.

It is a great way to learn about the environment and the importance of sustainable living.

It is a great way to learn about the environment and the importance of sustainable living.

It is a great way to learn about the environment and the importance of sustainable living.

It is a great way to learn about the environment and the importance of sustainable living.

It is a great way to learn about the environment and the importance of sustainable living.

It is a great way to learn about the environment and the importance of sustainable living.

It is a great way to learn about the environment and the importance of sustainable living.

It is a great way to learn about the environment and the importance of sustainable living.

It is a great way to learn about the environment and the importance of sustainable living.

It is a great way to learn about the environment and the importance of sustainable living.

It is a great way to learn about the environment and the importance of sustainable living.

PUGET SOUND TRADITIONAL FOOD PRINCIPLES

In our conversations with different traditional food practitioners, we realized that many believe deeply-held concepts exist that are as applicable today as they were generations ago. We call these *Traditional Food Principles*. They address the physical and spiritual health of individuals and communities, in connection with the well-being of the land.



Cash and Cash with Good Friends

Cash is a traditional food principle that is based on the idea of sharing and community. It is a way of life that is rooted in the values of generosity and kindness.

Food is at the Center of Culture

Food is a central part of our culture and identity. It is a way of life that is rooted in the values of community and shared experiences.



Wild and Organic Foods are Better for Health

Wild and organic foods are better for health because they are more nutritious and contain fewer pesticides and other harmful chemicals.

Honor the Food Web & the Food Chain

Honoring the food web and the food chain is a way of life that is rooted in the values of respect and gratitude for all living beings.



Eat Local Foods

Eating local foods is a way of life that is rooted in the values of community and shared experiences.

Eat with the Seasons

Eating with the seasons is a way of life that is rooted in the values of respect and gratitude for all living beings.

Traditional Foods are Whole Foods

Traditional foods are whole foods because they are made from natural ingredients and contain no artificial additives or preservatives.

Eat a Variety of Foods

Eating a variety of foods is a way of life that is rooted in the values of respect and gratitude for all living beings.



Support our Puget Sound Community

Supporting our Puget Sound community is a way of life that is rooted in the values of respect and gratitude for all living beings.

Join the Puget Sound

Joining the Puget Sound community is a way of life that is rooted in the values of respect and gratitude for all living beings.

Traditional Food Principles

Traditional food principles are a way of life that is rooted in the values of respect and gratitude for all living beings.

Traditional Food Principles

Traditional food principles are a way of life that is rooted in the values of respect and gratitude for all living beings.

Traditional Food Principles

Traditional food principles are a way of life that is rooted in the values of respect and gratitude for all living beings.

Traditional Food Principles

Traditional food principles are a way of life that is rooted in the values of respect and gratitude for all living beings.

Traditional Food Principles

Traditional food principles are a way of life that is rooted in the values of respect and gratitude for all living beings.

Traditional Food Principles

Traditional food principles are a way of life that is rooted in the values of respect and gratitude for all living beings.

Traditional Food Principles

Traditional food principles are a way of life that is rooted in the values of respect and gratitude for all living beings.



PROJECT #2: SITE-BASED GENERATIVE ARTIST RESIDENCY

SELECTED ARTIST: EVAN BLACKWELL









PUBLIC ART PROCESS – PART TWO

PHASE 3: DESIGN

- EXECUTE DESIGN SERVICES CONTRACT AND SCOPE OF WORK.
- OVERSEE DESIGN DEVELOPMENT AND APPROVAL:
 - CLIENT RESONANCE
 - PAAC DESIGN REVIEW
- OVERSEE INTEGRATION OF ART DESIGN INTO CONSTRUCTION DOCUMENTS AND NEGOTIATE FABRICATION AND INSTALLATION ROLES.

PHASE 4: IMPLEMENTATION

- EXECUTE IMPLEMENTATION SERVICES CONTRACT AND SCOPE OF WORK.
- OVERSEE FABRICATION OF ARTWORK.
- OVERSEE ON-SITE INSTALLATION OF ARTWORK.
- DEVELOP ARTWORK MAINTENANCE PLAN WITH ARTIST AND REVIEW WITH CLIENT.
- DEVELOP COMMUNICATIONS MATERIALS FOR THE ARTWORK.



ADVANCING COMMUNITY THROUGH CULTURE



LAURA ELIZABETH BECKER
SENIOR PUBLIC ART PROJECT MANAGER

LAURA.BECKER@4CULTURE.ORG
(206) 263-1617



ARTS HERITAGE PRESERVATION PUBLIC ART

Break (5 min)



Community Engagement

Public events

- Online open house (summer 2021)
- City of Pacific Community BBQ and Police Department Open House (Aug. 14)

Potential outreach strategies

- Website
- Signage
- Mailer
- Social media

Equity and Social Justice – Actions



Partner with the Local Food Initiative and Public Health-Seattle & King County to support farming in south King County



Work with a local non-profit to fund and implement green apprenticeship opportunities in the SCRTS service area

Equity and Social Justice – Actions



Add educational, interactive exhibits at the new station with focus on environmental topics

Partner with the King County Parks to add amenities to segments of the Interurban Trail

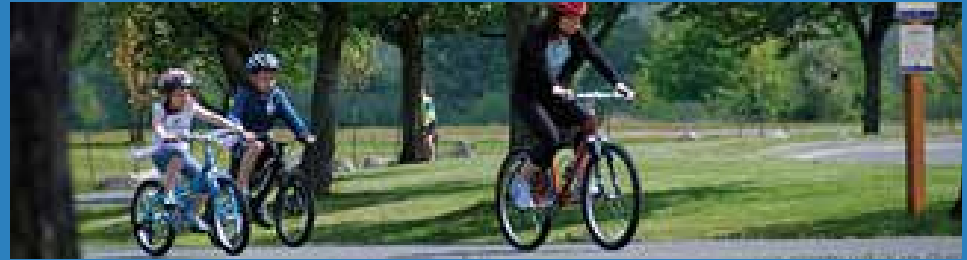

Community Engagement

1. How can we engage different communities (especially BIPOC or under-represented) on this project?
2. What could be added to the design that would promote social equity for the facility?
3. Any suggestions to make the community event as accessible and equitable as possible?

Next Steps

Do you know of anyone who would be interested in joining DAG or giving design input via a community interview?

Next meeting: Fall 2021

- Focus on 90% design
 - Incorporation of DAG, employee and community feedback

Thank you!



- What feedback do you have for the King County and HDR teams?
- Did you get information about SCRTS that you thought important?



King Street Center
201 South Jackson Street, Suite 5701
Seattle, WA 98104-3855
206-477-4466, TTY Relay: 711
kingcounty.gov/solid-waste