

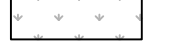



- LEGEND
-  PAVEMENT/NEW
  -  WETLAND
  -  COMPACTOR
  -  OPEN-TOP CONTAINER
  -  PROPERTY LINE



NOVEMBER 2010

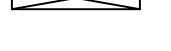

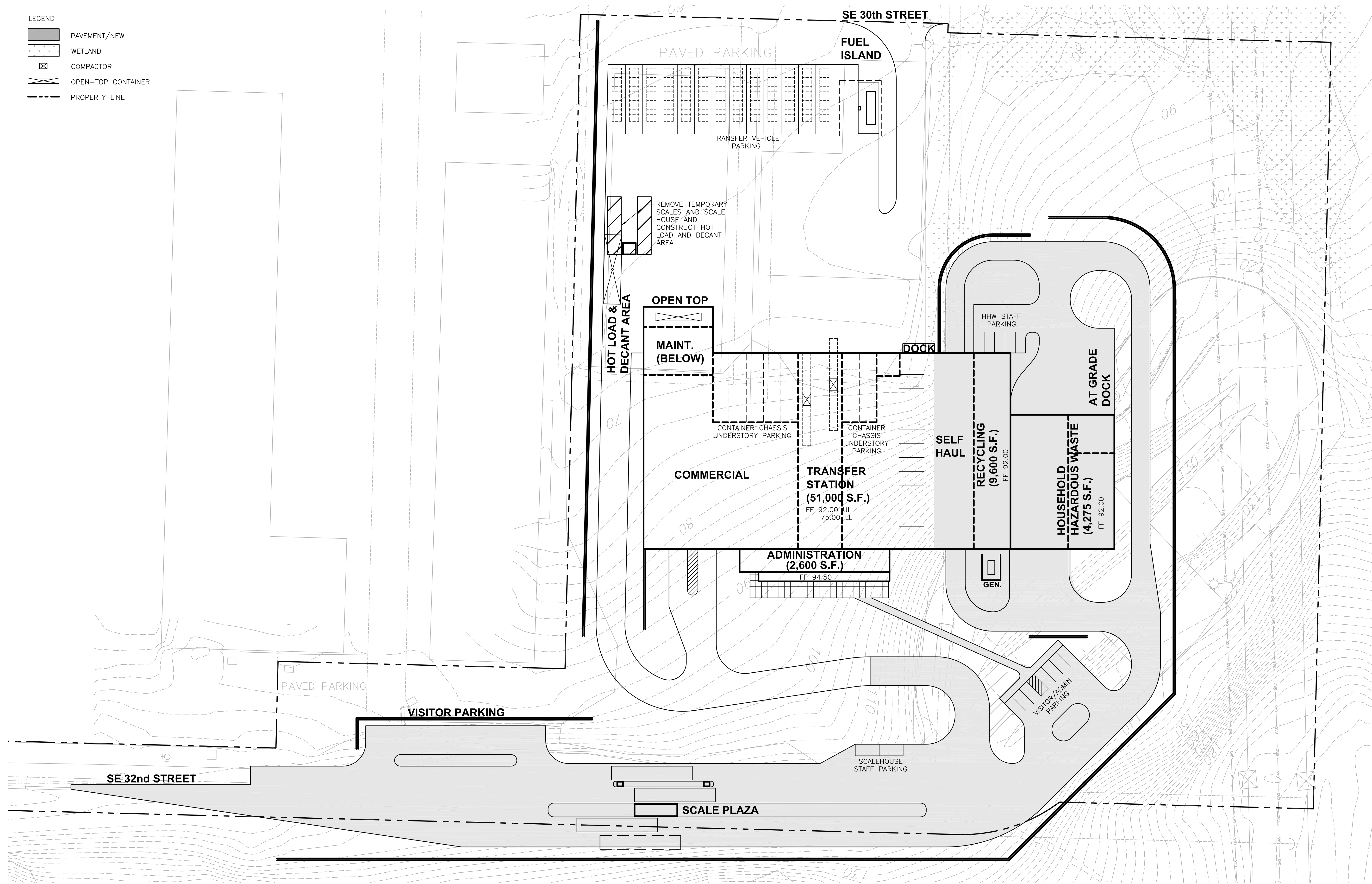
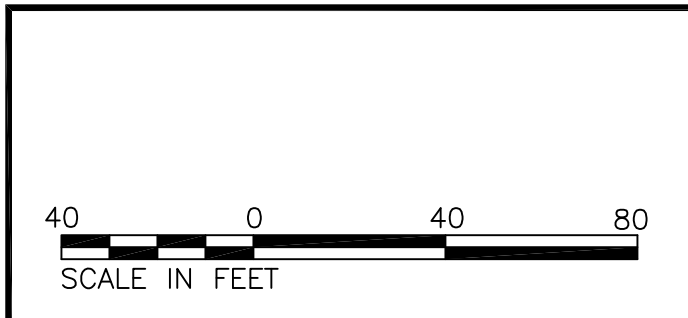
King County  
 Department of Natural Resources & Parks  
 Solid Waste Division  
**FACTORY RECYCLING AND  
 TRANSFER STATION**

**FIGURE 19  
 PHASE IV  
 CONSTRUCTION**