



**King County**

Department of Natural Resources and Parks  
Wastewater Treatment Division

## NORTH MERCER ISLAND/ENATAI

## Sewer Upgrade Project

# North Mercer Pump Station Gets an Upgrade

## *What's Happening... and Why*

The North Mercer Pump Station is in the northern edge of the Mercer Island/Enatai Sewer Upgrade Project. The existing facility is located in a residential area of Mercer Island north of I-90 and west of Luther Burbank Park. Upgrades to the facility were not originally included in the project.

As the design of the sewer pipeline upgrade advanced, it became clear that the pipeline changes would require pump station improvements at the same time. The old station just wouldn't work with the design for the new sewer line. Upgrading the pump station now will ensure that it is compatible with the new pipeline, address the condition of aging equipment, and allow the system to handle the expected increase in sewer flows into the future.

The station's upgrade includes:

- New pumps to increase the station's capacity from 9 million gallons per day (mgd) to 10.5 mgd. A new generator to ensure that the pump station stays operational even during a power outage
- Upgraded odor control system
- Site improvements including a new retaining wall, screening wall, and landscaping.

Between 2015 and 2018, King County met with nearby neighbors to collect feedback on the new pump station's look and feel. Thank you to the community members who contributed. We appreciate your time and input.



*The existing North Mercer Island Pump Station (above)*

## Sewer Project Overview

*King County is upgrading four miles of sewer pipeline across north Mercer Island and south Bellevue. It's a big project that's been years in the making and will involve years of construction. Some work will be in heavily used public spaces, and some will be in residential areas. The upgrade will provide great public benefit, but the work to get there will involve inconveniences to residents and users of public spaces.*

*We are committed to keeping you informed about what's happening and why. This is one of a series of fact sheets that explain the North Mercer/Enatai (NME) Sewer Upgrade Project and what the public should expect—during construction and after the work is done.*

## Project Timeline

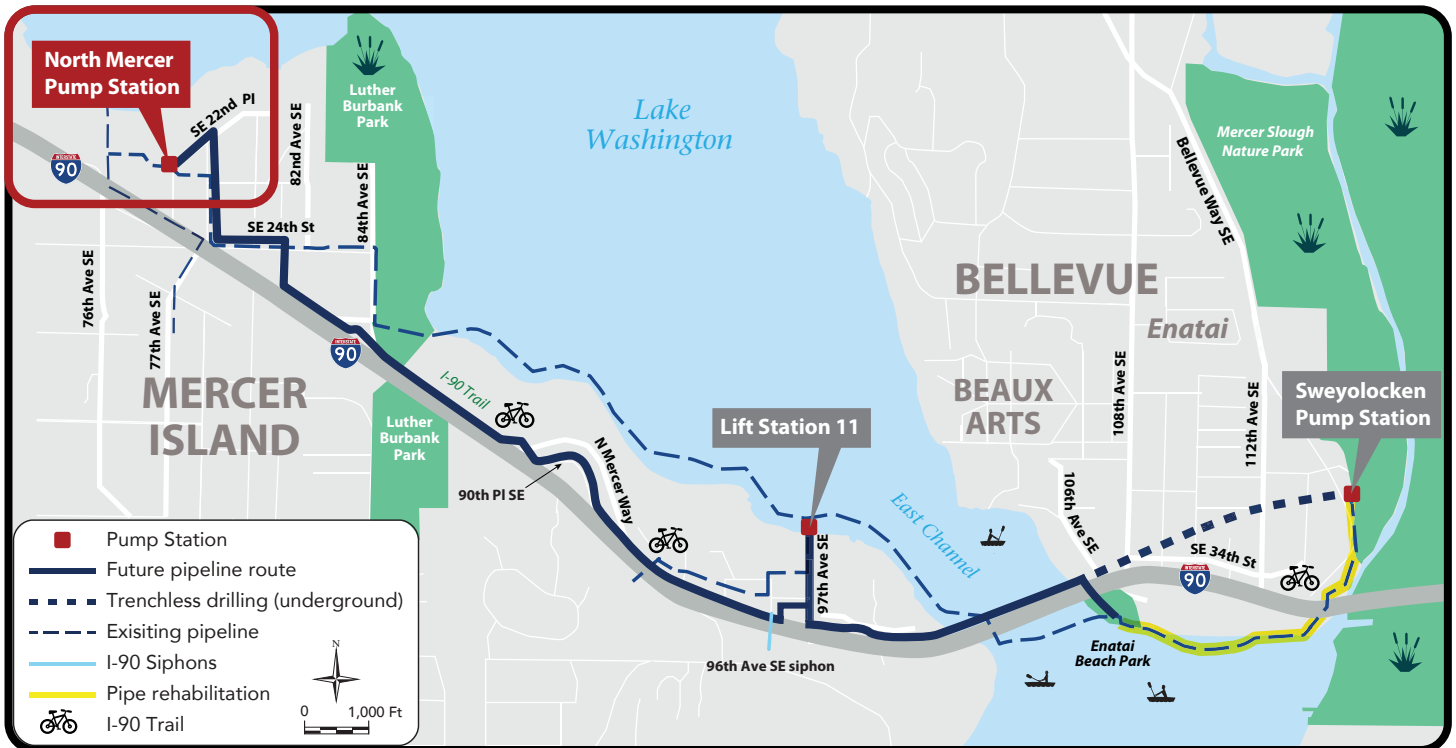
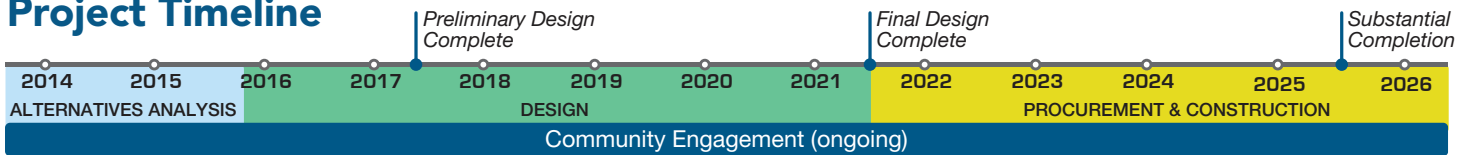

## What to Expect During Construction

- Noise and dust typical of construction
- Additional vehicle traffic on surrounding streets
- Construction equipment such as bulldozers, large trucks, backhoe, etc.
- Work hours primarily during the daytime on weekdays
- Advance notice of any noisy construction outside of approved hours
- Protection of the stream that flows south and east of the pump station

We expect construction at the North Mercer Pump Station to begin in 2022 and last until early 2025. We will provide neighbors and those affected by construction with a more detailed schedule once a contractor has been selected in 2021.

## Sequence of Construction

The work will generally follow this order:

- Install **temporary retaining wall** along western portion of site so that area can be graded.
- Build a **temporary pump station** structure at the northwest corner of the site.
- Construct **new generator building** just west of the existing pump station building.
- Operate the temporary pump station while upgrading the existing facility.
- Install new electrical equipment in the generator building.
- Install **new odor control facilities, transformer, and a fuel tank** for the generator in the courtyard.
- Install **new force mains** from the pump station to carry pumped sewage to the new North Mercer/Enatai Interceptor system. The force mains will cross the stream on the site; the stream will be piped during construction of the force main crossing.

# What You'll See When the Work is Done

The North Mercer Pump Station is not open to the public. The project team has designed the improvements with neighbors in mind – and a goal to minimize visual and sound impacts on surrounding homes.

## New Generator Building

The pump station will have its own supply of electricity directly from Puget Sound Energy. A generator will ensure the pump station stays operational even during a power outage. The generator will have a silencer to minimize noise and will be checked regularly by King County maintenance crews.

## Odor Control System

The contractor will install a new odor control unit in the courtyard. This unit will replace older technology, providing greater efficiency and reliability than the existing system. There may occasionally still be odors associated with the facility, but they will be very infrequent.



King County has a 24-hour odor complaint line that neighbors can call if they smell anything: 206-263-1760.

## Retaining Wall

the west side of the site. But the west side is hilly, so a retaining wall will be constructed southwest of the pump station building to stabilize the site and allow a landscaped buffer to be planted.

## Landscaping

After construction is complete, King County will plant new trees and landscaping around the site.

- **Begin operation** of the upgraded pump station and remove the temporary pump station. The temporary station will be in service for about a year.
- **Restore the site** and provide screening and landscaping.
- Build the new **permanent retaining wall** in stages as needed throughout the construction. Its final section will cross the northwest corner of the site after the temporary pump station is removed. Once construction of the permanent wall has been completed, the temporary wall will be removed and the area will be graded and planted.

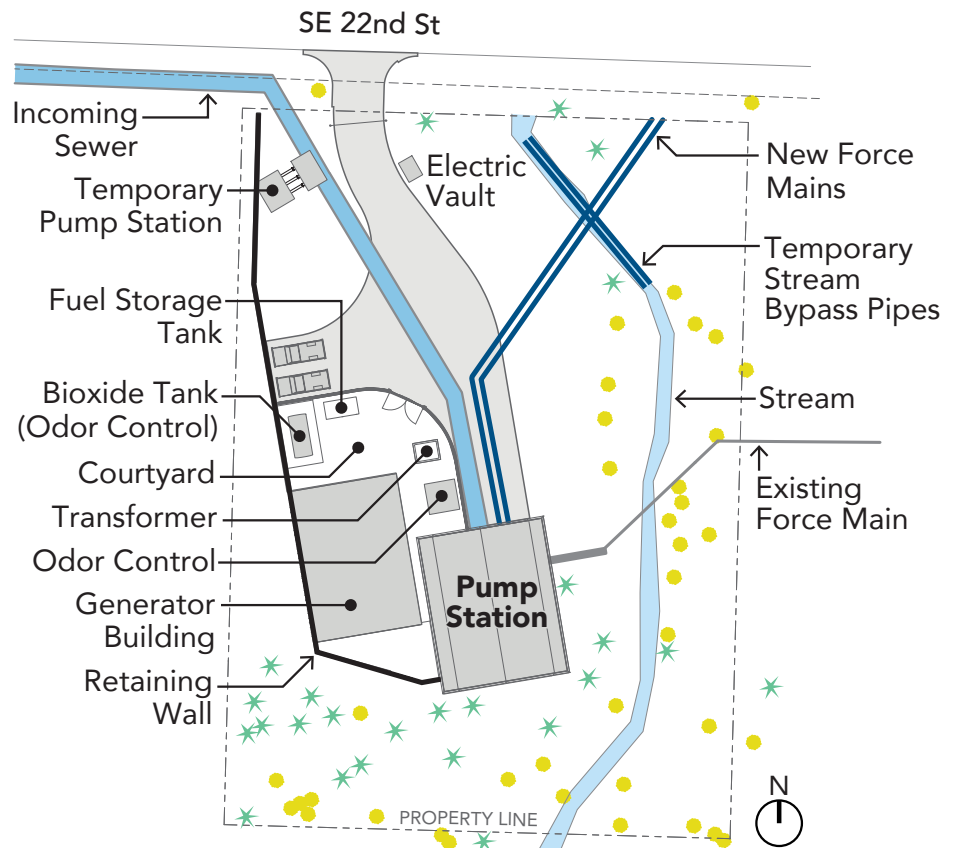

North Mercer Island Pump Station

## Screening the Site

For a facility like the North Mercer Pump Station that's surrounded by private homes, screening is an essential requirement. This includes both visual screening of mechanical equipment and sound screening to minimize noise reaching neighboring properties.



## What's Next

King County is currently bringing contractors onboard. Once all documents and paperwork are finalized, construction is expected to begin early 2022. Overall, construction will take four years, though most work locations will see shorter durations.

Our team will share information so neighbors know what to expect during construction and beyond. Here is what you can expect from us going forward:

- Attendance at community events\*
- Project newsletters, fact sheets, and field work notifications

- Monthly project web updates
- Online/in-person open house\*
- Briefings online/in-person for interested community groups\*

We are committed to continuing to be a good neighbor during construction. We will share information about construction and impacts on our website, in project emails, and through posted information at the park.

*\*In accordance with Seattle/King County Public Health guidelines.*

## NORTH MERCER ISLAND/ENATAI Sewer Upgrade Project

Este boletín informativo brinda información acerca del proyecto de actualización del alcantarillado en el norte de Mercer/Enatai. Para obtener más información, llame al 425-305-3578, deje un mensaje con su número de teléfono e indique su idioma. Se proporcionará un intérprete sin costo.

本时事通讯为您提供有关 North Mercer/Enatai 下水道升级项目的信息。请致电 425-305-3578, 留言和您的电话号码并选择您的语言。我们将免费提供口译服务。

本通訊為您提供有關北 Mercer/Enatai 下水道升級項目的資訊。如需更多資訊，請致電 425-305-3578, 使用您的電話號碼留言 並選定您所講的語言。我們將免費提供口譯員服務。

**Talk to us!** For more information, or to schedule a virtual meeting, please contact:

The community services team at **425-305-3578** or **NMEsewer@kingcounty.gov**  
Visit the project Web page at **www.kingcounty.gov/MercerEnataiSewer**  
Sign up for email and text alerts on the project Web page.



Alternative formats available  
206-477-5371 or TTY replay: 711

@KingCountyWTD

