



King County

Department of Natural Resources and Parks
Wastewater Treatment Division

Sunset and Heathfield Pump Stations and Force Main Upgrade

Project update | June 2015

Protecting Lake Sammamish and the environment

The Sunset and Heathfield pump stations and sewer pipes send sewage from Sammamish, Issaquah, and Bellevue to be cleaned at King County's treatment plant in Renton. This sewer system has provided reliable service for 50 years, but is nearing capacity and reaching its limit. Both pump stations and the connected force main pipe will be upgraded to increase reliable wastewater services. The project will also upgrade the underground connection structure to the larger Eastgate Trunk pipe near I-90. The improved system will help serve the growing population for years to come.

Working with the community

The County has committed to work with the community, answer questions, and address concerns as the design process continues. We started over a year ago by asking more than 250 neighbors and community members about our work in the area. Here's what we heard from the community:

- The improved pump stations and new force main pipe should provide reliable service
- Ensure the facility fits into the existing community
- Minimize traffic impacts during construction
- Keep views of Lake Sammamish
- Currently, noise and vibration at both pump stations is an issue
- Use newsletters and email updates to share information



Talking about the project with the community

Fencing and lighting survey results

In March 2015, the County invited members of the public to share their preferences on fencing and lighting at the Sunset Pump Station. Lighting will be removed and replaced with lower impact lighting and the fencing along West Lake Sammamish will be replaced. Community members had the opportunity to share their input and pick their design preference at the in-person open house and online through the project's online open house. Responses were anonymous and kept confidential and have been shared with the project team to help the design process continue.

Based on the input and preferences gathered from the community, a metal straight-top fence with stone columns and straight bollard safety lighting will be installed along West Lake Sammamish Parkway near the end of construction (see schedule inside).

Thank you for sharing your preference and input!



Community's preferred fencing and lighting design near the Sunset Pump Station

Look inside to learn more about design

Design continues on the Sunset and Heathfield Pump Stations and Force Main Upgrade project

The sewer system is being upgraded with additional capacity to serve the area's growing population. At this point in the project, the team knows the basic route and construction methods of the new force main pipe. The general layout of the pump station equipment has also been decided.



What you'll see in 2015

- Field investigations in your neighborhood in late May or early June
- King County staff at community events
- Detailed landscape designs later this summer

We are committed to keeping the community informed in advance of major project milestones, community meetings and construction work (not expected to begin until 2017).

Project timeline



Force Main pipe upgrades

The current 12 inch sewer force main pipe will be replaced with a 24 inch pipe to increase capacity. Two main construction methods will be used to install the new force main pipe. Low-impact construction methods will be used where the new force main pipe crosses Vasa Creek.

Construction methods

Method 1: Open cut construction

Open cut will be used from 166th Avenue S.E. to S.E. Eastgate Way.

- Requires digging trenches using backhoes and dump trucks
- Impacts roadways; traffic detours will likely be necessary
- Access to driveways will always be maintained
- Paving is restored to original condition
- Most common method for installing pipes
- Provides flexibility during construction to work around existing utilities

Method 2: Horizontal directional drilling (HDD)

HDD will be used from Sunset Pump Station near Vasa Park to 166th Avenue S.E.

- Does not require digging trenches along roadways
- Uses drilling rig equipment
- Reduces traffic impacts to West Lake Sammamish Parkway S.E.
- Reduces impacts to trees and wetlands along S.E. 38th Street
- Requires a large staging area on both ends of the pipe



Open cut example



HDD example

Pump station upgrades

The Sunset and Heathfield pump stations will be upgraded so that the County can continue to provide reliable sewer service to the growing area.

Sunset Pump Station upgrades



- 4 new pumps to increase capacity
- New electrical and controls systems
- New standby generator
- New heating and air conditioning systems (HVAC)
- Landscaping
- Roof replacement
- New lighting and fencing
- Green roof

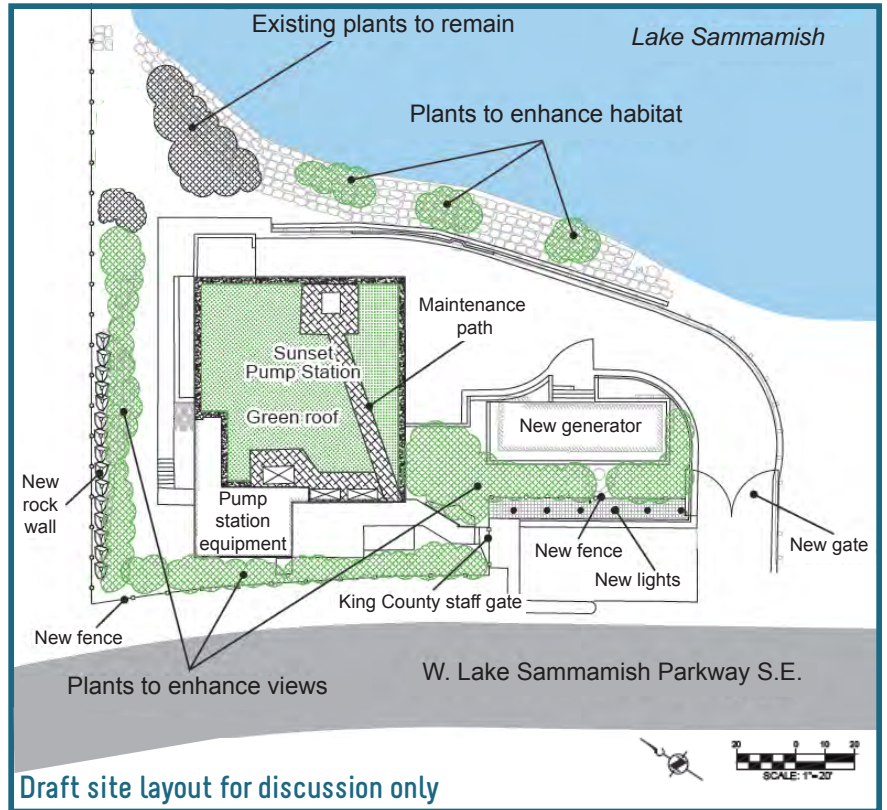

Heathfield Pump Station upgrades



- New lighting and fencing
- 4 new pumps to increase capacity
- New electrical and controls systems
- New standby generator
- New heating and air conditioning systems (HVAC)
- Rain garden
- Landscaping
- Roof replacement

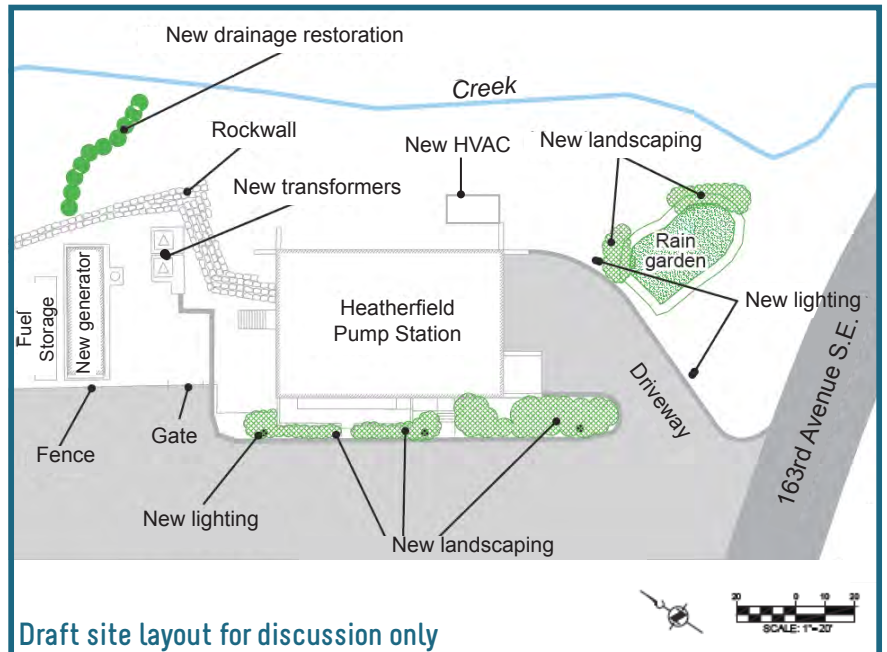

Questions about the project?

Contact De'Sean Quinn

Call: 206-477-5417

Email: desean.quinn@kingcounty.gov

Website: www.kingcounty.gov/sunsetheathfield



King County

King County - Department of Natural Resources and Parks
Wastewater Treatment Division
King Street Center
KSC-NR-0505, 201 S. Jackson Street
Seattle, WA 98104-3855

PRESORTED
MAIL
US POSTAGE
PAID
SEATTLE, WA
PERMIT NO. 836



King County

Department of Natural Resources and Parks
Wastewater Treatment Division

Sunset and Heathfield Pump Stations and Force Main Upgrade

Project update | June 2015

Stay informed and keep in touch!

- Keep an eye out for us at community events this summer and come say hi!
- Ask us to come to your community group meetings
- Join our mailing list to receive project newsletters and meeting announcements

Contact De'Sean Quinn:

- Call: 206-477-5417
- Email: desean.quinn@kingcounty.gov
- Submit comments online at the project website
www.kingcounty.gov/sunsetheathfield



Community open house