

East Side Interceptor Lining Project

Conveyance System Improvements in Renton

Eastside Interceptor Lining Project - update for May 31-June 5

The [Eastside Interceptor \(ESI\)](#) is one of the main sewer lines that brings wastewater from eastside homes and business to the South Treatment Plant in Renton. This project will repair about 3,700 feet of the line, which is corroded and nearing the end of its service life (see [map](#) below).

For May 30-June 5, the contractor is finalizing preparations for lining work slated to start in early June:

- **Project staging area:** The contractor is finalizing mobilization for the project at their Boeing work site, including finishing trailer set-up, preparing the bypass intake pit and pump staging.
- **Pipe fusing and installation:** Sections of the bypass pipe need to be connected or fused together and then brought to where the pipe will be installed along Logan Avenue. Pipe fusing will take place at the work site, both days and nights.
- **Night work on Logan Avenue North:** As the final sections of the bypass pipe are installed, multi-lane nighttime closures are expected, and traffic may be reduced to one lane at times. Locations where you may see lane closures include the intersections of N 8th and N 10th streets and Logan Avenue N. This work is expected to wrap up next week.
- **Possible temporary nighttime bus stop closure:** Tonight (Friday), and Saturday and Sunday nights pass pipe installation may temporarily close the Rapid Ride F bus stops at N 10th St. and Logan Ave. N. The stop maybe be closed or temporarily moved, as determined by King Co. Metro.
- **Barriers on Logan Avenue North:** Barriers have been set up around the bypass pipes to protect them from being damaged and to keep the public safe. This is an active construction area and should not be used by pedestrians – please do not touch or cross the barriers or walk alongside them. Please cross the street to find safe areas to walk.

Bypass pipe installation is expected to be completed by June 5. Once complete, the contractor will test the bypass pipe to ensure it is working correctly.

- Following successful testing of the bypass pipe, flows will be diverted from the ESI into the bypass pipe, and **work inside the ESI pipe** will begin. This could start as early as June 6.
- **Pumps in the staging area will begin operating around the clock** once flows are diverted into the bypass pipe. The pumps move the flows through the bypass pipe. Noise monitoring and control measures are in place.
- Once in-pipe work begins, there will be **temporary daytime lane closures on Logan Avenue N** around maintenance hole access areas. Traffic control will follow the work.

Burnett Avenue N will remain closed at N 6th Street for several months. The bypass pipe will meet up with the main sewer line in this area and the site will be used as construction staging throughout the project.

- **Pipe testing** will occur in the Burnett Avenue N staging area. A downspout will also be installed in this area in the coming week.

The bike lane along Logan between Park Avenue N and N 6th Street is closed due to construction. Please cross over to the east side of Logan Avenue N or take an alternate route.

Thank you for your patience during our project. Visit www.kingcounty.gov/ESI-02 for project information, and to sign up for updates. For questions or concerns, contact David Freed at 206-263-9453 or david.freed@kingcounty.gov.

Alternative Formats Available
206-477-5371 - TTY Relay: 711

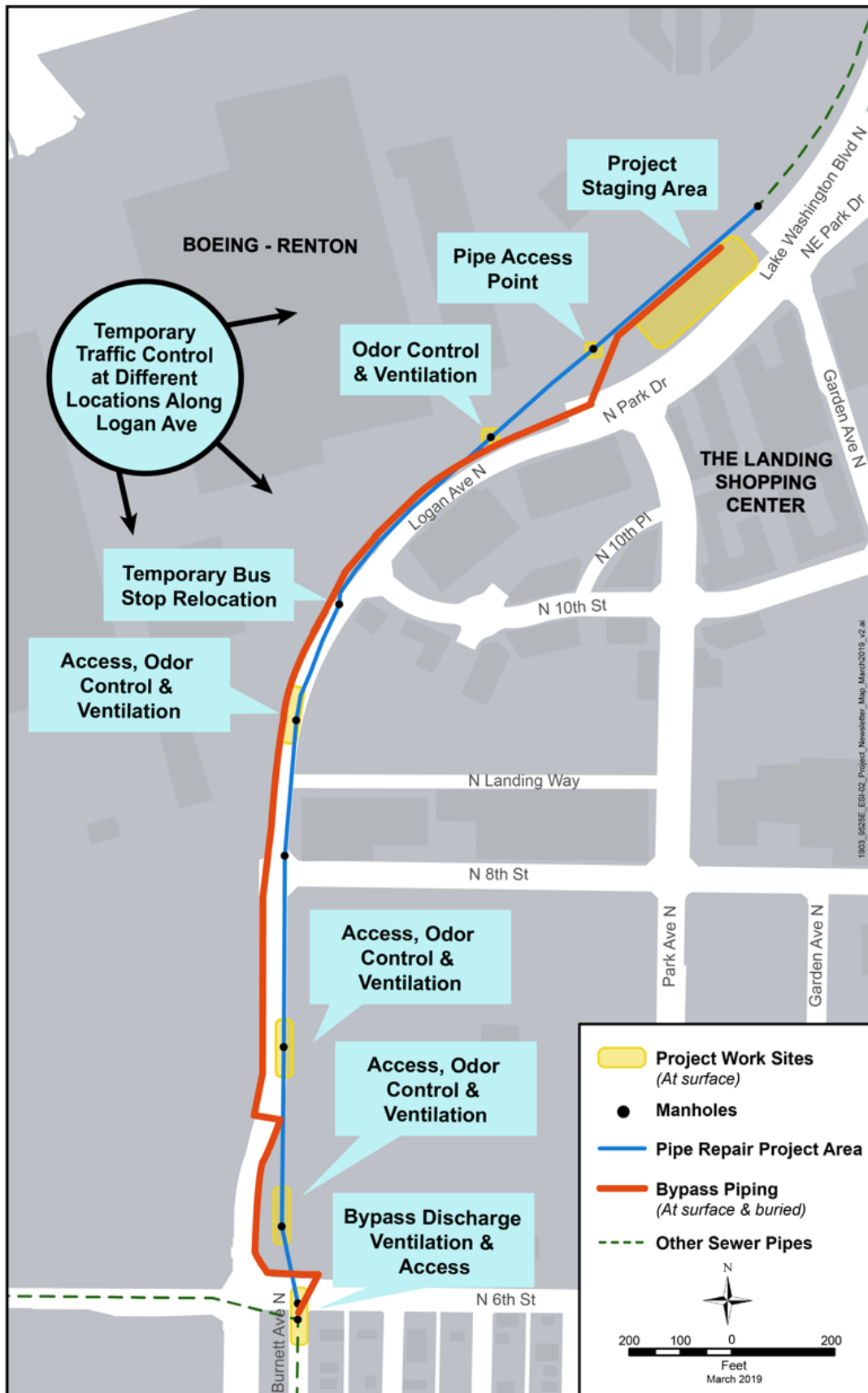

Map of the East Side Interceptor project area