



# South Correctional Entity “SCORE” Reentry and Jail Updates

David Cline, Tukwila City Administrator

Devon Schrum, SCORE Executive Director

Jeffrey Gepner, SCORE Programs Lieutenant

Prepared for the Regional Law Safety & Justice Committee  
February 28, 2019

# Our Presentation

- Introductions
- Some History
- DOC Rate Discussions
- Operational Climate
- Reentry at SCORE



# Some History...

King and Yakima Counties put area cities on notice they will not continue to contract with local cities for misdemeanants beyond 2012 and 2010 respectively.

2005 – The Jail Administrative Group (JAG) was formed in response and long range jail planning was initiated.

JAG Hired Ricci-Greene to analyze local jail population needs and capacity options over the next twenty years. They analyzed north and south regional needs.

Note: Although costs and jail options were studied; projected staffing and operational costs for medical/mental health populations were not analyzed.

## Decision Flow Diagrams

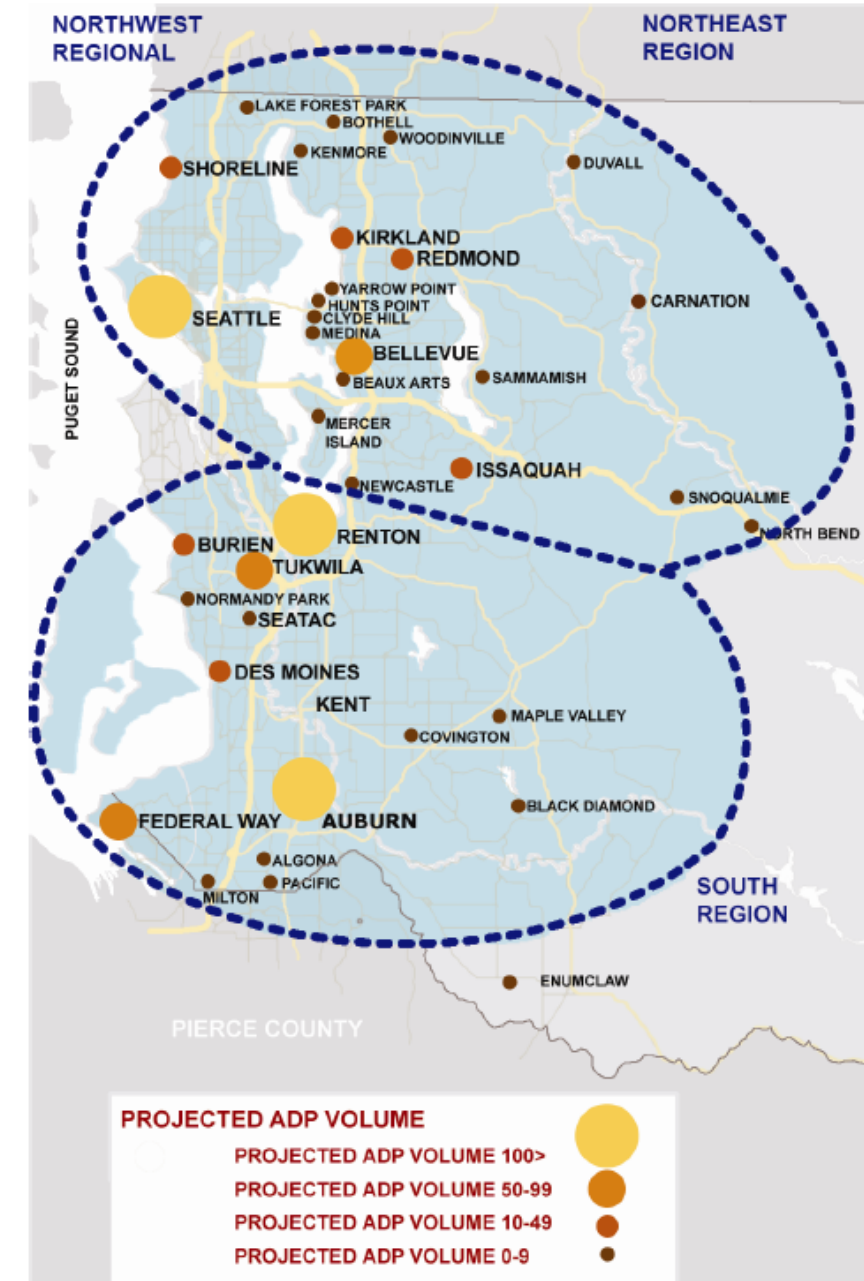

# Some History Continued...

## 2006 - Cities complete the Ricci-Greene Study

- Ricci-Greene report indicates that 39 cities in King County will need 1,440 beds by 2026.
- Of those beds, 700+ will be needed in South King County region.

## 2007 - Cities joined together for the SCORE Feasibility Study

## 2008 - Cities agree to form SCORE - Design and Finance work begins

## 2009 - Cities locate site, obtain building permit, complete design, issue bonds, and start construction.





# Some History Continued...

2010 - Construction continues and operations planning begins

2011 - SCORE Opens



*“This is a great partnership that brings our cities together to build a regional jail facility to meet our future needs,”*

*- Renton Mayor Denis Law*

# SCORE Governance

## Administrative Board

- 7 City Leaders

## Operations Board

- 7 Police Chiefs

## Finance Advisory Committee

- 7 Finance Directors





# DOC Rate Discussions

- Notice to DOC regarding high costs of service
  - Premium Medical Rates
  - Housing Contract Rate Increase
- Legislative Document
  - Housing Rate Increase
  - Last Day Billing
- Legislative Request
  - Direct available funds first to those jails serving the high risk/high need populations.

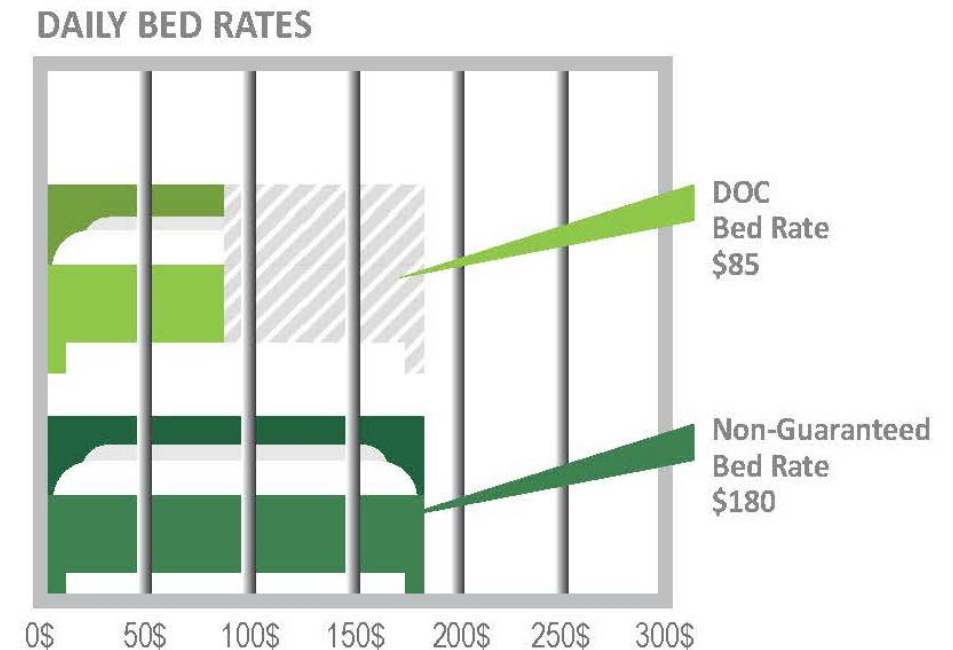

# Lots of Changes in 2018

- New Leadership
- Federal Way's Notice to Leave
- Staffing Challenges
- Financial Modeling
  - Value of Services
  - Contracting Differently





# SCORE REENTRY

- Multiple Provider Partnerships

- Education
- Mental Health
- Community Services
- Treatment and Recovery

- Health Services Provided

- Acute Care / Conic Care / Continuation of Care
- MAT – Vivitrol / Bup Cont. / Methadone Continuation and Induction



# Challenges

## Capacity

- Need for a Jail Liaison (putting all the pieces together)

## Length of Stay

- Average length of stay is 8 days

## Inmate Engagement

- Motivation during a short stay
- Worried about DOC reporting



# SCORE Partnerships

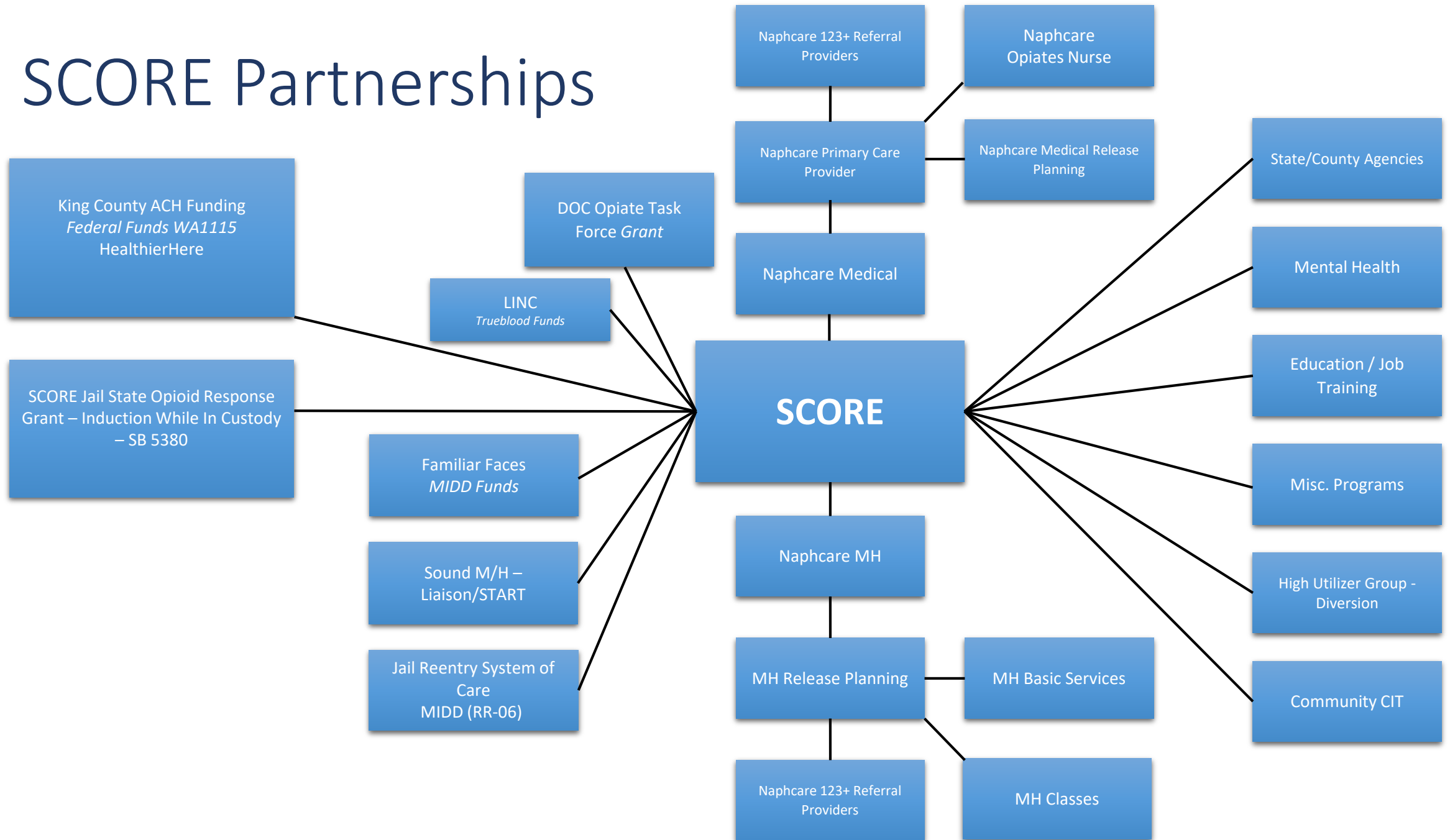



# Client Centered

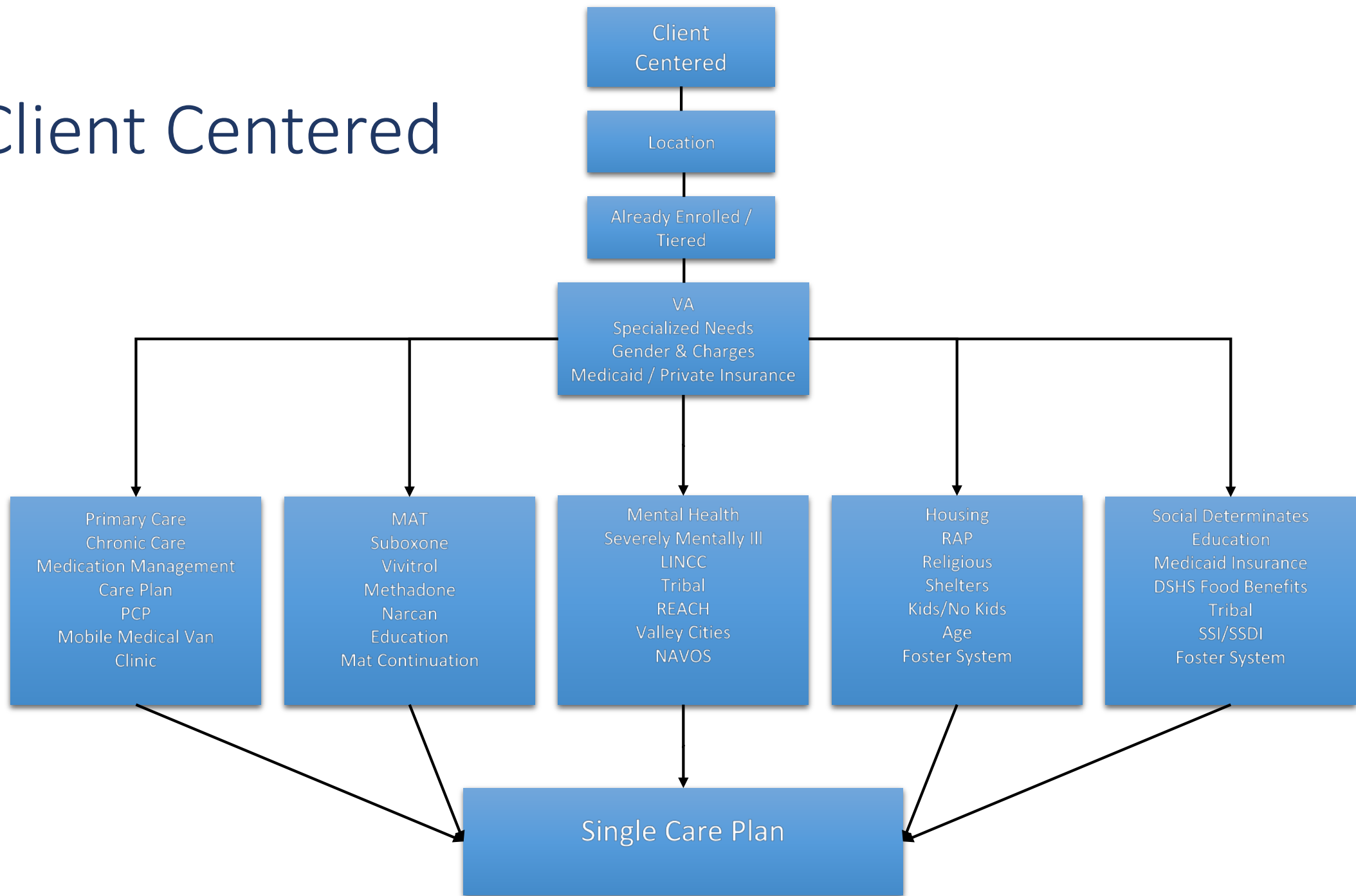

# Provider Partners

- Washington State DSHS
- Western State Hospital
- Children's Administration CPS
- Department of Veterans Affairs State / Federal
- Department of Corrections
- Probation (Various)
- King County Mental Health BHO
- King County Accountability Community Healthcare
- Providence Community Corrections
- King County Reentry
- King County Regional Mental Health Court
- King County Veterans Court
- Department of Licensing
- King County Community and Human Services
- King County Crisis and Commitment Services
- King County RAP Housing Navigator
- DSHS Work First
- Sound Health
- Valley Cities Counseling
- Greater Lakes Mental Healthcare
- Northwest Psychiatry
- Asian Counseling and Referral Service
- Seattle Indian Health Board
- Cowlitz Indian Tribe Mental Health
- Puget Sound Mental Health
- Muckleshoot Child & Family Services
- Muckleshoot Behavioral Health Program
- NAVOS
- Renton Technical College
- Highline Community College
- Green River Community College
- South Seattle Community College
- New Connections
- Pierce County Alliance
- Rebuilding Hope Sexual Assault Center
- Youth & Family Counseling
- MultiCare Health System
- Transitional Resources
- Doorway to Recovery
- Compass Health
- Lakeside Milam
- Lifelong
- RISE
- REACH Program
- START
- Vital Team
- Familiar Faces
- Evergreen Recovery
- FISH Program
- Criminal Justice Initiative
- REST
- Consejo Counseling
- Evergreen Treatment MAT Program
- Integra Health
- United Health Care
- Coordinated Care
- Swedish Ballard Treatment Center
- DESC
- YWCA
- Health Care Authority of WA
- **AND THIS LIST IS STILL GROWING!**

# What works

- SCORE has eliminated barriers access
- Bringing the services to the client where they are and when they need them (In-Reach)
- Whole Person Care
- Relationships with Partner Providers
- Change and adapt to what is needed
- Leverage our resources

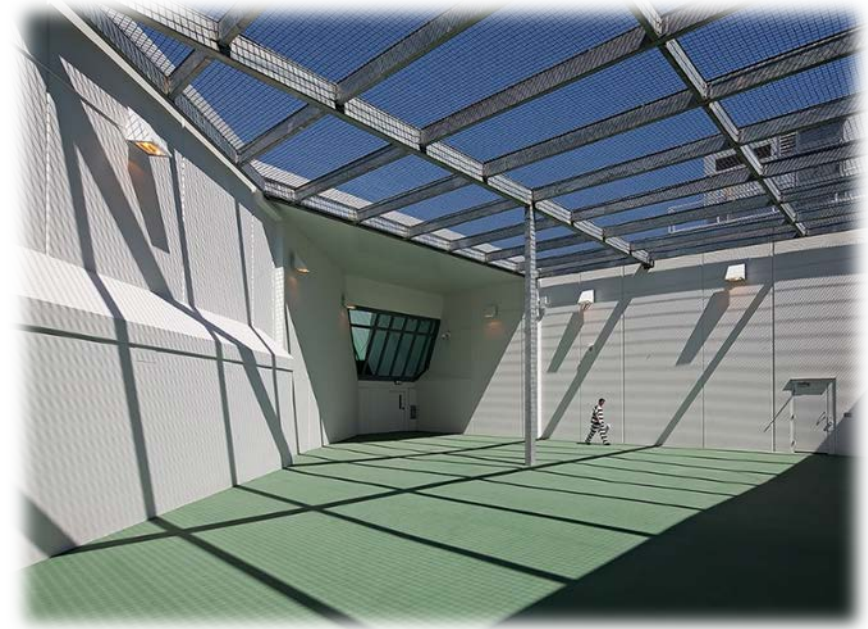



# Investing in Reentry



- Emergency Utilization
  - Average 2.7 Visits per year (26,000 Bookings per year)
  - Most for 1 Person is 199 in 12 Months
- Identified through EDIE(Emergency Department Information Exchange).
- Severe substance use and mental health disorders.
- Consistently refused to engage
- Treatment Team! (Medical, Mental Health, SCORE and Sound Health, Medical Assisted Treatment and Housing Support).
- No New Bookings in over a year.

# In 2018...

- Substance Use
  - 79% are detoxing
  - 60 % are detoxing from opiates
  - Average 35 – 60 detoxing per day
- Mental Health
  - 60% have a mental health disorder



# WA State Opioid Response (SOR) Project



## Washington State allocation

- \$21.6 million per year for Prevention, Treatment, and Recovery Support Services
- \$7.6 million per year is allocated for Opioid Treatment Networks
- Year 1 funding awarded (1/2019 to 9/29/2019)
- Year 2 funding pending (9/30/2019 to 9/29/2020)
- SCORE Funding per year \$363,000

## State Opioid Plan and SOR

- Address Goal 2 of the State Opioid Plan (Identify and treat opioid use disorder)
- Strategy 2.2 –Establish access in every region of the state to the full continuum of care for persons with opioid use disorder.
- Enhance MAT access to specialized and underserved communities
- Engage current and potential MAT prescribers
- Eliminate standard “treatment gap” by facilitating direct referrals and care coordination for ongoing MAT with Local MAT Treatment Sites.

State Opioid Plan progress report: <https://www.doh.wa.gov/YouandYourFamily/PoisoningandDrugOverdose/OpioidMisuseandOverdosePrevention>

17

## Opioid Treatment Network Background

- Hub & Spoke (H&S)
- OTNs are 2nd Generation H&S—more flexible
- Use of Care Navigators to connect people to treatment
- Reach people at high risk for overdose
- Meet people “where they are...”



# Opioid Treatment Network (OTN) Map

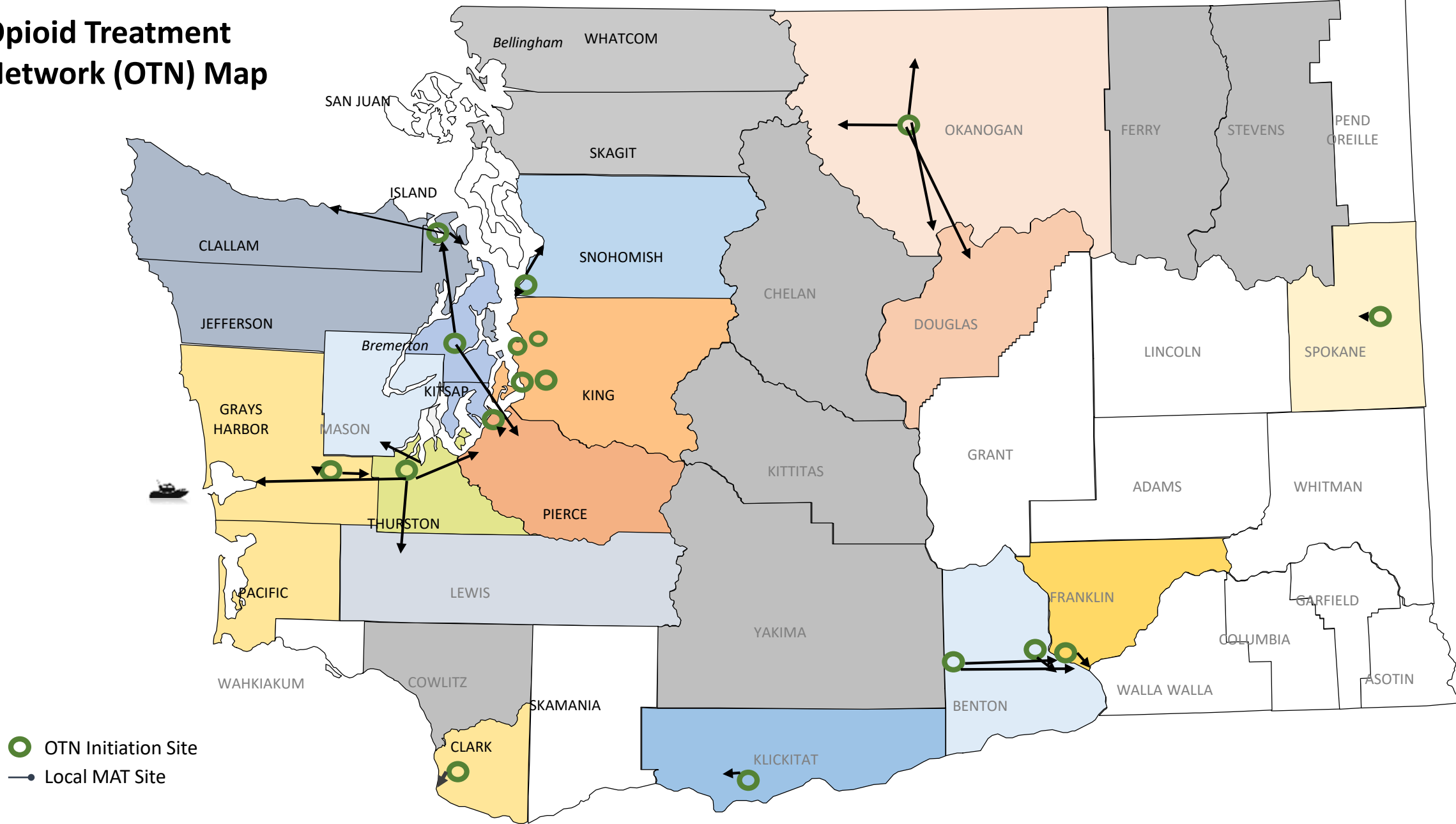

DATA SOURCE: Division of Behavioral Health and Recovery.  
NOTES: OTN MAT site locations may represent more than one clinic or agency providing MAT services or referrals