





16th Avenue SW Pedestrian Safety Improvements and Traffic Calming Project

PROJECT MAP

-  Project area
-  Future H-line & bus stop (2022)
-  Building
-  Commercial Area
-  Park
-  School

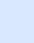

0 200 400 Feet

September 2021

KCIT DCE File: LDS/Roads/
2109_11417L_16thSWRoadsProj_map.ai

Data sources: Commercial area and buildings include King County Zoning categories CB, CB-SO, O and I-SO.

Note: The use of the information in this map is subject to the terms and conditions found at: www.kingcounty.gov/services/gis/Maps/terms-of-use.aspx. Your access and use is conditioned on your acceptance of these terms and conditions.

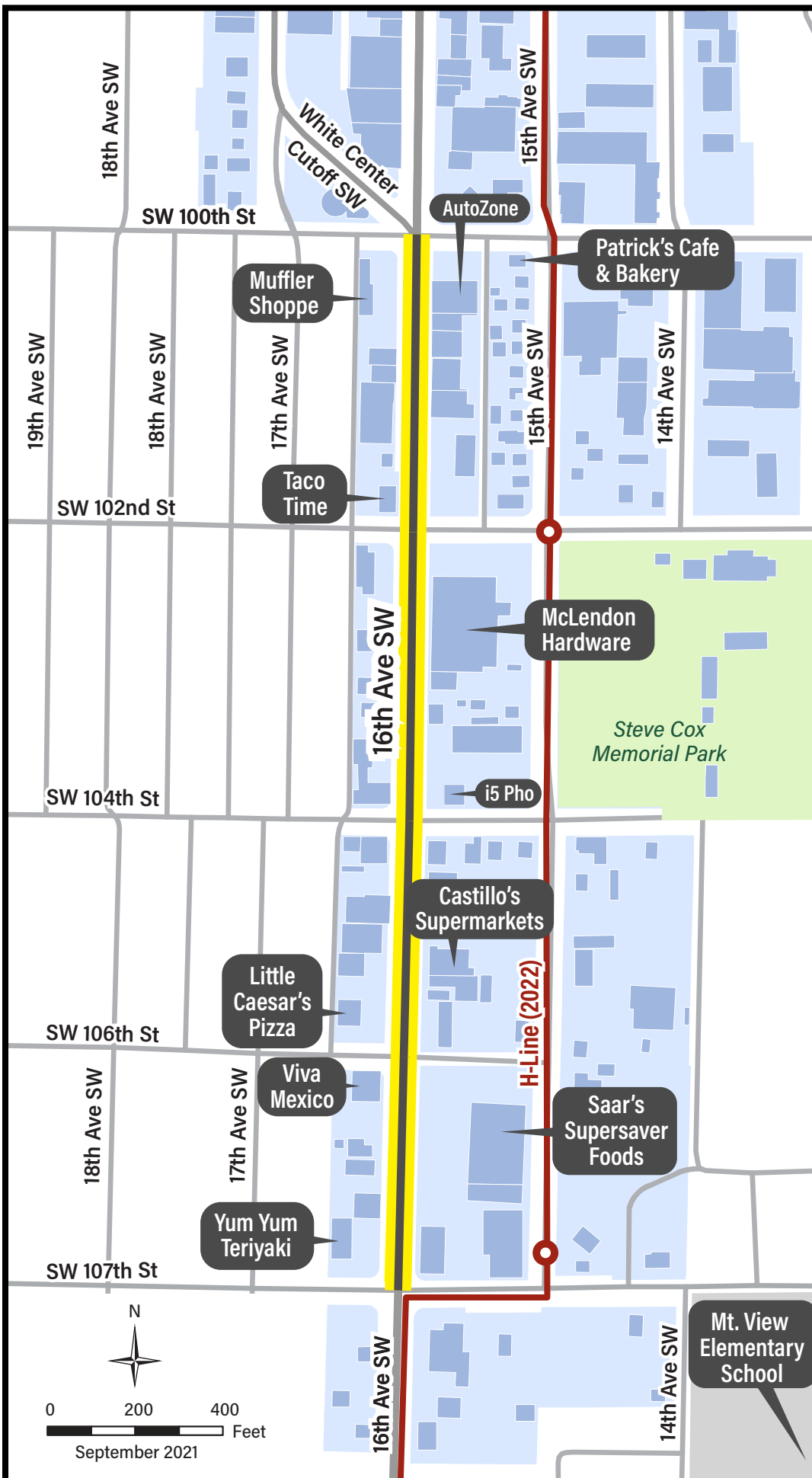

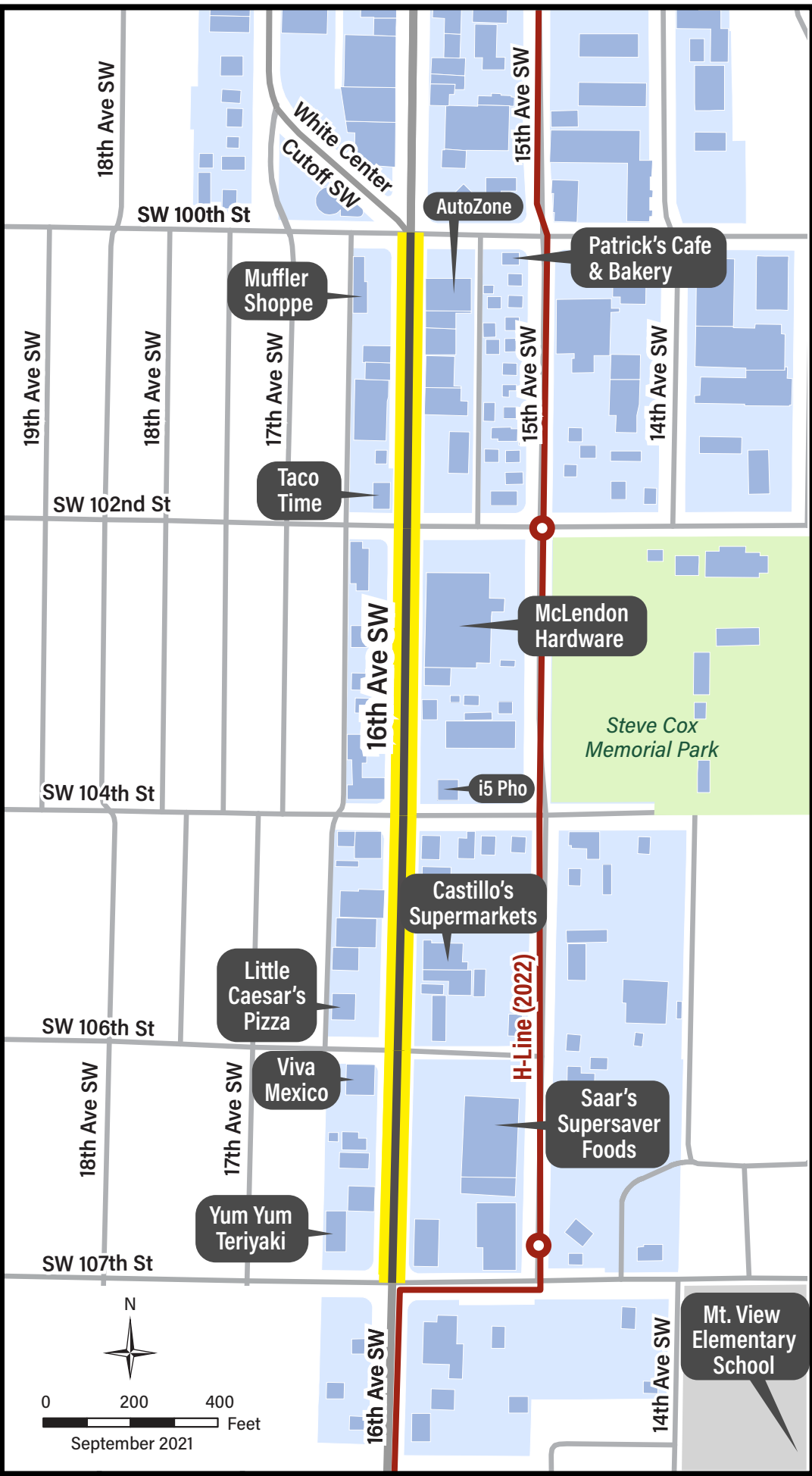

Project area



Park



Future H-line and bus stop (2022)



School



Commercial building



Commercial area