

Route 192

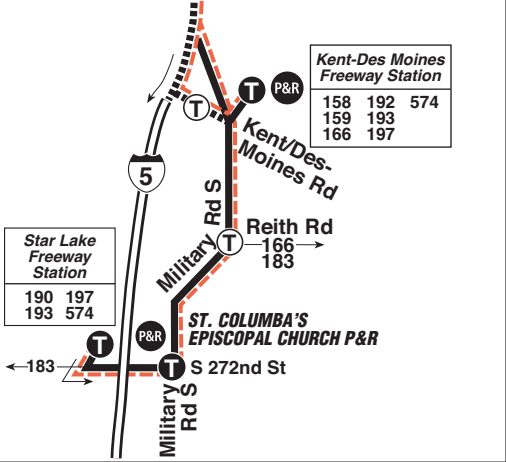
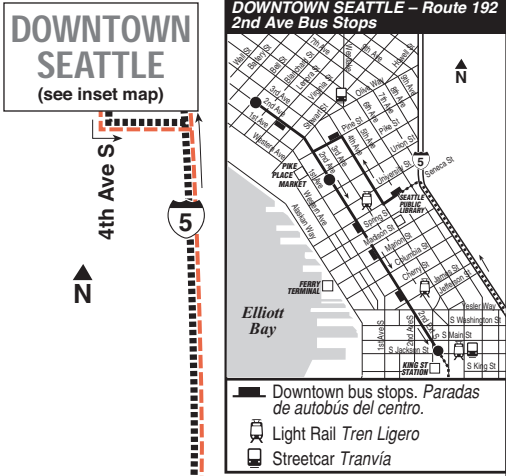

MAP LEGEND / LEYENDA DEL MAPA

- Makes all regular stops. *Hace todas las paradas regulares.*
- Limited or no stops. *Limitado o sin paradas.*
- Snow route. *Ruta de nieve.*
- TIME POINT / PUNTO DE TIEMPO:** Street intersection from which departure times are shown on the schedules. *Intersección de la calle desde donde se muestran los horarios de salida.*
- TRANSFER POINT / PUNTO DE TRANSFERENCIA:** Route intersection for transferring to indicated route(s). *Intersección de ruta para la transferencia para indicar la ruta o rutas.*
- TIME POINT & TRANSFER POINT / TIEMPO Y PUNTO DE TRANSFERENCIA**
- PARK & RIDE:** Free parking area. *Zona de estacionamiento gratis.*
- Landmark** El punto de referencia.

192 WEEKDAY/Entre semana

To DOWNTOWN SEATTLE →

Star Lake Freeway Station	Star Lake	Kent-Des Moines Park & Ride	Downtown Seattle	
I-5 & S 272nd St Southbound Off-Ramp	Military Rd S & S 272nd St	Military Rd S & Kent Des Moines Rd	2nd Ave & Pike St	2nd Ave Ext S & S Jackson St
Stop #47970	Stop #53050	Stop #21945	Stop #300	Stop #390
6:02	6:05	6:14	6:56‡	7:03‡
6:19	6:22	6:31	7:13‡	7:20‡
6:46	6:49	6:58	7:40‡	7:47‡
7:26	7:29	7:38	8:22‡	8:28‡

To STAR LAKE →

Downtown Seattle		Kent-Des Moines Park & Ride		Star Lake
2nd Ave & Bell St	2nd Ave & Pike St	2nd Ave Ext S & S Jackson St	Military Rd S & Kent Des Moines Rd	Military Rd S & S 272nd St
Stop #250	Stop #300	Stop #390	Stop #21945	Stop #53536
3:31	3:35	3:42‡	4:20‡	4:35‡
4:00	4:04	4:11‡	4:49‡	5:04‡
4:32	4:37	4:45‡	5:22‡	5:36‡
5:08	5:13	5:21‡	5:56‡	6:10‡

AM – Lighter Type PM – Darker Type

Timetable Symbol/ Símbolo del programa
 ‡ - Estimated time. *Tiempo estimado.*

Holiday Information/ Información sobre feriados

There is no service on these routes on weekends or the following holidays. *No hay servicio en estas rutas los fines de semana ni el siguiente feriados:*

Memorial Day May 25
Día de los Caídos *el 25 de mayo*

Independence Day (observed) July 3
Día de la Independencia (observado) *3 de julio*

Labor Day September 7
Día del Trabajo *7 de septiembre*

ORCA Card

Metro Transit and eight other Puget Sound transportation agencies (Community Transit, Everett Transit, Kitsap Transit, Pierce Transit, Sound Transit, Seattle Streetcar, King County Water Taxi, the Seattle Center Monorail and Washington State Ferries) use a common fare-payment system called ORCA (One Regional Card for All). The ORCA card works as cash or a pass, and it automatically tracks the value of your fares and transfers, letting you move easily between the participating transportation systems.

Get your ORCA card online at www.orcocard.com, by phone at 1-888-988-6722 (ORCA) or WA Relay: 711 (1-888-889-6368), at ticket vending machines in Sounder and Link rail stations, or at one of the transit agency customer service offices. The ORCA website also provides information on how to use the card, as well as locations at which they can be reloaded with a new pass or additional cash.

Night Rider Tip

You can help drivers spot you when it is dark or during times of reduced visibility by wearing light-colored clothing and by standing in the most visible area of the bus stop. We don't want to miss you!

How to Read a Schedule

1. Locate the WEEKDAY, SATURDAY, or SUNDAY schedule block for the day of travel.
2. Timepoints are select bus stops along the route that correspond to times listed under each location and to timepoint dots on the map. Timepoints are listed from the beginning of the route (on the left) to the end (on the right). If you are boarding at a stop between two timepoints, use the earlier time as a guide.
3. Bus stop number.
4. Read down the column to find the time your bus leaves the timepoint.
5. Read across the row to find the time your bus arrives at the next timepoint.
6. If there is a symbol (letter or character) after a time, look for the explanation under the heading Timetable Symbols.
7. A dash in the column means the bus does not serve that timepoint.
8. Refer to the Special Service Information section for any changes in routing or other unique aspects of service on this route.

43 WEEKDAY/Entre semana

To CAPITOL HILL ← DOWNTOWN → To UNIVERSITY DISTRICT

University District	Montlake Station	Capitol Hill	Downtown Seattle	Downtown Seattle	University District
NE 45th St & Univ Way N	On Montlake Blvd at SR-520	Broadway E & E John St	Pine St & 4th Ave	Pike St & 4th Ave	E John St
Stop #10911	Stop #25243	Stop #29264	Stop #1110	Stop #1180	Stop #1180
5:25	5:33	5:45	5:52	—	5:—
5:43	5:51	6:03	6:10	—	5:—
6:09	6:16	6:29	6:38	—	5:—
6:41	6:50	7:03	7:11C	—	5:—
7:14	7:23	7:36	7:46C	—	6:—
7:44	7:54	8:07	8:16C	—	6:—
8:12	8:23	8:36	8:45C	—	6:—
8:36	8:46	9:00	9:08C	—	6:—
9:13	9:23	9:37	9:45C	—	7:—
9:40	9:52	10:06	10:15C	—	7:—

Metro buses have bike racks that hold three bikes and are easy to use. There is no extra charge for your bike. Follow the instructions posted near the rack. A bike loading video and other bike information is available on Metro's website.

Metro Customer Services

At Metro's Customer Services office you can buy ORCA cards, bus passes, senior permits and taxi scrip, get information about bus service, register for disability permits and retrieve items turned into Lost & Found.

King Street Center
 201 S Jackson St
 Monday–Friday
 8:30 a.m.–4:30 p.m.

Lost & Found
 Monday–Friday
 8:30 a.m.–1 p.m.
 2 p.m.–4:30 p.m.

Seattle metro calling area 206-553-3000
 Toll Free 1-800-542-7876
 Hearing impaired WA Relay: 711
 Carpool/Vanpool 206-625-4500
 Hearing Impaired WA Relay: 1-800-833-6388

Community Transit 1-800-562-1375
 Pierce Transit 1-800-562-8109

Accessible Formats
 People with disabilities who need this information in accessible formats may call 206-477-6066 (voice) or TTY Relay: 711.

RIDER ALERT This symbol indicates a change in service. Watch for it in buses, at bus stops, and at timetable displays.

- Metro Customer Service**
206-553-3000
- Metro Website/Trip Planner**
kingcounty.gov/metro
- TTY/Hearing Impaired**
WA Relay: 711

Interpreter
206-553-3000

Intérpretes የቃል አስተርጓሚ
 Переводчик ਇਟਰਪਰਟਰ
 Перекладач 翻譯員
 Turjubaan 통역사
 Thông Dịch Viên

190, 192

(Includes partial service on routes 177 and 178)

Redondo Heights, Star Lake, Kent-Des Moines P&R, Downtown Seattle

March 21 thru September 18, 2020
 Del 21 de marzo al 18 de septiembre de 2020

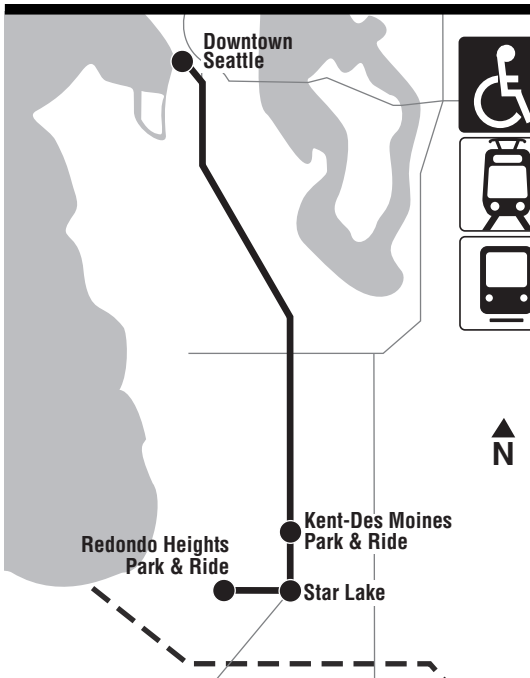

190 WEEKDAY/Entre semana

To DOWNTOWN SEATTLE →

To STAR LAKE, REDONDO HTS P&R →

Route	Redondo Heights P&R	Star Lake Fwy Station	Downtown Seattle	
	Pacific Hwy S & S 276th St Stop #60747	I-5 & S 272nd St Northbound On-Ramp Stop #47972	SODO Busway & S Spokane St Stop #99252	4th Ave & Pike St Stop #700
177	—	4:51‡	5:21‡	5:40‡
177	—	5:21‡	5:51‡	6:10‡
178	—	5:42‡	6:01‡	6:22‡
190	5:50	5:58	6:28‡	6:47‡
190	6:10	6:18	6:50‡	7:09‡
190	6:30	6:38	7:10‡	7:31‡
190	6:45	6:53	7:25‡	7:46‡
190	7:00	7:08	7:40‡	8:01‡
190	7:15	7:23	7:56‡	8:17‡
190	7:30	7:38	8:11‡	8:33‡
190	7:50	7:58	8:31‡	8:53‡

AM – Lighter Type
PM – Darker Type

Route	Downtown Seattle			Star Lake Fwy Station	Redondo Heights P&R
	2nd Ave & Bell St Stop #250	2nd Ave & Pike St Stop #300	SODO Busway & S Spokane St Stop #99253	I-5 & S 272nd St Southbound Off-Ramp Stop #47970	Pacific Hwy S & S 276th St Stop #60747
190	3:22	3:26	3:42‡	4:12‡	4:23‡
190	3:57	4:01	4:17‡	4:49‡	5:01‡
190	4:21	4:26	4:42‡	5:14‡	5:26‡
190	4:41	4:46	5:03‡	5:35‡	5:46‡
190	4:56	5:01	5:18‡	5:46‡	5:57‡
190	5:11	5:16	5:33‡	5:59‡	6:10‡
190	5:36	5:41	5:58‡	6:22‡	6:33‡
178	6:11	6:14	6:33‡	6:56‡	—
177	6:26	6:29	6:45‡	7:08‡	—
177	6:46	6:49	7:05‡	7:28‡	—

AM – Lighter Type
PM – Darker Type

S0190STR

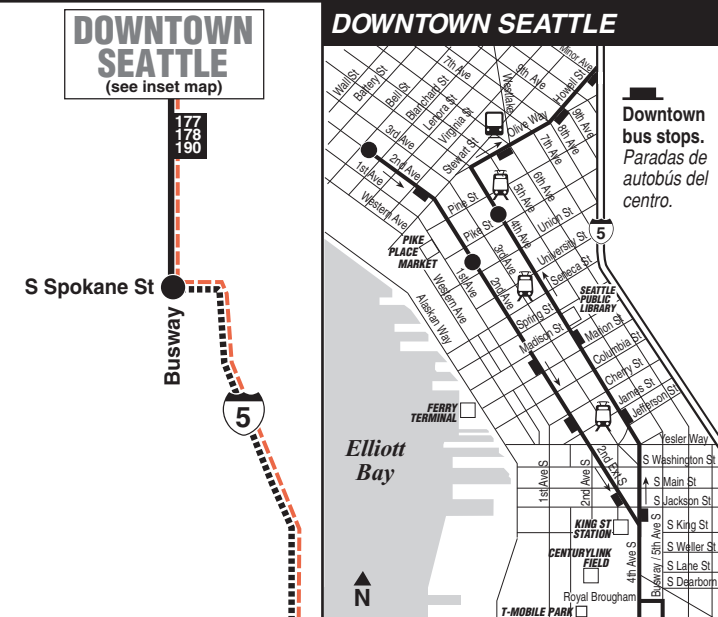

MAP LEGEND / LEYENDA DEL MAPA

- Makes all regular stops. *Hace todas las paradas regulares.*
- Limited or no stops. *Limitado o sin paradas.*
- Snow route. *Ruta de nieve.*
- TIME POINT / PUNTO DE TIEMPO: Street intersection from which departure times are shown on the schedules. *Intersección de la calle desde donde se muestran los horarios de salida.*
- TIME POINT & TRANSFER POINT / TIEMPO Y PUNTO DE TRANSFERENCIA
- PARK & RIDE: Free parking area. *Zona de estacionamiento gratis.*
- Streetcar *Tranvía*
- Light Rail *Tren Ligero*

Timetable Symbol/ Símbolo del programa

‡ - Estimated time. *Tiempo estimado.*

Priority Seating

All Metro buses are wheelchair accessible. Designated seats in the front of buses are reserved for seniors and people with disabilities. If you are occupying one of these seats when a person with greater need boards, please offer it to that person. For more information about accessible service and bus-acceptable wheelchair/scooter specifications, call 206-553-3000.

Holiday Information/ Información sobre feriados

There is no service on these routes on weekends or the following holidays. *No hay servicio en estas rutas los fines de semana ni el siguiente feriados:*

- Memorial Day May 25
Día de los Caídos el 25 de mayo
- Independence Day (observed) July 3
Día de la independencia (observado) 3 de julio
- Labor Day September 7
Día del Trabajo 7 de septiembre

Get real-time bus arrival information on your mobile device.
Text your bus stop number to 62550.

Snow/Emergency Service Servicio de emergencia/nieve

During most snow conditions, these routes will operate via the snow routing shown in this timetable. In the rare event that Metro declares an emergency, they will not operate. Visit kingcounty.gov/metro/snow and sign up for Transit Alerts to stay informed during adverse conditions.

Durante la mayoría de las condiciones de nieve, estas rutas operarán por las rutas para nevadas que se muestran en este programa. En el caso poco frecuente que Metro declare una emergencia, no operarán. Visite kingcounty.gov/metro/snow y regístrese para recibir Alertas de tránsito y manténgase informado durante las condiciones adversas.

Transit Alerts
 Metro offers an alert subscription service via email or text. You choose the route information you want and we will send it to you. Go to Metro's website to sign up.

Online Trip Planning

Use Metro's online Trip Planner to plan trips on scheduled service in King, Pierce and Snohomish counties. It provides details on transit stops, routes and schedules. Trip Planner itineraries do not include service disruptions and reroutes caused by weather, emergencies, traffic, events or construction.

Trip Planner includes Metro Transit, Pierce Transit, Community Transit, Everett Transit, ST Express buses, Link light rail, Sounder commuter rail, King County Water Taxi, Washington State Ferries, the Seattle Center Monorail, and Seattle Streetcar.

www.kingcounty.gov/tripplanner

Need more information or assistance?

- Visit Metro online at kingcounty.gov/metro
- Call Metro's Customer Information Office, 206-553-3000, Monday-Friday except for major/county holidays (May 25, July 3 (observed) and Sept. 7)
 - 6 a.m.–8 p.m. for trip planning assistance
 - 8 a.m.–5 p.m. for ORCA assistance and customer comments

VanShare

You know a good thing when you ride!

Let VanShare bridge the gap in your commute. Starting a vanshare is simple. You just need five people including a volunteer driver. Use it to make the connection to your final destination from any transportation terminal.

To start a VanShare, phone us at 206-625-4500 or e-mail us at VanShare@kingcounty.gov. Link to our web page through Metro at kingcounty.gov/metro

How to Pay

At all times, pay your fare **when you board** the bus. Pay with cash (exact fare; drivers do not carry change), ticket or with a convenient regional ORCA card. Show your activated Transit GO Ticket (mobile ticket) or valid transfer to the driver. Metro transfers are valid on Metro, only. See "How to pay" on Metro's website for more information.

Pague su pasaje al abordar el autobús. Pague en efectivo (cantidad exacta; los conductores no tienen cambio), con tarjeta regional ORCA o muestre su boleto. Muestre su Transit GO Ticket activado (boleto electrónico) o su boleto transferible al conductor. Las transferencias son válidas sólo en Metro. Para mayor información, vea "Cómo pagar" en la página web de Metro.

What To Pay Cuánto pagar

Adults (19 and older) <i>Adultos</i> (19 años y mayor)	\$2.75
Youth (6-18 yrs) <i>Jóvenes</i> (6-18 años)	\$1.50
ORCA LIFT Fare* <i>Tarifa ORCA LIFT*</i>	\$1.50
RRFP cardholders (registered seniors, Medicare, disabled) <i>Titulares de tarjetas RRFP</i> (personas mayores registradas, Medicare, discapacitados)	\$1.00
Children (thru age 5) Four may ride free with person paying adult fare <i>Niños</i> (hasta los 5 años) Pueden viajar hasta cuatro con una persona que pague la tarifa de adulto.	

*Income Qualified **Ingresos que reúnan los requisitos*