

RAVENSDALE RECLAMATION TRENCH FILLING AND RESTORATION PROJECT
 PORTIONS OF SECTION 1, TOWNSHIP 21 NORTH, RANGE 6 EAST,
 SECTION 36, TOWNSHIP 22 NORTH, RANGE 6 EAST, AND SECTION 31, TOWNSHIP 22 NORTH, RANGE 7 EAST, W.M.
 KING COUNTY, WASHINGTON
 TRENCH AND PARCEL LOCATIONS MAP

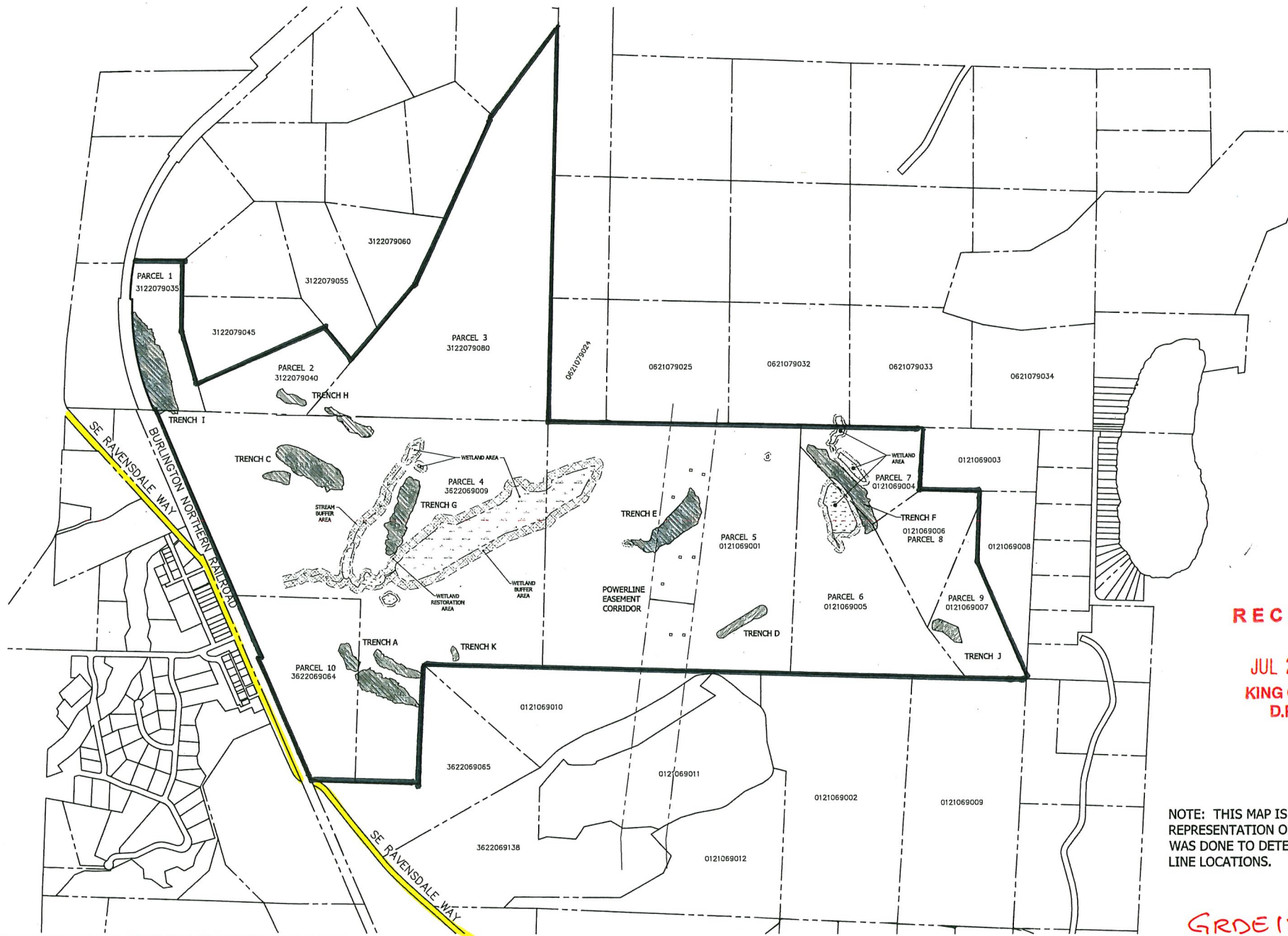

RECEIVED
 JUL 24 2018
 KING COUNTY
 D.P.E.R.

NOTE: THIS MAP IS A GRAPHICAL REPRESENTATION ONLY, NO SURVEYING WAS DONE TO DETERMINE PROPERTY LINE LOCATIONS.

GRDE 18-0114

REVISION	DESCRIPTION	DATE	BY

<p align="center">CONTOUR ENGINEERING • L.L.C. CIVIL ENGINEERS-SURVEYORS-LAND PLANNERS 3309 56th Street NW, Suite 106, Gig Harbor, WA 98335 Phone: 253-857-5454 ~ Fax: 253-509-0044 ~ info@contourpllc.com</p>	
	<p>SHEET TITLE: TRENCH AND PARCEL LOCATION MAP PROJECT: RAVENSDALE RECLAMATION TRENCH FILLING AND RESTORATION CLIENT: RAVENSDALE LLC 41306 90TH AVENUE E BENTONVILLE, WA 98228 CONTACT: KURT ERICSON PHONE: (253) 606-6060</p>
<p>DESIGNER: J. JACOBY ENGINEER: B. ALLEN DRAWN: J. JACOBY S 1 T 21 N R 6E WM DATE: 2018-05-08 REVISED:</p>	<p>PROJECT: 09-040 DWG NAME: 09-040 SEC</p>
<p>SHEET C2</p>	<p>REV. </p>
<p>2 OF 33</p>	<p>△</p>

L:\PROJECT FILES\18-0114\RAVENSDALE\18-0114-C2.DWG