

RECEIVED

APR 11 2017

KING COUNTY  
D.P.E.R.

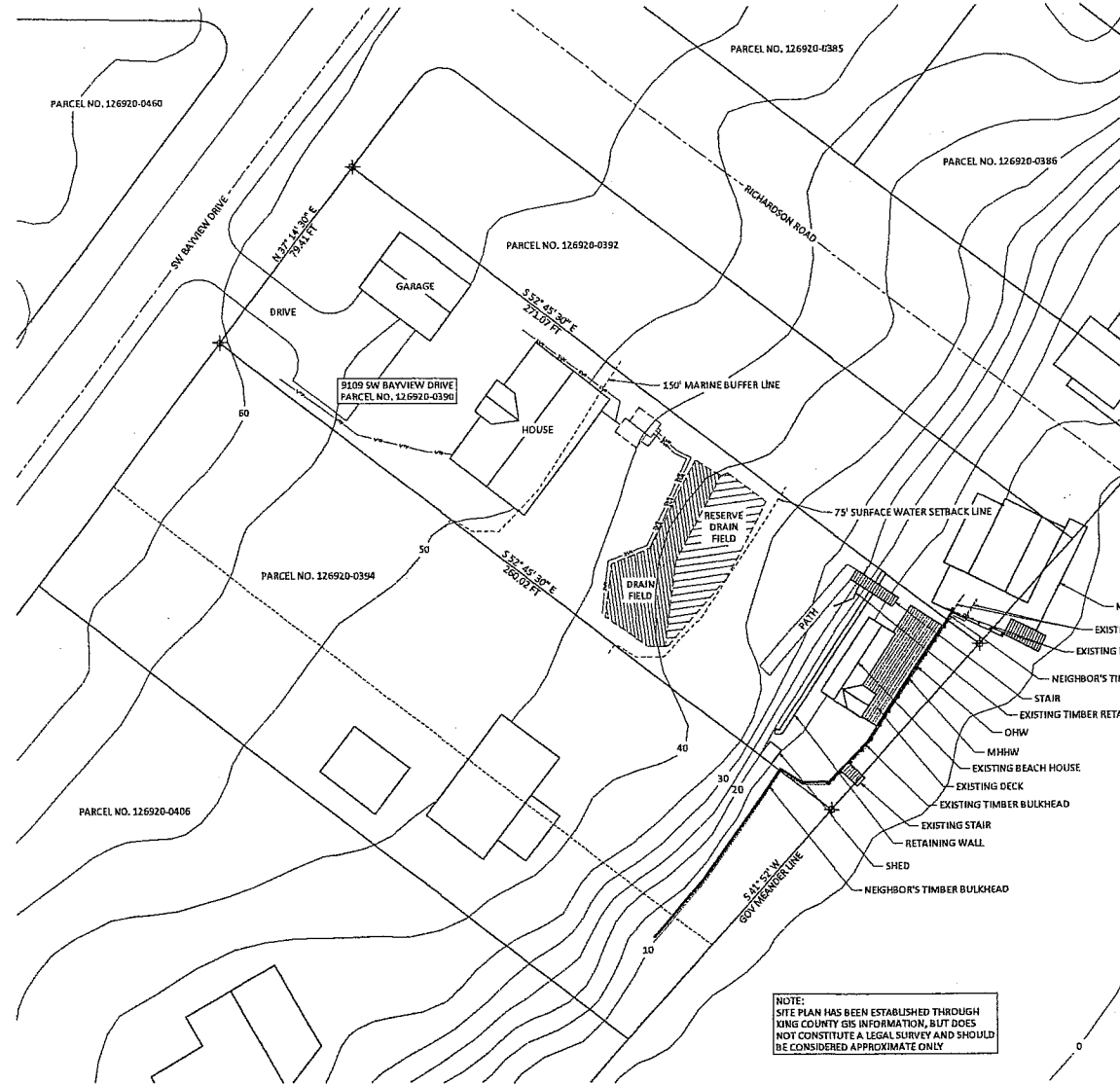

NOTE:  
SITE PLAN HAS BEEN ESTABLISHED THROUGH  
KING COUNTY GIS INFORMATION, BUT DOES  
NOT CONSTITUTE A LEGAL SURVEY AND SHOULD  
BE CONSIDERED APPROXIMATE ONLY

SITE PLAN - EXISTING  
1" = 20'-0"

General Notes

No.	Revision/Issue	Date

Prepared and Addressed:  
**ELI SPORT ENGINEERING, INC.**  
 20501 8th Ave SW  
 Vashon, WA 98070  
 206.463.5311 - phone  
 206.463.2578 - fax

Project Name and Address:  
**HANSEN BULKHEAD**  
 9108 SW Bayview Drive  
 Vashon, WA 98070

Project:  
**HANSEN BULKHEAD**

Date:  
 20 JAN 2017

Drawn:  
 DSD

Engineer:  
 STK

**C2**

MAIN FILE COPY

SWOR17-0005

MAIN FILE COPY