

MAIN FILE COPY

K:\roads\EN\PRO\1127589-NE 165th Street Flood Risk Reduction\Development-Design\Work\CAD\DESIGN OAD\CIVIL DESIGN OAD\Permit\1127589\_COV permit.dwg SHIT:COV, 7/26/2017 11:46:23 AM, zhang, 12

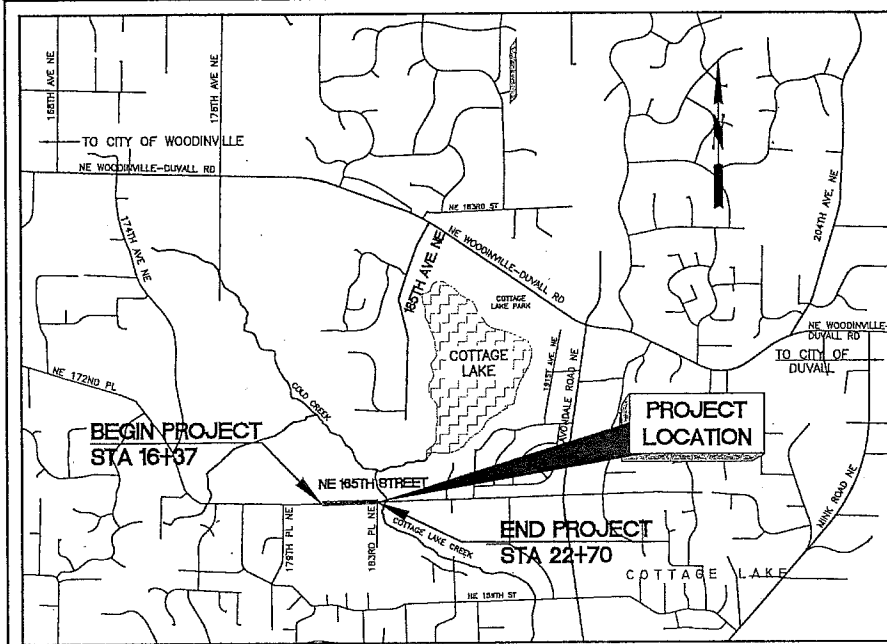

VICINITY MAP  
NTS

**PROJECT MANAGER:**  
DON BLEASDALE, KCDOT ROAD SERVICES, 206-477-3646

**SURVEYOR:**  
TREVOR CRAY, KCDOT ROAD SERVICES, 206-477-1628

**ECOLOGIST:**  
GRANT SMITH, KCDOT ROAD SERVICES, 206-477-2485

**GEOTECHNICAL:**  
ALAN CORWIN, KCDOT ROAD SERVICES, 206-477-1853

**GENERAL INFORMATION:**  
ADDRESS: KCDOT ROAD SERVICES  
201 SOUTH JACKSON STREET  
SEATTLE, WA 98104

LEGAL DESCRIPTION: NE 165TH STREET (PUBLIC R-O-W)  
EXISTING ZONE CLASSIFICATION: N/A (PUBLIC R-O-W)  
EXISTING SHORELINE DESIGNATION: RESIDENTIAL SHORELINE

**DRAWING INDEX**

SHEET	DESCRIPTION
1	COVER SHEET
2	LEGEND & ABBREVIATIONS
3	SUMMARY OF QUANTITIES
4	TYPICAL ROADWAY SECTION
5-6	ROADWAY PLAN & PROFILE
7-8	TEMPORARY EROSION AND SEDIMENT CONTROL (T.E.S.C.) PLAN & DETAILS
9	GEOSYNTHETIC WALL PROFILE
10	GEOSYNTHETIC WALL DETAILS
11	ROAD CLOSURE AND DETOUR PLAN
12	TRAFFIC CONTROL PLAN SHOULDER WORK WITH MINOR ENCROACHMENT

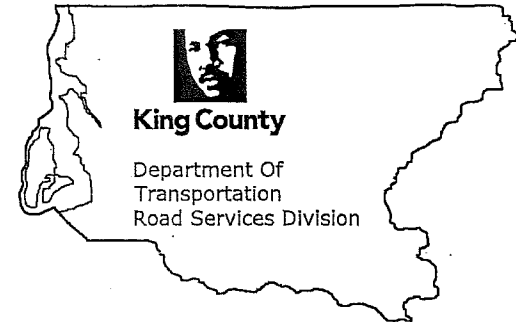

**NE 165TH STREET FLOOD RISK REDUCTION  
BETWEEN 179TH PLACE NE AND 183RD PLACE NE**

AUG 30 2017  
KING COUNTY  
D.P.E.R.

SHOR17-0027

PERMIT SET

SURVEY JOB No.	15093-15095	12/2015			
CHECKED:	T. CRAY	12/2015			
CAD ENTERED:	KARINEN/SAHAGUN	8/2017			
DESIGNED:	D. SAHAGUN	8/2017			
CHECKED:	D. BLEASDALE	8/2017			
SUPERVISOR:	A. MCGANUS	8/2017			
SECTION MANAGER:	E. CONYERS	8/2017			
	NUM.	REVISION	BY	DATE	

FED. AID No.	_____
PROJECT No.	1127589
MAINTENANCE DIVISION No.	1

KING COUNTY DEPT. OF TRANSPORTATION  
HAROLD TANIGUCHI, DIRECTOR  
NE 165TH STREET  
FLOOD RISK REDUCTION  
COVER SHEET

SHEET  
1  
OF  
12  
SHEETS  
319-95 (1)

MAIN FILE COPY SHOR17-0027