

Ashley Shoreline Design & Permitting

16412 NE 10th Place
 Bellevue, Washington 98008-3707
 Phone: (425) 957-9381
 e-mail: greg@shoreline-permitting.com

DRAWING BY: Gregory W. Ashley

Proprietary Information. This drawing contains confidential and / or privileged information which is intended for use by specific licensed individuals only. Any copying, disclosure, or dissemination of this communication is prohibited. All Designs Copyright 2019 - Ashley Shoreline Design & Permitting ***** www.shoreline-permitting.com

020310-0377
 AMES LAKE ADD COMMUNITY PROP VAL INCL
 PLAT LOT: 68

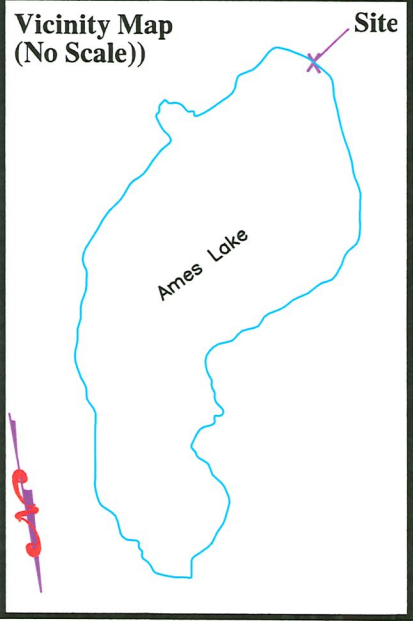
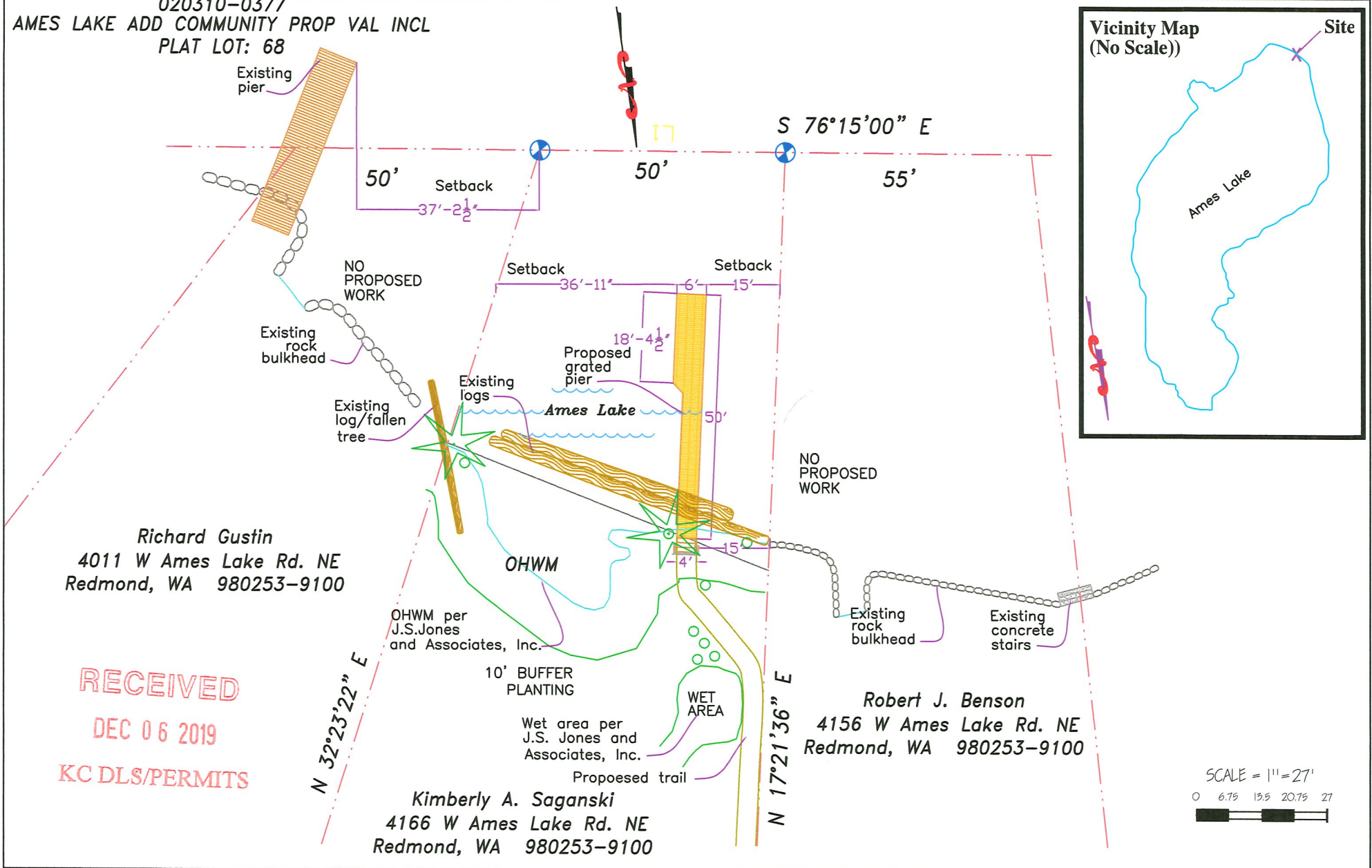

Richard Gustin
 4011 W Ames Lake Rd. NE
 Redmond, WA 980253-9100

Robert J. Benson
 4156 W Ames Lake Rd. NE
 Redmond, WA 980253-9100

Kimberly A. Saganski
 4166 W Ames Lake Rd. NE
 Redmond, WA 980253-9100

RECEIVED
 DEC 06 2019
 KC DLS/PERMITS

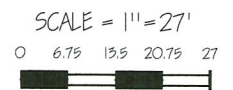

| | | | | |
|-------------------------|---|--|---------------------------------|---|
| SHORELINE PROJECT FOR : | Kimberly A. Saganski 4166 W Ames Lake Dr. NE Redmond, WA 98053-9100 | LOCATION: Ames Lake LAT: 47° 38' 42" North LONG: -122° 57' 18" West LENGTH FROM OHWM: 50' | DATUM: NGVD 26 SQ. FT. : 239 | PROJECT DESCRIPTION: Build new pier. Install upland access trail to pier. |
| PAGE: 1 of 1 | | | | DATE: 11/1/2019 SHAR 19-0025 |