

# Affidavit for Application Form

For alternate formats, call 206-296-6600.

<b>Parcel # (s)</b> 2824049007	<b>Permit #</b>
<b>Legal Description:</b> See Attachment	<b>Project Valuation</b> \$6,720,000
<b>Address of proposed work:</b> 7300 Perimeter Road S., Seattle, WA 98108	<b>Address not yet assigned</b> <input type="checkbox"/>
<b>Related permits or Pre-App #:</b> PREA19-0039	

<b>Contractor's License #:</b> N/A	<b>Expiration Date:</b> N/A
---------------------------------------	--------------------------------

O R

**Owner Affidavit In Lieu of Contractor Registration:** required for a property owner doing all of the work under this permit themselves.

*I certify under penalty of perjury that I am the property owner and I am exempt from the requirements of the Contractor Registration laws, RCW 18.27, (Definitions, RCW 18.27.010 and Exemptions, RCW 18.27.090) and I will do all my own work.*

Signature: \_\_\_\_\_

DESCRIPTIVE SUMMARY OF PROPOSED WORK			
Redevelop an airside leasehold on the King County International Airport to replace/improve existing UPS shipping hub. Includes building demolition, clearing and grading, construction of a new cargo sort facility and supporting structures, repaving for road and support vehicle movements and for transport-category aircraft.			
PROPERTY OWNER			
NAME KC Int. Arpt. (Matthew Sykora)	PHONE 206-296-7334	EMAIL msykora@kingcounty.gov	
MAILING ADDRESS 7277 Perimeter Road S.	CITY Seattle	STATE WA	ZIP 98108
APPLICANT <input type="checkbox"/> same as owner			
NAME Steve Ginevan	PHONE 720-676-9586	EMAIL sginevan@ups.com	
MAILING ADDRESS UPS Building & Systems Engineering,19500 E. 23 <sup>rd</sup> Ave.	CITY Aurora	STATE CO	ZIP 80011

**Critical Area Compliance:**  
The undersigned applicant declares: 1.) That the applicant is competent to be a witness herein; 2.) That the applicant is the applicant for the above project; 3.) That to the best of the applicant's knowledge, the critical areas on the development proposal site have not been illegally altered; and 4.) That the applicant has not previously been found in violation of critical areas regulations for any property in King County, or alternatively, that if there have been any violations, such violations have been cured to the satisfaction of King County.

I am submitting for a permit authorized by the international building, residential, fire, or mechanical codes and in anticipation of having it approved or approved with conditions, I have read the following statement and understand that failure to comply with all conditions once construction is begun may necessitate an immediate work stoppage until such time as compliance with the stipulated conditions is attained. I certify that I have made a diligent inquiry regarding the need for concurrent state or federal permits to engage in the work requested under this building permit, and no such permits are required or I will have obtained the required permits prior to issuance of this permit. I understand that the granting of this permit shall not be construed as satisfying the requirements of other applicable federal, state or local laws or regulations. In addition, I understand and agree that this permit does not authorize the violation of regulations. In addition, I understand and agree that this building permit does not authorize the violation of the Endangered Species Act as set forth at 16 U.S.C. § 1531-1543, including the prohibition on the "take" of threatened or endangered species. "Take" is defined at 16 U.S.C. § 1532(19). I fully understand that it is my sole responsibility to determine whether such "take" restrictions would be violated by work done pursuant to this permit, and I understand that I am precluded by Federal Law from undertaking work authorized by this permit if that work would violate the "take" restrictions set forth at 16 U.S.C. §1538, 50 C.F.R. §17.21, 50 C.F.R. §17.31, 50 C.F.R. §223, and 50 C.F.R. §224.

I certify under penalty of perjury and under the laws of the State of Washington the foregoing is true and correct. I further certify that all easements, deed restrictions, or other encumbrances restricting the use of the property are shown on the site plans submitted with this application. I further certify that I am familiar with King County's Community Trails Preservation Program, and I ☐ am/☒ am not interested in granting a voluntary easement for a rural equestrian trail. We (I) have been given authorization from the property owner to obtain this permit.

**I accept financial responsibility for all fees** associated with this permit or approval and will receive any applicable billings and/or refunds. As applicant I will receive and be responsible for all correspondence related to this permit record.

Applicant: Steven Ginevan

Steve Ginevan

Print Name

Signature

Date: 10/29/2019



**City of Seattle**  
Seattle Public Utilities

Sanitary Sewer Service Will Serve

Issued to: (address) 7300 Perimeter Rd S  
Tax Parcel No/s: 282404-9007  
Date of Issuance: 10/30/2019

Applicant's Contact Information:

Name: Barnaby Hoit  
Address: 3131 Elliott Ave Suite 400  
Seattle, WA 98121  
Email: [barnaby@kpg.com](mailto:barnaby@kpg.com)  
Telephone: 206-286-1640

This letter confirms that **7300 Perimeter Rd S** lies within Seattle Public Utilities' service area for public sewer conveyance. Seattle Public Utilities (SPU) owns and maintains a **8-inch, Sanitary, Vitrified Clay Main and a 12-inch, Sanitary, Reinforced Concrete Main** on the 7300 Perimeter Rd Property that is available to serve the subject property.

This letter expires 18 months after the date of issuance of this letter.

Depending upon the discharge volumes that will be generated from your proposed project, as well as the existing peak flows in the sewer conveyance system downstream, it is possible that SPU will require system improvements in order to serve your project. The need for system improvements is identified through the City of Seattle's Preliminary Assessment process, and communicated through the mailing of a Preliminary Assessment Report (PAR).

The PAR is a preliminary review of your project by the Seattle Department of Contruction and Inspections (SDCI), Seattle Department of Transportation (SDOT), Seattle City Light (SCL) and SPU to identify significant requirements that will need to be met in order to better inform the applicants design. This process starts when the Preliminary Application Form and Preliminary Application Site Visit have been completed. Contact SDCI Drainage and Sewer Desk at the [Applicant Services Center](#) on the 20<sup>th</sup> Floor of the Seattle Municipal Tower with any questions regarding the Preliminary Application Process.

SDCI Drainage and Sewer Desk can also be contacted by telephone at 206-684-5362 or via email at [sidesewerinfo@seattle.gov](mailto:sidesewerinfo@seattle.gov).

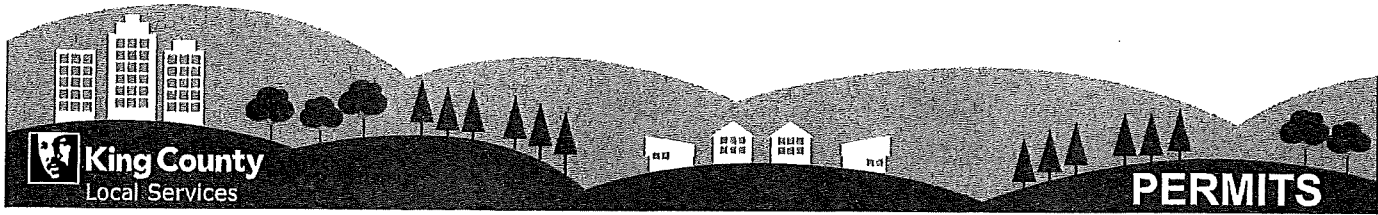

## Fire District Receipt

A Fire District Receipt is not required for single family, residential construction projects.

<b>Project Information</b> (see <u>Property Research Guide</u> to locate fire district information)				
PARCEL NUMBER(S)		PROJECT NAME		
N/A--Leasehold within King County International Airport		UPS BFI GATEWAY EXPANSION		
ADDRESS OF PROPOSED WORK <input type="checkbox"/> Address not yet assigned				
7300 PERIMETER RD S., SEATTLE WA 98108				
FIRE DISTRICT			FIRE DISTRICT NUMBER	
King County International Airport			Station #24	
<b>Applicant</b>				
FULL NAME		PHONE NUMBER	EMAIL ADDRESS	
STEVE GINEVAN (UPS PM)		720-676-9586	SGINEVAN@UPS.COM	
MAILING ADDRESS			CITY	STATE ZIP CODE
UPS BUILDING & SYSTEMS ENGINEERING, 19500 E 23RD AVE			AURORA	CO 80011
<b>Type of Development</b>				
<input checked="" type="checkbox"/> Commercial / Industrial Use		<input type="checkbox"/> Rezone		
<input type="checkbox"/> School / Classroom		<input type="checkbox"/> Retail Development		
<input type="checkbox"/> Apartment / Multifamily/Duplex		NUMBER OF BUILDINGS	NUMBER OF UNITS	
<input type="checkbox"/> Subdivision		NUMBER OF LOTS		
<input type="checkbox"/> Short subdivision / Short Plat		NUMBER OF LOTS		
<input type="checkbox"/> Conditional Use		<input type="checkbox"/> Other Use		

## Fire District Receipt, continued

### Description of Project, required for Conditional Use Permit or Other Use

Redevelop an airside leasehold on the King County International Airport to replace/improve existing UPS shipping hub. Includes building demolition, clearing and grading, construction of a new cargo sort facility and supporting structures, repaving for road and support vehicle movements and for transport-category aircraft.

A Fire District Receipt is required by King County Code 20.20.040. Issuance of this receipt does not imply an approval, disapproval or review of referenced project / proposal. This receipt shall be valid for 30 days from date of signature.

### Fire District

#### FIRE DISTRICT COMMENTS

*Receipt only, pending final approval by K.C.F.M.O.*

FIRE DISTRICT <i>KCIA / STATION 24</i>	PRINTED NAME Ross Fukuda
TITLE Fire Prevention Officer	SIGNATURE <i>Rosa Fukuda</i>
DATE 10/30/2019	

# Site Improvement Bond Quantity Worksheet

S15 Web date: 04/03/2015



## Department of Permitting & Environmental Review

35030 SE Douglas Street, Suite 210  
Snoqualmie, Washington 98065-9266  
**206-296-6600** TTY Relay 711

For alternate formats, call 206-296-6600.

**Project Name:** UPS BFI GATEWAY EXPANSION  
**Location:** KING COUNTY INTERNATIONAL AIRPORT, SEATTLE WA

**Date:** 10/31/2019  
**Project No.:** \_\_\_\_\_  
**Activity No.:** \_\_\_\_\_

Clearing greater than or equal to 5,000 board feet of timber?

yes

☒ no

If yes,

Forest Practice Permit Number:

(RCW 76.09)

Note: All prices include labor, equipment, materials, overhead and profit. Prices are from RS Means data adjusted for the Seattle area or from local sources if not included in the RS Means database.

# Site Improvement Bond Quantity Worksheet

S15 Web date: 04/03/2015

		Reference #	Unit Price	Unit	Quantity	# of Applications	Cost
<b>EROSION/SEDIMENT CONTROL</b>	<b>Number</b>						
Backfill & compaction-embankment	ESC-1		\$ 6.00	CY	0		\$ -
Check dams, 4" minus rock	ESC-2	SWDM 5.4.6.3	\$ 80.00	Each	0		
Crushed surfacing 1 1/4" minus	ESC-3	WSDOT 9-03.9(3)	\$ 95.00	CY	0		\$ -
Ditching	ESC-4		\$ 9.00	CY	0		
Excavation-bulk	ESC-5		\$ 2.00	CY	0		\$ -
Fence, silt	ESC-6	SWDM 5.4.3.1	\$ 1.50	LF	0		
Fence, Temporary (NGPE)	ESC-7		\$ 1.50	LF	0		\$ -
Hydroseeding	ESC-8	SWDM 5.4.2.4	\$ 0.80	SY	0		
Jute Mesh	ESC-9	SWDM 5.4.2.2	\$ 3.50	SY	3000	1	\$ 10,500.00
Mulch, by hand, straw, 3" deep	ESC-10	SWDM 5.4.2.1	\$ 2.50	SY	3000	2	\$ 15,000.00
Mulch, by machine, straw, 2" deep	ESC-11	SWDM 5.4.2.1	\$ 2.00	SY	0		\$ -
Piping, temporary, CPP, 6"	ESC-12		\$ 12.00	LF	300	1	\$ 3,600.00
Piping, temporary, CPP, 8"	ESC-13		\$ 14.00	LF	500	1	\$ 7,000.00
Piping, temporary, CPP, 12"	ESC-14		\$ 18.00	LF	200	1	\$ 3,600.00
Plastic covering, 6mm thick, sandbagged	ESC-15	SWDM 5.4.2.3	\$ 4.00	SY	5000	6	\$ 120,000.00
Rip Rap, machine placed; slopes	ESC-16	WSDOT 9-13.1(2)	\$ 45.00	CY	0		\$ -
Rock Construction Entrance, 50'x15'x1'	ESC-17	SWDM 5.4.4.1	\$ 1,800.00	Each	2	3	\$ 10,800.00
Rock Construction Entrance, 100'x15'x1'	ESC-18	SWDM 5.4.4.1	\$ 3,200.00	Each	0		
Sediment pond riser assembly	ESC-19	SWDM 5.4.5.2	\$ 2,200.00	Each	0		\$ -
Sediment trap, 5' high berm	ESC-20	SWDM 5.4.5.1	\$ 19.00	LF	0		\$ -
Sed. trap, 5' high, riprapped spillway berm section	ESC-21	SWDM 5.4.5.1	\$ 70.00	LF	0		\$ -
Seeding, by hand	ESC-22	SWDM 5.4.2.4	\$ 1.00	SY	0		\$ -
Sodding, 1" deep, level ground	ESC-23	SWDM 5.4.2.5	\$ 8.00	SY	0		\$ -
Sodding, 1" deep, sloped ground	ESC-24	SWDM 5.4.2.5	\$ 10.00	SY	0		\$ -
TESC Supervisor	ESC-25		\$ 110.00	HR	2000	1	\$ 220,000.00
Water truck, dust control	ESC-26	SWDM 5.4.7	\$ 140.00	HR	360	1	\$ 50,400.00
<b>WRITE-IN-ITEMS **** (see page 9)</b>							
Inlet Protection (TESC)	ESC-WI-1		\$ 100.00	Each	145	3	\$ 43,500.00
Straw Wattles/Compost Socks (TESC)	ESC-WI-2		\$ 7.00	LF	1500	2	\$ 21,000.00
Temporary Fence (2-yrs, installed/moved twice)	ESC-WI-3		\$ 5.00	LF	3600	2	\$ 36,000.00
Power Sweeping/Cleaning (TESC)	ESC-WI-4		\$ 150.00	HR	750	1	\$ 112,500.00

<b>ESC SUBTOTAL:</b>	\$ 653,900.00
<b>30% CONTINGENCY &amp; MOBILIZATION:</b>	\$ 196,170.00
<b>ESC TOTAL:</b>	\$ 850,070.00
<b>COLUMN:</b>	<b>A</b>

# Site Improvement Bond Quantity Worksheet

Web date: 04/03/2015

				Existing Right-of-Way		Future Public Right of Way & Drainage Facilities		Private Improvements	
		Unit Price	Unit	Quant.	Cost	Quant.	Cost	Quant.	Cost
<b>GENERAL ITEMS</b>		<b>No.</b>							
Backfill & Compaction- embankment	GI - 1	\$ 6.00	CY						
Backfill & Compaction- trench	GI - 2	\$ 9.00	CY					6500	\$ 58,500.00
Clear/Remove Brush, by hand	GI - 3	\$ 1.00	SY					10000	\$ 10,000.00
Clearing/Grubbing/Tree Removal	GI - 4	\$ 10,000.00	Acre					2	\$ 20,000.00
Excavation - bulk	GI - 5	\$ 2.00	CY					25000	\$ 50,000.00
Excavation - Trench	GI - 6	\$ 5.00	CY					7500	\$ 37,500.00
Fencing, cedar, 6' high	GI - 7	\$ 20.00	LF						\$ -
Fencing, chain link, vinyl coated, 6' high	GI - 8	\$ 20.00	LF					2400	\$ 48,000.00
Fencing, chain link, gate, vinyl coated, 20'	GI - 9	\$ 1,400.00	Each					3	\$ 4,200.00
Fencing, split rail, 3' high	GI - 10	\$ 15.00	LF						\$ -
Fill & compact - common borrow	GI - 11	\$ 25.00	CY					2500	\$ 62,500.00
Fill & compact - gravel base	GI - 12	\$ 27.00	CY					1500	\$ 40,500.00
Fill & compact - screened topsoil	GI - 13	\$ 39.00	CY						\$ -
Gabion, 12" deep, stone filled mesh	GI - 14	\$ 65.00	SY						\$ -
Gabion, 18" deep, stone filled mesh	GI - 15	\$ 90.00	SY						\$ -
Gabion, 36" deep, stone filled mesh	GI - 16	\$ 150.00	SY						\$ -
Grading, fine, by hand	GI - 17	\$ 2.50	SY						\$ -
Grading, fine, with grader	GI - 18	\$ 2.00	SY					77500	\$ 155,000.00
Monuments, 3' long	GI - 19	\$ 250.00	Each						\$ -
Sensitive Areas Sign	GI - 20	\$ 7.00	Each						\$ -
Sodding, 1" deep, sloped ground	GI - 21	\$ 8.00	SY						\$ -
Surveying, line & grade	GI - 22	\$ 850.00	Day					50	\$ 42,500.00
Surveying, lot location/lines	GI - 23	\$ 1,800.00	Acre					16	\$ 28,800.00
Traffic control crew ( 2 flaggers )	GI - 24	\$ 120.00	HR						\$ -
Trail, 4" chipped wood	GI - 25	\$ 8.00	SY						\$ -
Trail, 4" crushed cinder	GI - 26	\$ 9.00	SY						\$ -
Trail, 4" top course	GI - 27	\$ 12.00	SY						\$ -
Wall, retaining, concrete	GI - 28	\$ 55.00	SF					550	\$ 30,250.00
Wall, rockery	GI - 29	\$ 15.00	SF						

# Site Improvement Bond Quantity Worksheet

Web date: 04/03/2015

				Existing Right-of-way		Future Public Right of Way & Drainage Facilities		Private Improvements	
		Unit Price	Unit	Quant.	Cost	Quant.	Cost	Quant.	Cost
<b>ROAD IMPROVEMENT</b>									
	<b>No.</b>								
AC Grinding, 4' wide machine < 1000sy	RI - 1	\$ 30.00	SY						\$ -
AC Grinding, 4' wide machine 1000-2000sy	RI - 2	\$ 16.00	SY						\$ -
AC Grinding, 4' wide machine > 2000sy	RI - 3	\$ 10.00	SY					7000	\$ 70,000.00
AC Removal/Disposal	RI - 4	\$ 35.00	SY					77500	\$ 2,712,500.00
Barricade, type III ( Permanent )	RI - 6	\$ 56.00	LF						\$ -
Curb & Gutter, rolled	RI - 7	\$ 17.00	LF						\$ -
Curb & Gutter, vertical	RI - 8	\$ 12.50	LF					4750	\$ 59,375.00
Curb and Gutter, demolition and disposal	RI - 9	\$ 18.00	LF						\$ -
Curb, extruded asphalt	RI - 10	\$ 5.50	LF						\$ -
Curb, extruded concrete	RI - 11	\$ 7.00	LF						\$ -
Sawcut, asphalt, 3" depth	RI - 12	\$ 1.85	LF					5000	\$ 9,250.00
Sawcut, concrete, per 1" depth	RI - 13	\$ 3.00	LF						\$ -
Sealant, asphalt	RI - 14	\$ 2.00	LF						\$ -
Shoulder, AC, ( see AC road unit price )	RI - 15	\$ -	SY						\$ -
Shoulder, gravel, 4" thick	RI - 16	\$ 15.00	SY						\$ -
Sidewalk, 4" thick	RI - 17	\$ 38.00	SY					2000	\$ 76,000.00
Sidewalk, 4" thick, demolition and disposal	RI - 18	\$ 32.00	SY						\$ -
Sidewalk, 5" thick	RI - 19	\$ 41.00	SY						\$ -
Sidewalk, 5" thick, demolition and disposal	RI - 20	\$ 40.00	SY						\$ -
Sign, handicap	RI - 21	\$ 85.00	Each					6	\$ 510.00
Striping, per stall	RI - 22	\$ 7.00	Each					196	\$ 1,372.00
Striping, thermoplastic, ( for crosswalk )	RI - 23	\$ 3.00	SF					2400	\$ 7,200.00
Striping, 4" reflectorized line	RI - 24	\$ 0.50	LF					7200	\$ 3,600.00

Page 4 of 9

SUBTOTAL

\$ 2,939,807.00

# Site Improvement Bond Quantity Worksheet

Web date: 04/03/2015

				Existing Right-of-way		Future Public Right of Way & Drainage Facilities		Private Improvements	
		Unit Price	Unit	Quant.	Cost	Quant.	Cost	Quant.	Cost
<b>ROAD SURFACING</b>									
	<b>No.</b>	(4" Rock = 2.5 base & 1.5" top course) 9 1/2" Rock= 8" base & 1.5" top course)							
Additional 2.5" Crushed Surfacing	RS - 1	\$ 3.60	SY					\$	-
HMA 1/2" Overlay, 1.5"	RS - 2	\$ 14.00	SY					\$	-
HMA 1/2" Overlay 2"	RS - 3	\$ 18.00	SY					\$	-
HMA Road, 2", 4" rock, First 2500 SY	RS - 4	\$ 28.00	SY					\$	-
HMA Road, 2", 4" rock, Qty. over 2500 SY	RS - 5	\$ 21.00	SY					\$	-
HMA Road, 3", 9 1/2" Rock, First 2500 SY	RS - 6	\$ 42.00	SY					\$	-
HMA Road, 3", 9 1/2" Rock, Qty Over 2500 SY	RS - 7	\$ 35.00	SY					\$	-
Not Used	RS - 8							\$	-
Not Used	RS - 9							\$	-
HMA Road, 6" Depth, First 2500 SY	RS - 10	\$ 33.10	SY					2500	\$ 82,750.00
HMA Road, 6" Depth, Qty. Over 2500 SY	RS - 11	\$ 30.00	SY					45000	\$ 1,350,000.00
HMA 3/4" or 1", 4" Depth	RS - 12	\$ 20.00	SY					\$	-
Gravel Road, 4" rock, First 2500 SY	RS - 13	\$ 15.00	SY					\$	-
Gravel Road, 4" rock, Qty. over 2500 SY	RS - 14	\$ 10.00	SY					\$	-
PCC Road (Add Under Write-Ins w/Design)	RS - 15							\$	-
Thickened Edge	RS - 17	\$ 8.60	LF					\$	-

# Site Improvement Bond Quantity Worksheet

Web date: 04/03/2015

				Existing Right-of-way		Future Public Right of Way & Drainage Facilities		Private Improvements	
		Unit Price	Unit	Quant.	Cost	Quant.	Cost	Quant.	Cost
<b>DRAINAGE</b> (CPP = Corrugated Plastic Pipe, N12 or Equivalent) For Culvert prices, Average of 4' cover was assumed. Assume perforated PVC is same price as solid pipe.									
Access Road, R/D	D - 1	\$ 21.00	SY						\$ -
Bollards - fixed	D - 2	\$ 240.74	Each						\$ -
Bollards - removable	D - 3	\$ 452.34	Each						\$ -
* (CBs include frame and lid)									\$ -
CB Type I	D - 4	\$ 1,500.00	Each					34	\$ 51,000.00
CB Type IL	D - 5	\$ 1,750.00	Each					3	\$ 5,250.00
CB Type II, 48" diameter	D - 6	\$ 2,300.00	Each					48	\$ 110,400.00
for additional depth over 4'	D - 7	\$ 480.00	FT					2	\$ 960.00
CB Type II, 54" diameter	D - 8	\$ 2,500.00	Each						\$ -
for additional depth over 4'	D - 9	\$ 495.00	FT						\$ -
CB Type II, 60" diameter	D - 10	\$ 2,800.00	Each						\$ -
for additional depth over 4'	D - 11	\$ 600.00	FT						\$ -
CB Type II, 72" diameter	D - 12	\$ 3,600.00	Each					3	\$ 10,800.00
for additional depth over 4'	D - 13	\$ 850.00	FT					3	\$ 2,550.00
Through-curb Inlet Framework (Add)	D - 14	\$ 400.00	Each						\$ -
Cleanout, PVC, 4"	D - 15	\$ 150.00	Each						\$ -
Cleanout, PVC, 6"	D - 16	\$ 170.00	Each					50	\$ 8,500.00
Cleanout, PVC, 8"	D - 17	\$ 200.00	Each						
Culvert, PVC, 4"	D - 18	\$ 10.00	LF						\$ -
Culvert, PVC, 6"	D - 19	\$ 13.00	LF					5600	\$ 72,800.00
Culvert, PVC, 8"	D - 20	\$ 15.00	LF						
Culvert, PVC, 12"	D - 21	\$ 23.00	LF					5200	\$ 119,600.00
Culvert, CMP, 8"	D - 22	\$ 19.00	LF						\$ -
Culvert, CMP, 12"	D - 23	\$ 29.00	LF						\$ -
Culvert, CMP, 15"	D - 24	\$ 35.00	LF						\$ -
Culvert, CMP, 18"	D - 25	\$ 41.00	LF						\$ -
Culvert, CMP, 24"	D - 26	\$ 56.00	LF						\$ -
Culvert, CMP, 30"	D - 27	\$ 78.00	LF						\$ -
Culvert, CMP, 36"	D - 28	\$ 130.00	LF						\$ -
Culvert, CMP, 48"	D - 29	\$ 190.00	LF						\$ -
Culvert, CMP, 60"	D - 30	\$ 270.00	LF						\$ -
Culvert, CMP, 72"	D - 31	\$ 350.00	LF						\$ -

# Site Improvement Bond Quantity Worksheet

Web date: 04/03/2015

<b><u>DRAINAGE CONTINUED</u></b>				<b>Existing Right-of-way</b>		<b>Future Public Right of Way &amp; Drainage Facilities</b>		<b>Private Improvements</b>	
	No.	Unit Price	Unit	Quant.	Cost	Quant.	Cost	Quant.	Cost
Culvert, Concrete, 8"	D - 32	\$ 25.00	LF						
Culvert, Concrete, 12"	D - 33	\$ 36.00	LF						
Culvert, Concrete, 15"	D - 34	\$ 42.00	LF						
Culvert, Concrete, 18"	D - 35	\$ 48.00	LF					1000	\$ 48,000.00
Culvert, Concrete, 24"	D - 36	\$ 78.00	LF						
Culvert, Concrete, 30"	D - 37	\$ 125.00	LF						
Culvert, Concrete, 36"	D - 38	\$ 150.00	LF						
Culvert, Concrete, 42"	D - 39	\$ 175.00	LF						
Culvert, Concrete, 48"	D - 40	\$ 205.00	LF						
Culvert, CPP, 6"	D - 41	\$ 14.00	LF						
Culvert, CPP, 8"	D - 42	\$ 16.00	LF						
Culvert, CPP, 12"	D - 43	\$ 24.00	LF						
Culvert, CPP, 15"	D - 44	\$ 35.00	LF						\$ -
Culvert, CPP, 18"	D - 45	\$ 41.00	LF						\$ -
Culvert, CPP, 24"	D - 46	\$ 56.00	LF						\$ -
Culvert, CPP, 30"	D - 47	\$ 78.00	LF						\$ -
Culvert, CPP, 36"	D - 48	\$ 130.00	LF						\$ -
Ditching	D - 49	\$ 9.50	CY						\$ -
Flow Dispersal Trench (1,436 base+)	D - 50	\$ 28.00	LF						\$ -
French Drain (3' depth)	D - 51	\$ 26.00	LF						\$ -
Geotextile, laid in trench, polypropylene	D - 52	\$ 3.00	SY						\$ -
Mid-tank Access Riser, 48" dia, 6' deep	D - 54	\$ 2,000.00	Each						\$ -
Pond Overflow Spillway	D - 55	\$ 16.00	SY						\$ -
Restrictor/Oil Separator, 12"	D - 56	\$ 1,150.00	Each						\$ -
Restrictor/Oil Separator, 15"	D - 57	\$ 1,350.00	Each						\$ -
Restrictor/Oil Separator, 18"	D - 58	\$ 1,700.00	Each					3	\$ 5,100.00
Riprap, placed	D - 59	\$ 42.00	CY						\$ -
Tank End Reducer (36" diameter)	D - 60	\$ 1,200.00	Each						\$ -
Trash Rack, 12"	D - 61	\$ 350.00	Each						\$ -
Trash Rack, 15"	D - 62	\$ 410.00	Each						\$ -
Trash Rack, 18"	D - 63	\$ 480.00	Each						\$ -
Trash Rack, 21"	D - 64	\$ 550.00	Each						\$ -

# Site Improvement Bond Quantity Worksheet

Web date: 04/03/2015

				Existing Right-of-way		Future Public Right of Way & Drainage Facilities		Private Improvements	
		Unit Price	Unit	Quant.	Price	Quant.	Cost	Quant.	Cost
<b>PARKING LOT SURFACING</b>									
Not To Be Used For Roads Or Shoulders									
	<u>No.</u>								
2" AC, 2" top course rock & 4" borrow	PL - 1	\$ 21.00	SY	NA		NA			\$ -
2" AC, 1.5" top course & 2.5" base course	PL - 2	\$ 28.00	SY	NA		NA			\$ -
4" select borrow	PL - 3	\$ 5.00	SY	NA		NA			\$ -
1.5" top course rock & 2.5" base course	PL - 4	\$ 14.00	SY	NA		NA			\$ -
<b>UTILITY POLES &amp; STREET LIGHTING</b>									
Utility pole relocation costs must be accompanied by <b>Franchise Utility's Cost Estimate</b>									
Utility Pole(s) Relocation	UP-1	Lump Sum							
Street Light Poles w/Luminaires	UP-2	\$ 7,500.00	Each					43	\$ 322,500.00
<b>WRITE-IN-ITEMS</b>									
(Such as detention/water quality vaults.)	<u>No.</u>								
Stormwater Vault	WI - 1	\$ 380,000.00	Each					3	\$ 1,140,000.00
Groundside PCC	WI - 2	\$ 300.00	CY					3500	\$ 1,050,000.00
Airside PCC	WI - 3	\$ 350.00	CY					5000	\$ 1,750,000.00
Trench Drain	WI - 4	\$ 150.00	LF					975	\$ 146,250.00
Ductile Iron Storm Drain Pipe	WI - 5	\$ 55.00	LF					1450	\$ 79,750.00
	WI - 6								\$ -
	WI - 7								\$ -
	WI - 8								\$ -
	WI - 9								\$ -
	WI - 10								\$ -

SUBTOTAL			\$ 4,166,000.00
SUBTOTAL (SUM ALL PAGES):			\$ 9,883,767.00
30% CONTINGENCY & MOBILIZATION:			\$ 2,965,130.10
GRANDTOTAL:			\$ 12,848,897.10
COLUMN:	B	C	D

# Site Improvement Bond Quantity Worksheet

Web date: 04/03/2015

Original bond computations prepared by:

Name: BARNABY D. HOIT, PE  
 PE Registration Number: 37887  
 Firm Name: KPG INTERDISCIPLINARY DESIGN  
 Address: 3131 ELLIOT AVE SUIT 400, SEATTLE WA 98121

Date: 10/31/2019  
 Tel. #: 206-267-1040

Project No: \_\_\_\_\_

## FINANCIAL GUARANTEE REQUIREMENTS

	PERFORMANCE BOND* AMOUNT	MINIMUM BOND* AMOUNT REQUIRED FOR RECORDING OR TEMPORARY OCCUPANCY AT SUBSTANTIAL COMPLETION ***	PUBLIC ROAD & DRAINAGE MAINTENANCE/DEFECT BOND*
Stabilization/Erosion Sediment Control (ESC)	(A) \$ 850,070.0		
Existing Right-of-Way Improvements	(B) \$ -		
Future Public Right of Way & Drainage Facilities	(C) \$ -		
Private Improvements	(D) \$ 12,848,897.1		
Calculated Quantity Completed			
Total Right-of Way and/or Site Restoration Bond*/** (First \$7,500 of bond* shall be cash.)	(A+B) \$ 850,070.0		
Performance Bond* Amount (A+B+C+D) = TOTAL	(T) \$ 13,698,967.1 Minimum is \$2000.	T x 0.30 \$ 4,109,690.1 Minimum is \$2000.	
Maintenance/Defect Bond* Total			(B+C) x 0.25 = \$ - Minimum is \$2000.

NAME OF PERSON PREPARING BOND\* REDUCTION: \_\_\_\_\_

Date: \_\_\_\_\_

\* **NOTE:** The word "bond" as used in this document means a financial guarantee acceptable to King County.

\*\* **NOTE:** KCC 27A authorizes right of way and site restoration bonds to be combined when both are required.

The restoration requirement shall include the total cost for all TESC as a minimum, not a maximum. In addition, corrective work, both on- and off-site needs to be included. Quantities shall reflect worse case scenarios not just minimum requirements. For example, if a salmonid stream may be damaged, some estimated costs for restoration needs to be reflected in this amount. The 30% contingency and mobilization costs are computed in this quantity.

\*\*\* **NOTE:** Per KCC 27A, total bond amounts remaining after reduction shall not be less than 30% of the original amount (T) or as revised by major design changes.

REQUIRED BOND\* AMOUNTS ARE SUBJECT TO REVIEW AND MODIFICATION BY KING COUNTY



**King County**  
**Department of Permitting**  
**and Environmental Review**  
 35030 SE Douglas Street, Suite 210  
 Snoqualmie, Washington 98065-9266  
**206-296-6600** TTY Relay: 711  
 www.kingcounty.gov

## Landscape Bond Quantity Worksheet Form

For alternate formats, call 206-296-6600

**Project Name:** UPS BFI Gateway Project

**Permitting Project #:** \_\_\_\_\_

**Address:** 7300 Perimeter Road, Seattle, WA 98108

**Prepared By:** Coreen Schmidt, PLA **Phone:** 206-315-2978

Bonds are based upon required landscaping and will be posted for performance and/or maintenance. Required landscaping includes perimeter landscaping, surface parking area landscaping, (KCC 21A.16) and any landscaping required by SEPA environmental review. **The maintenance period is for the life of the project**, however, after posting for maintenance, the performance bond will be reduced to 30% of the total performance bond price including contingency, or other amount as warranted by site specific or current market considerations at the discretion of the department (\$1,000.00 minimum). Bonds will be held for a minimum two year period. Upon re-inspection of the site at the end of the monitoring period, the bond will be released if the site has been properly maintained (KCC 21A.16.180). If the project has not been maintained and there are dead trees, shrubs, ground cover, or other deficiencies noted in the required landscaping, the bond will be held until the deficiencies are corrected.

	UNIT PRICE	UNIT TYPE	QUANTITY	PRICE
SOD LAWN AREAS	\$500.00	MSF (1000 SQ. FT)	0	0
HYDROSEEDING	\$50.00	MSF (1000 SQ. FT)	0	0
<b>SOIL PREPARATION</b>				
A. TOPSOIL (6 INCHES DEEP)	\$25.00	CY (CUBIC YARD)	575	14,375
B. MULCH (2 INCHES DEEP)	\$4.00	SY (SQUARE YARD)	3430	13,720
C. PEAT MOSS (TWO INCHES DEEP)	\$2.30	SY (SQUARE YARD)	0	0
D. COMPOST (3 INCHES DEEP & TILLING	\$26.00	SY (SQUARE YARD)	0	0
E. FERTILIZER	\$6.67	CY (CUBIC YARD)	0	0
<b>PLANT MATERIALS</b>				
A. DECIDUOUS TREES				
1.75 - 2.00" CALIPER (minimum height 10') PERIMETER & PARKING AREAS	\$250.00 EACH	COST & LABOR	51	12,750
1.5 - 1.75" CALIPER INTERIOR LANDSCAPING OR OTHER REQUIRED LANDSCAPING	\$225.00 EACH	COST & LABOR	0	0
B. EVERGREEN TREES				
FIVE (5) FEET OR ABOVE	\$150.00 EACH	COST & LABOR	19	2,850
C. SHRUBS	\$35.00 EACH	COST & LABOR	1025	35,875
D. GROUND COVER	\$4.00 EACH	COST & LABOR	1850	7,400
<b>SUB TOTAL BOND AMOUNT</b>			<b>BOND AMOUNT SUB TOTAL:</b>	
			\$ 86,970	

	UNIT PRICE	UNIT TYPE	QUANTITY	PRICE
<b>MISCELLANEOUS</b>				
TREE STAKES	\$2.65 EACH	PER STAKE & LABOR	143	378.95
<b>FENCING:</b>				
SOLID WOOD CEDAR	\$28.50	LINEAR FOOT INCLUDES LABOR	0	0
BERMING	\$17.50	LINEAR FOOT INCLUDES LABOR	0	0
IRRIGATION	80¢	SQUARE FOOT	29227	23,381.60
RELOCATING TREES ON SITE				
36" BALL	\$260.00	EACH	0	0
60" BALL	\$920.00	EACH	0	0
RELOCATING SHRUBS ON SITE				
12" BALL	\$26.00	EACH	0	0
24" BALL	\$33.00	EACH	0	0
<b>ADDITIONAL ITEMS:</b>				
Onsite recreation facilities			0	0
<b>SUB TOTAL BOND AMOUNT</b>			<b>BOND SUB TOTAL:</b>	
			\$ 110,730.55	
<b>Add 30% of the Bond Sub-Total for Contingency in accordance with KCC 27A.30.020</b>			<b>30 % CONTINGENCY:</b>	
			\$ 33,219.17	
<b>TOTAL BOND PRICE *</b>			<b>TOTAL BOND PRICE:</b>	
			\$ 143,949.72	

\* NOTE: Permit inspection fees, in addition to the bond price, are required for monitoring the performance and maintenance of required landscaping.

TOPOGRAPHIC SURVEY

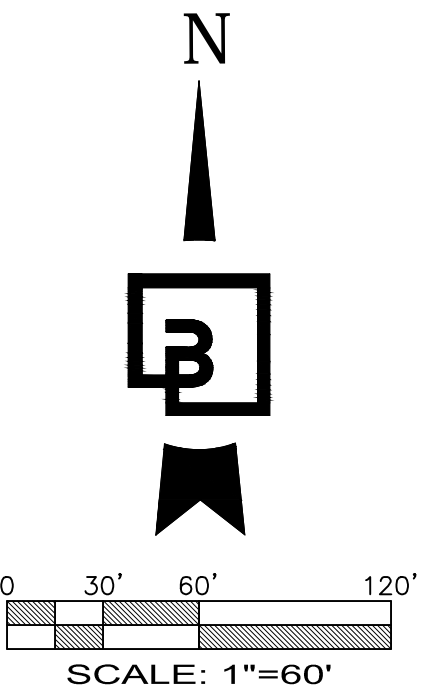
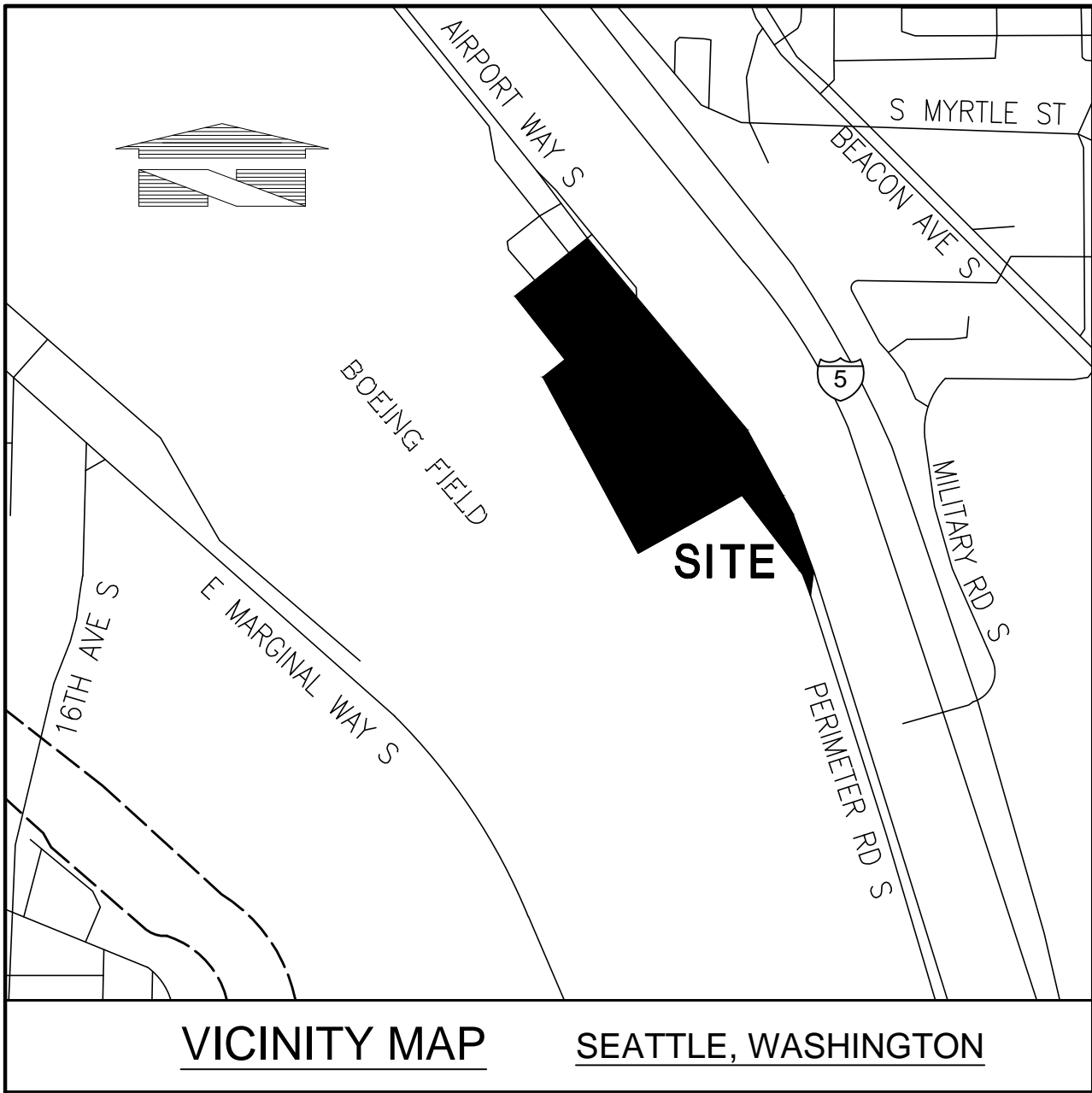

LEGEND

(NOTE: NOT ALL SYMBOLS MAY APPEAR ON THE MAP)

- SURVEY MONUMENT (AS NOTED)  
SECTION CORNER (AS NOTED)  
SET REBAR/CAP (LS#45789)  
FOUND REBAR/CAP (AS NOTED)  
SET 2"x2" HUB/TACK LINE STAKE  
MAG/WASHER OR LEAD/TACK (AS NOTED)  
BENCHMARK  
LUMINAIRE (LUM.)  
YARD LIGHT  
ORNAMENTAL LIGHT  
TRAFFIC SIGNAL LIGHTS  
POWER METER  
POWER POLE  
JUNCTION BOX (AS NOTED)  
TELEPHONE MANHOLE  
CATCH BASIN (CB)  
STORM MANHOLE (SDMH)  
SANITARY SEWER MANHOLE (SSMH)  
CLEANOUT (AS NOTED)  
GAS METER  
GAS VALVE  
WATER VALVE (WV)  
FAUCET  
FIRE HYDRANT(FH) / CONNECTION(FDC)  
WATER MANHOLE  
WATER METER  
BLOW-OFF / AIRVAC  
MONITOR WELL  
SIGN  
IRRIGATION SPRINKLER  
DIRECTIONAL ARROW  
HANDICAP  
CHAIN LINK FENCE  
WOOD FENCE  
HOGWIRE FENCE  
SILT FENCE  
METAL/IRON FENCE  
GUARD RAIL/CABLE FENCE  
WATER LINE  
GAS LINE  
STEAM LINE  
TELEPHONE LINE (OH) OR (UG)  
POWER LINE (OH) OR (UG)  
STORM LINE  
SEWER LINE  
ROCKERY  
KEYSTONE WALL  
DECIDUOUS TREE  
CONIFEROUS TREE  
TREE DRIFLINE  
CONCRETE  
GRAVEL/SAND (AS NOTED)  
ASPHALT  
BUILDING LINE

- ABBREVIATIONS  
REFERENCE SURVEYS  
OVERHEAD  
UNDERGROUND  
TYPICAL  
CALCULATED  
MEASURED  
ROOF DRAIN

HORIZONTAL DATUM: (NAD 83/91 NORTH ZONE)

**BASIS OF BEARINGS:**  
NORTH 35°14'13" WEST, AS MEASURED BETWEEN WSDOT MONUMENTS  
GP17005-179 (2621) & GP17005-181 (2623).

**VERTICAL DATUM — NAVD88**

**VERTICAL BENCHMARK:**  
WSDOT MONUMENT GP17005-179 (2621), BEING THE TOP OF A FOUND CONCRETE  
MONUMENT W/ 3" BRASS DISK LEVEL WITH WEST CONCRETE SHOULDER OF I-5, 3.8±  
MI. SOUTH OF I-90.  
ELEV. = 86.61 US FEET (NAVD 88)

**PROCEDURE / NARRATIVE**

A FIELD TRAVERSE USING A TOPCON "GT1000" TOTAL STATION, "TOPCON  
HYPER HR" GPS UNIT AND TOPCON "TC5000" DATA COLLECTOR  
SUPPLEMENTED WITH AND FIELD NOTES WAS PERFORMED, ESTABLISHING THE  
ANGULAR, DISTANCE, BETWEEN THE MONUMENTS, PROPERTY LINES, AND  
TOPOGRAPHIC FEATURES AS SHOWN HEREON. THE RESULTING DATA MEETS OR  
EXCEEDS THE STANDARDS FOR LAND BOUNDARY SURVEYS AS SET FORTH  
IN WAC 332-130-090.

**DATES OF SURVEYS:**

FIELD SURVEY BY BARGHAUSEN CONSULTING ENGINEERS, INC. CONDUCTED IN  
JANUARY 2019.

**SURVEYORS NOTES:**

1. UNDERGROUND UTILITIES AND FEATURES DEPICTED HEREON ARE BASED  
ON FIELD OBSERVATION, MARKINGS, DEVELOPMENT PLANS, AND/OR AVAILABLE  
RECORD DOCUMENTS ONLY. THE TRUE LOCATION, NATURE AND/OR EXISTENCE  
OF BELOW GROUND FEATURES, DETECTED OR UNDETECTED, SHOULD BE  
VERIFIED.

- ALL DISTANCES ARE IN US FEET
- THIS IS NOT A BOUNDARY SURVEY
- NO TITLE REPORT WAS REVIEWED FOR THIS SURVEY
- NO ZONING REPORT WAS PROVIDED FOR THIS SURVEY

6. AREA SURVEYED FALLS WITHIN APN 2824049007, KING COUNTY AIRPORT

**EASEMENTS:**

1. US WEST COMMUNICATIONS EASEMENT, REC. NO. 9304141838 SHOWN PER  
PROVIDED CAD FILE.

2. 10 FOOT WIDE WATERLINE AND 10 FOOT WIDE SEWER EASEMENTS PER  
REC. NO. 5212110 ARE SHOWN AT RECORD LOCATION PER DOCUMENT.

NO OTHER EASEMENTS WERE PROVIDED.

R.O.S FOR BOEING FILED, REC. NO. 20070427900001, VOL. 223 OF  
SURVEYS, PGS. 148-255 DEPICTS A POSSIBLE EASEMENT LINE RUNNING  
ALONG THE SHOWN ON-SITE SEWER LINE.

**REFERENCE SURVEYS:**

1. R.O.S. FOR BOEING FILED, REC. NO. 20070427900001, VOL. 223 OF  
SURVEYS, PGS. 148-255



**SURVEYOR'S CERTIFICATE:**

THIS IS TO CERTIFY THAT THIS MAP OR PLAT AND THE SURVEY UPON WHICH IT IS BASED  
WERE MADE BY ME OR UNDER MY DIRECTION AND CORRECTLY REFLECTS THE CONDITIONS OF  
THIS SITE AS OF THE DATE OF THE FIELD SURVEY AS NOTED HEREON.

*Owen B. Hille*  
OWEN B. HILLE, P.L.S.  
WASHINGTON REGISTRATION NO. 40016

4/12/2019  
DATE

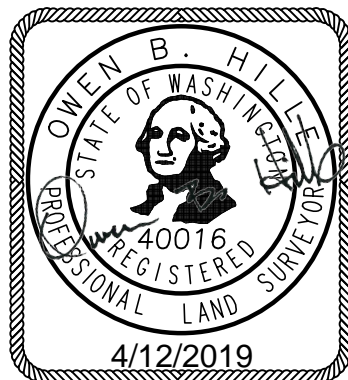

**Barghausen Consulting Engineers, Inc.**  
18215 72nd Avenue South  
Kent, WA 98032  
425.251.6222  
**barghausen.com**

Job Number  
**20632**  
Sheet  
**1 of 3**

**UPS - BOEING FIELD  
BFI-GATEWAY**

For:

Scale:  
Horizontal  
1"=60'  
Vertical  
1"=60'  
Designed  
Drawn  
Checked  
Approved  
Date 4/12/19

**TOPOGRAPHIC SURVEY**  
PTN OF THE NE1/4 OF THE SW1/4  
AND THE NW1/4 & SW1/4 OF THE SE1/4  
OF SEC. 28, T24N, R4E, W.M.  
CITY OF SEATTLE, KING COUNTY, STATE OF WASHINGTON

Title:

Revision

No.

Date

By

Ckd.

Appr.



TOPOGRAPHIC SURVEY

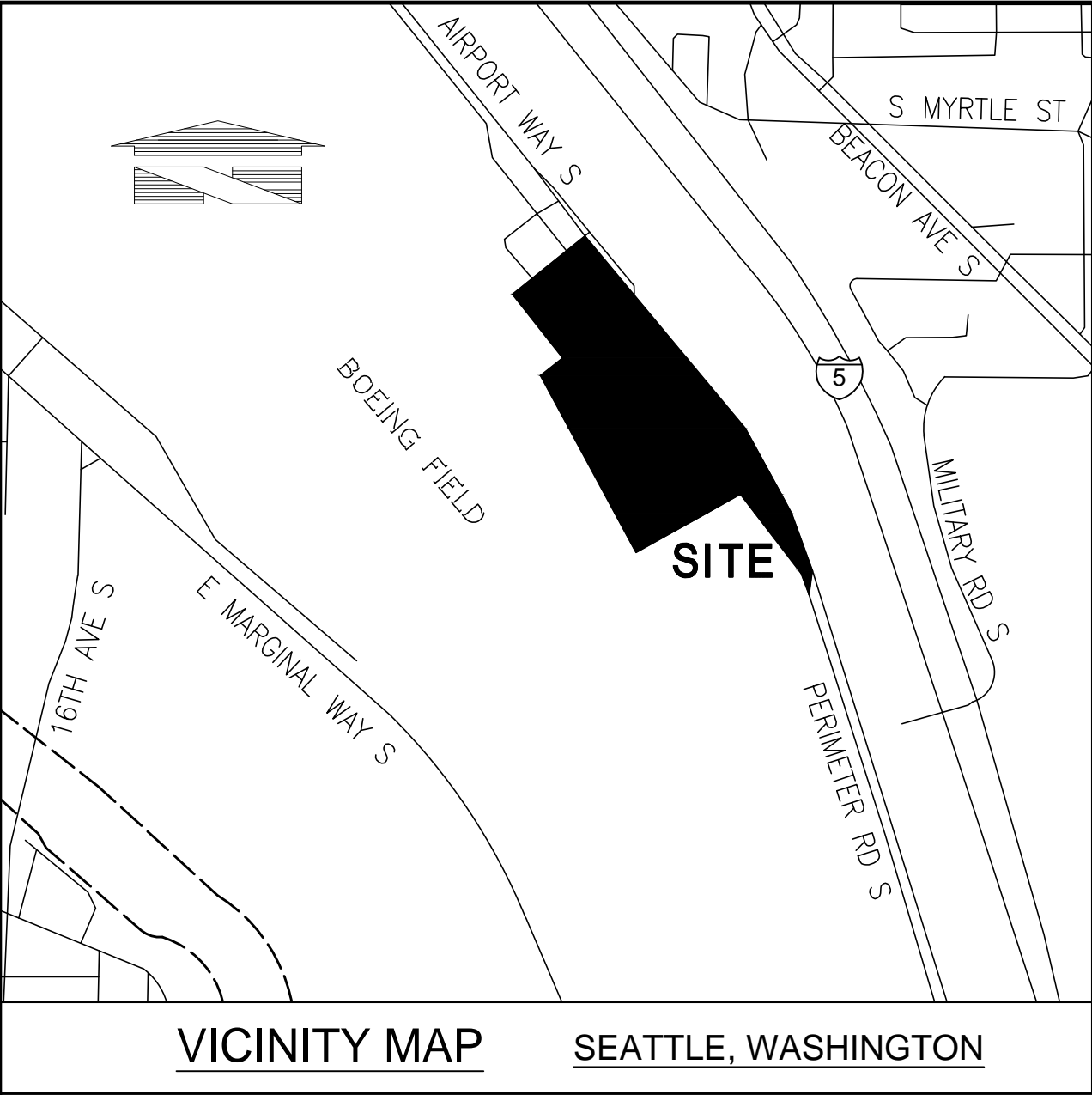

STORM AND SEWER STRUCTURES

1. SSMH RIM=18.00' 10" CNC N IE=7.45' 10" CNC S IE=7.60' 6" CNC SW IE=7.55'	2. SSMH RIM=18.75' 12" CNC NW IE=8.65' 10" CNC E IE=7.05' 10" CNC SW IE=6.75'	3. SSMH RIM=18.61' 12" CNC NW IE=6.26' 12" CNC SE IE=6.26'	4. SSMH RIM=19.08' 12" CNC NW IE=5.93' 12" CNC SE IE=6.03'	5. SSMH RIM=19.47' 12" CNC NW IE=5.50' 12" CNC SE IE=5.60'	6. SSMH RIM=19.61' 12" CNC NW IE=5.11' 12" CNC SE IE=5.26'	7. SSMH RIM=19.45' 8" SW IE=4.95' 12" SE IE=4.95'	8. SSMH RIM=19.73' 8" CNC NW IE=15.58' 6" CNC SE IE=16.13' 8" CNC S IE=15.68'	9. SDMH RIM=17.64' 8" DI NW IE=13.19' 12" CNC NE IE=12.29' 8" CLAY SE IE=13.19' 12" CNC SW IE=12.39'	10. SSMH RIM=19.28' 8" CNC N IE=11.91' 8" CNC SE IE=12.08'	11. SSMH RIM=19.30' 8" CNC N IE=12.45' 8" CNC SW IE=12.55'	12. SSMH RIM=18.56' 12" CNC NW IE=12.51' 12" CNC SE IE=12.55' 6" CNC NW IE=PLUGGED	13. SSMH RIM=18.33' 12" CNC NW IE=11.58' 8" CNC E IE=11.68' 12" CNC SE IE=11.68'	14. SSMH RIM=19.26' 12" CNC N IE=13.59' 12" CNC SE IE=13.67' 8" CNC SW IE=13.75'	15. SSMH T2 RIM=18.90' 10" CNC NE IE=14.19' 8" CNC W IE=14.25' 10" CNC SW IE=14.25'	16. SSMH RIM=19.33' 12" CNC NW IE=10.58' 12" CNC S IE=10.68'	17. SDMH RIM=17.30' 18" CNC NW IE=12.95' 18" CMP S IE=12.95'	18. SDMH RIM=16.84' 12" DI SW IE=10.26'	19. SDMH RIM=16.86' 12" PVC NE IE=10.96'	20. CB STD GRT RIM=19.36' 8" DI W IE=17.26'	21. SDMH RIM=18.53' 18" CNC N IE=14.43' 8" DI E IE=16.33' 18" CNC S IE=14.43'	22. CB STD GRT RIM=19.58' 8" DI SW IE=16.43'	23. CB SOLID LID RIM=18.16' 18" CNC NW IE=14.66' 8" DI NE IE=15.66' 18" CNC SE IE=14.66'	24. CB SOLID LID RIM=18.41' N IE=14.66' S IE=14.66'	26. CB SOLID LID RIM=18.15' 18" CNC NW IE=15.00' 8" DI E IE=15.75' 18" CNC SE IE=15.00'	27. CB SOLID LID RIM=18.91' 8" CNC NW IE=15.21' 6" PVC NE IE=16.06' 18" CNC SE IE=15.21'	28. CB STD GRT T1 RIM=19.18' 6" CNC NW IE=16.88' 6" CNC NE IE=17.03' 6" CNC SW IE=16.83'	29. CB STD GRT RIM=19.21' 18" CNC NW IE=15.31' 18" CNC SE IE=15.31'	30. CB STD GRT T1 RIM=19.03' 6" PVC NW IE=17.53' 6" PVC N IE=17.73' 6" PVC SE IE=17.73'	31. CB STD GRT T1 RIM=18.93' 6" CNC SE IE=17.77'	32. CB SOLID LID RIM=19.87' 6" PVC NW IE=16.31' 18" CNC SE IE=16.22'	33. CB STD GRT T1 RIM=19.36' ???? SW IE=17.26'	34. CB STD GRT T1 RIM=19.27' 6" PVC SE IE=16.70' 6" PVC S IE=16.77'	35. 950506 CB STD GRT RIM=19.79' 6" PVC NW IE=17.06'	36. CB STD GRT RIM=19.92' 6" PVC N IE=16.32' 12" CNC SE IE=13.46'	37. CB STD GRT RIM=19.92' 6" CNC SE IE=16.47' 6" PVC NW IE=16.47'	38. CB STD GRT RIM=20.40' 6" CNC NE IE=15.85' 8" PVC NW IE=15.80' 6" PVC SE IE=15.90'	39. CB STD GRT RIM=19.19' 6" CNC NW IE=17.09' 6" PVC SW IE=17.09' 6" CNC SSW IE=17.24'	40. CB STD GRT T1 RIM=19.41' 6" PVC ESE IE=17.06'	41. CB STD GRT T1 RIM=20.28' 8" PVC NW IE=15.43' 8" CNC SE IE=15.73'	42. CB STD GRT T1 RIM=19.92' 12" CNC NW IE=14.17' 8" CNC SE IE=14.37'	43. CB STD GRT T1 RIM=19.92' 12" CNC NW IE=14.17' 8" CNC SE IE=14.37'	44. CB STD GRT T1 RIM=19.76' 8" PVC SW IE=18.06'	45. CATCH BASIN RIM=19.32' 8" CNC NW IE=15.42' 8" PVC NE IE=15.26' 6" PVC SW IE=15.52'	46. CB STD GRT RIM=17.52' 6" PVC NE IE=16.27'	47. CB STD GRT RIM=19.83' 12" CNC NW IE=13.58' 12" CNC SE IE=13.73'	48. CB STD GRT RIM=19.45' 12" CNC SW IE=13.30' 12" CNC NE IE=13.35' 12" CNC SE IE=13.45'	49. CB STD GRT RIM=19.35' 8" CNC NW IE=12.73' 12" CNC NE IE=10.20' 8" CNC SE IE=13.85' 12" CNC SW IE=13.10'	50. CB STD GRT RIM=18.29' 8" CNC NW IE=13.19' 12" CNC NE IE=12.79' 12" CNC SW IE=12.84' 6" PVC SW IE=16.59'	51. CB STD GRT RIM=18.36' 6" PVC NW IE=16.36' 8" CNC SE IE=14.24'	52. CB STD GRT RIM=19.44' 8" CNC NW IE=14.94' 8" CNC SE IE=14.74'	53. CB STD GRT RIM=18.81' 8" PVC NW IE=14.86' 8" PVC SE IE=14.86'	54. CB RND LID RIM=18.81' 12" CNC NW IE=12.71' 8" CNC NE IE=13.64' 8" CNC SE IE=13.66' 12" CNC SW IE=12.86'	55. SDMH RIM=19.33' 12" CNC NW IE=13.48' 8" DI NE IE=17.28' 12" CNC SE IE=13.48'	56. CB RND LID RIM=18.80' 6" PVC N IE=15.96'	57. CB STD GRT T1 RIM=18.43' 6" PVC SW IE=17.48' 6" PVC NE IE=17.38'	58. SDMH RIM=19.01' 2" DI NE IE=13.56' 2" DI SW IE=13.56' 4" DI SW IE=13.56'	59. SD CLEANOUT RIM=17.90'	60. CB STD GRT T1 RIM=18.42' 6" PVC NE IE=16.52'	61. SDMH RIM=20.16' 12" CNC NW IE=13.46' 12" CNC SE IE=13.46'	62. CB RND LID RIM=18.68' 6" CNC NW IE=16.54'	63. CATCH BASIN RIM=18.68' 6" CNC NW IE=15.28' 8" CNC NE IE=15.13' 6" PVC SW IE=15.18'	64. CB STD GRT T2 RIM=19.22' 8" PVC SW IE=16.47' 6" PVC SE IE=16.62'	65. CB STD GRT T1 RIM=19.02' CLOGGED UNABLE TO MEASURE	66. CB STD GRT RIM=18.62' 6" CNC NW IE=15.72' 8" PVC NE IE=15.37' 8" DI SW IE=15.52'	67. CB STD GRT T1 RIM=19.04' 6" PVC SE IE=16.48'	68. CATCH BASIN RIM=17.79' 6" CNC SW IE=15.29' 6" CNC NE IE=15.29'	69. CB RND LID RIM=17.43' 6" CNC NE IE=15.28'	70. CATCH BASIN RIM=17.88' 8" PVC N IE=15.73'	71. SDMH RIM=18.76' 8" ADS NW IE=15.31' 12" CNC NE IE=14.66' 8" ADS SE IE=15.31' 8" CNC SW IE=14.66' 4" DI W IE=16.81'	72. CB STD GRT RIM=18.25' 8" PVC NW IE=16.20' 8" ADS SE IE=16.20'	73. CB RND LID T2 RIM=18.72' 12" CNC SW IE=15.48' 12" CNC SE IE=15.43'	74. CB RND LID RIM=18.94' 12" CNC SW IE=14.04' 12" CNC SE IE=14.04'	75. CB RND LID RIM=18.84' 8" CNC NW IE=16.54' 6" CNC SE IE=16.54'	8" SW IE=16.19' 76. CB STD GRT T1 RIM=19.25' 6" CNC NW IE=16.55' 8" CNC SE IE=16.15'	77. CATCH BASIN RIM=18.10' 8" ADS SE IE=16.95'	78. CATCH BASIN RIM=18.09' 4" DI SE IE=16.89'	79. CATCH BASIN RIM=18.04' 4" DI S IE=17.04'	80. CATCH BASIN RIM=18.97' 8" SW IE=15.67'	81. CB STD GRT T1 RIM=19.18' 4" CNC SE IE=17.58'	82. CB STD GRT T1 RIM=19.24' 6" CNC SE IE=16.94'	83. CB RND LID T2 RIM=18.80' 6" CNC NW IE=17.25' 8" DI E IE=17.25' 6" CNC S IE=17.35'	84. CB RND LID RIM=19.15' 6" CNC SW IE=17.75' 6" CNC SE IE=17.65'	85. CB STD GRT T1 RIM=19.58' 8" DI NE IE=17.56'	86. CB STD GRT T1 RIM=19.39' 8" DI N IE=16.89' 8" DI SE IE=16.94' 8" DI SW IE=17.09'	87. CB STD GRT T1 RIM=19.30' 8" DI NW IE=17.45'	88. SDMH GRATED RIM=19.36' 8" CNC N IE=16.50' 8" DI S IE=16.24' 8" DI SSW IE=16.78'	89. SDMH RIM=20.16' 12" CNC NW IE=14.51' 12" CNC SE IE=15.36' 6" CNC SW IE=15.36'	90. CATCH BASIN RIM=19.90' 8" SW IE=16.75'	91. CATCH BASIN RIM=19.91' 5" PVC SW IE=19.11' 3" PVC E IE=19.11' 6" CNC E IE=18.31'	92. CATCH BASIN RIM=19.14' 8" PVC SE IE=17.94'	93. CB STD GRT T1 RIM=19.04' 8" CNC SW IE=16.89'	94. CB STD GRT T1 RIM=18.88' 8" PVC NW IE=17.18' 8" CNC NE IE=16.43' 12" CNC SE IE=16.33' 8" CNC SW IE=16.38'	95. CB STD GRT T1 RIM=18.68' 6" CNC NW IE=16.78' 8" CNC NE IE=16.73'	96. CB STD GRT T1 RIM=18.48' 6" CNC N IE=16.58' 8" CNC E IE=16.52'	97. CB STD GRT T2 RIM=18.79' 6" CNC SE IE=16.89'	98. CB STD GRT T1 RIM=18.52' 6" CNC SE IE=16.07' 99. SDMH T2 RIM=18.38' 12" CNC NW IE=15.53' 8" CNC W IE=15.58' 12" CNC SW IE=15.48' 12" CNC SE IE=15.43'	100. SD STD GRT T1 RIM=17.86' 12" CNC NE IE=15.71' 12" CNC SW IE=15.66'	101. CB STD GRT T1 RIM=17.92' 12" CNC NE IE=16.27' 3" DI E IE=16.94' 6" CNC W IE=16.40'	102. SDMH RIM=18.01'	103. SDMH T2 RIM=18.89' 18" CNC NW IE=14.89' 18" CNC SW IE=14.69'	104. CB STD GRT T1 RIM=17.68' 18" CNC NE IE=14.28' 18" PVC SW IE=14.65'	105. CB STD GRT T1 RIM=17.29' 18" CNC NE IE=14.59' 18" CNC SE IE=14.49' 8" CNC SW IE=15.29' 8" CNC NW IE=15.49'	106. CB STD GRT T2 RIM=17.09' 16" CNC N IE=13.47' 16" CNC SW IE=13.29'	107. SDMH RIM=17.45' 2" DI NW 2" DI NW	108. SDMH RIM=17.16' LOCKED	109. CB SOLID LID RIM=17.80' 8" CNC NW IE=13.15' 18" CNC SE IE=11.55'	110. CATCH BASIN RIM=17.28' 18" CNC NW IE=12.08' 8" CNC SE IE=12.08'	111. CB STD GRT RIM=16.91' 15" CNC N IE=12.36' 18" CNC E IE=12.26' 18" CNC W IE=12.06'	112. SDMH RIM=17.43' UNABLE TO MEASURE	113. CB RND LID RIM=16.61' 8" DI NW IE=12.51' 6" CNC SE IE=13.11' 6" DI SW IE=13.39'	114. CATCH BASIN RIM=16.86' UNABLE TO MEASURE	115. CATCH BASIN RIM=16.10' 8" PVC SW IE=13.73' 6" PVC NE IE=13.77'	116. CATCH BASIN RIM=17.17'	117. CATCH BASIN RIM=16.87' 18" CMP NW IE=13.77' 6" CNC SW IE=13.87' 12" CMP S IE=13.77' 6" CNC SE IE=14.37'	118. CB SOLID LID RIM=17.54' POWER VAULT	119. CATCH BASIN RIM=16.87' UNABLE TO MEASURE	120. CATCH BASIN RIM=16.98' UNABLE TO MEASURE	121. CB STD GRT T1 RIM=16.72' 12" CMP N IE=13.92' 8" CNC SW IE=13.92' 12" CMP S IE=13.92'	122. CATCH BASIN RIM=16.61' 12" CMP NW IE=14.16' 8" CNC W IE=14.36' 12" CMP SE IE=14.16' 6" CNC NE IE=14.23'	123. CB STD GRT T1 RIM=17.18' 6" CNC NW IE=16.08'	124. CATCH BASIN RIM=16.85' UNABLR TO MEASURE	125. CATCH BASIN RIM=17.01' UNABLE TO MEASURE	126. CATCH BASIN RIM=17.00' UNABLE TO MEASURE	127. CB STD GRT RIM=16.24' 4" PVC NW IE=13.69' 8" PVC SW IE=13.39'	128. CATCH BASIN RIM=17.38' UNABLE TO MEASURE	129. CB STD GRT T1 RIM=16.91' 8" CNC SE IE=15.26'	130. CB RND LID RIM=17.13' 8" CNC NW IE=15.48' 8" PVC SE IE=15.28'	131. CB STD GRT T1 RIM=16.77' 8" CNC NW IE=13.77' 8" CNC SE IE=13.77'	132. CATCH BASIN RIM=17.26' 8" CNC NW IE=14.76' 8" CNC SE IE=14.61'	133. CB STD GRT T1 RIM=16.57' 8" PVC NW IE=13.62' 8" CNC SE IE=13.72'	134. CB STD GRT T1 RIM=17.89' 4" DI N IE=16.29' 4" DI E IE=16.29'	135. CB STD GRT T1 RIM=17.89' 4" DI W IE=15.64' 4" DI S IE=15.64'	136. CB STD GRT T1 RIM=17.93' 4" DI NW IE=16.83' 2" DI NE IE=16.53'	137. CB STD GRT T1 RIM=17.69' 4" DI NW IE=16.94'	138. CATCH BASIN RIM=17.09'	139. CATCH BASIN RIM=17.19' 8" CNC NW IE=14.27' 18" CNC E IE=13.89' 12" CNC SE IE=13.89'	140. CB STD GRT T1 RIM=17.15' ???? N IE=13.15' 12" CNC NE IE=12.20' 12" CNC SW IE=12.20'	141. CB STD GRT T2 RIM=18.12' 12" ADS NW IE=11.02' 18" ADS NE IE=10.00' 8" PVC SE IE=12.97' 18" ADS SW IE=9.82'	142. CB STD GRT RIM=17.40' 8" CNC NW IE=13.45' 8" CNC NE IE=13.55'	143. CB STD GRT T1 RIM=18.12' 8" CNC N IE=14.07' 8" CNC SE IE=14.37' 8" CNC SW IE=14.32'	144. CB STD GRT T1 RIM=18.02' 8" CNC S IE=14.42'	145. CB STD GRT T1 RIM=17.49' 8" CNC NW IE=14.04'	146. CB SOLID LID RIM=17.61' 6" CNC NW IE=15.91'	147. CB STD GRT RIM=16.54'	148. CATCH BASIN RIM=16.18' 12" CNC SW IE=12.18' 12" CNC NE IE=12.18'	149. SDMH RIM=16.43' LOCKED UNABLE TO MEASURE	150. CB STD GRT T1 RIM=15.95' 8" CNC SW IE=13.15' 12" CNC SE IE=12.90'	151. SDMH RIM=17.31' LOCKED UNABLE TO MEASURE	152. CATCH BASIN T2 RIM=16.73' 18" CNC SW IE=9.40' 18" DI NE IE=9.40'	153. SDMH RIM=16.76' 18" DI SW IE=9.41' 24" PVC NE IE=8.26' 18" CMP E IE=9.41'	154. SDMH RIM=16.81' 24" PVC W IE=9.41' 18" DI NE IE=9.41'	155. SDMH	156. SDMH RIM=16.83' 18" PVC NW IE=8.63' 18" ADS S IE=9.83'	157. SDMH RIM=16.84' 12" ADS SE IE=10.94' 12" PVC SW IE=10.94'	158. CB STD GRT T1 RIM=15.95' 8" PVC NE IE=13.65'	159. CB STD GRT RIM=16.71' 18" CNC E IE=9.67' 18" CNC SW IE=9.67' 8" PVC SW IE=12.96'	160. CB STD GRT T2 RIM=16.71' 18" CNC W IE=10.61' 18" CNC E IE=10.61' 18" CNC SE IE=10.14'	161. CB STD GRT RIM=15.99' 8" PVC NE IE=10.49' 18" CNC SE IE=10.14' 18" CNC SW IE=10.14'	162. CB STD GRT T1 RIM=17.17' 8" PVC SW IE=15.02'
---	---	---	---	---	---	--	---	---	---	---	--	--	--	---	---	---	---	--	---	---	--	--	--	---	--	--	--	---	--	---	--	--	---	--	--	---	--	---	---	--	--	--	--	---	--	--	--	--	--	--	--	--	--	--	---	--	-------------------------------	--	--	---	--	---	---	--	--	---	---	---	--	--	---	--	--	--	--	---	--	--	--	--	---	--	---	--	---	---	---	--	--	--	--	--	---	---	--	---	--	---	-------------------------	--	--	--	---	---	-----------------------------------	--	---	--	--	--	---	--	--------------------------------	---	--	---	---	---	---	---	---	---	---	---	---	---	---	--	--	--	--	--	--	--	--------------------------------	--	--	--	---	--	--	---	--	-------------------------------	--	--	---	--	--	--	---	-----------	--	---	---	---	--	--	---

**Barghausen**  
**Consulting Engineers, Inc.**  
18215 72nd Avenue South  
Kent, W 98032  
425.251.6222  
**barghausen.com**

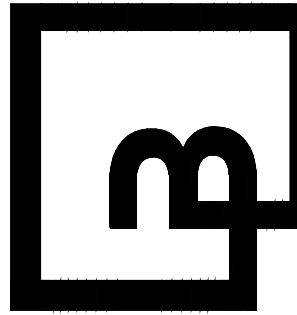

Job Number  
**20632**  
Sheet  
**3** of **3**

Date/Time: Apr 12, 2019 - 11:09am  
Scale: 1"=60'

File: P:\20000s\20632\survey\20632\A01.dwg  
chille Xrefs:

Title:

UPS-BOEING FIELD  
BFI-GATEWAY

For:

Scale:

Designed  
Drawn  
Checked  
Approved

\_\_\_\_\_  
kajl  
\_\_\_\_\_  
OBL  
\_\_\_\_\_  
OBL

Date 4/12/19

No.

Date

By

Ckd.

Appr.

Revision

TOPOGRAPHIC SURVEY  
PTN OF THE NE1/4 OF THE SW1/4  
AND THE NW1/4 & SW1/4 OF THE SE1/4  
OF SEC. 28, T24N, R4E, W.M.  
CITY OF SEATTLE, KING COUNTY, STATE OF WASHINGTON