

## PLANT MATERIAL SETBACK CHART

	GUARDRAIL BARRIER	EDGE OF ROADWAY	PATHS, TRAILS	WALL	FENCE	SIGNS	EXISTING TREE, TRUNK	EXISTING VEGETATION MASS
EVERGREEN TREE	15'	15'	10'	8'	8'	15'	10'	-
ORNAMENTAL/NATIVE DECIDUOUS TREE	6'	6'	10'	8'	8'	15'	10'	-
MEDIUM AND LARGE SHRUBS - GREATER THAN 3' TALL	5'	5'	8'	3'	3'	6'	5'	5'
SMALL SHRUB - LESS THAN 3' TALL	3'	5'	5'	2'	3'	2'	5'	5'

TYPICAL MINIMUM DISTANCE SETBACKS ARE TO THE CENTER STEM OR TRUNK OF PLANT MATERIAL UNLESS OTHERWISE DIRECTED BY THE ENGINEER DURING LAYOUT AND STAKING OF PLANT LOCATIONS.

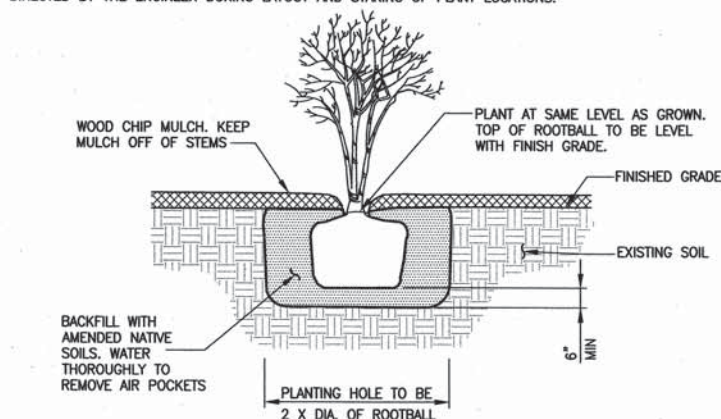

## SHRUB AND SMALL TREE PLANTING

## DETAIL

NO SCALE

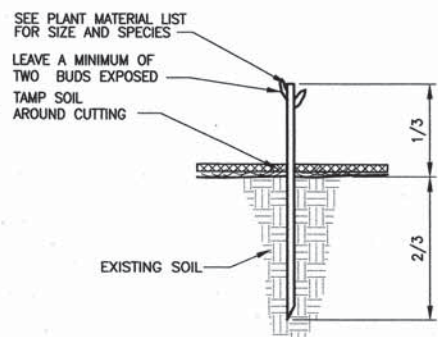

## LIVE STAKE INSTALLATION

## DETAIL

NO SCALE

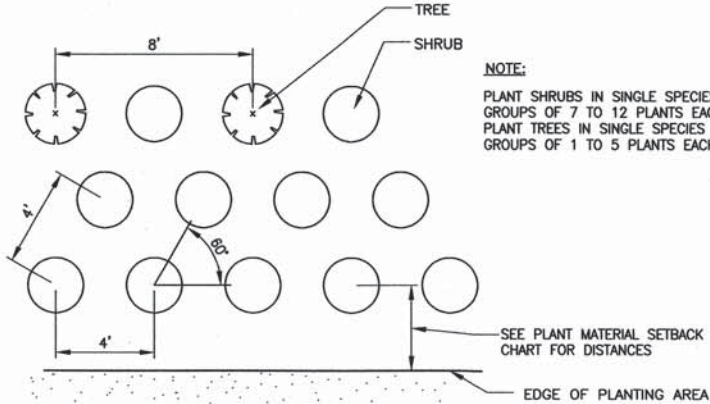

## TYPICAL TREE AND SHRUB SPACING

## DETAIL

NO SCALE

## SEC'S 8, 17 TWP. 24 N., RGE. 06 E, W.M.

NOTE:  
STAKE ALL TREES 3' AND TALLER.

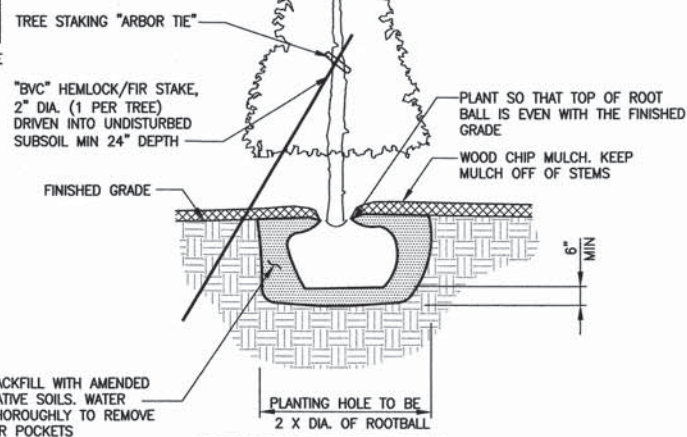

## CONIFEROUS TREE PLANTING

## DETAIL

NO SCALE

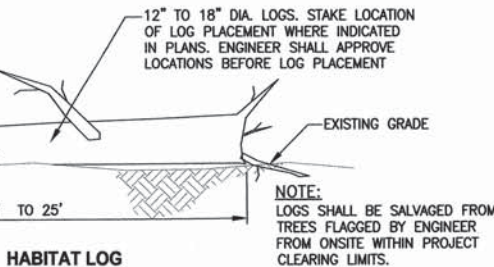

## HABITAT LOG

## DETAIL

NO SCALE

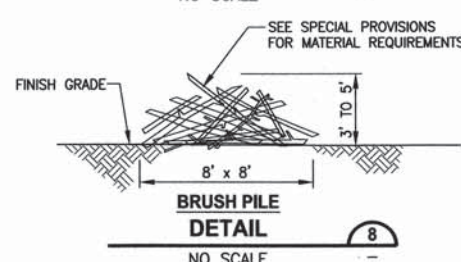

## BRUSH PILE

## DETAIL

NO SCALE

NOTE:  
STAKE ALL TREES 1" CALIPER AND GREATER.

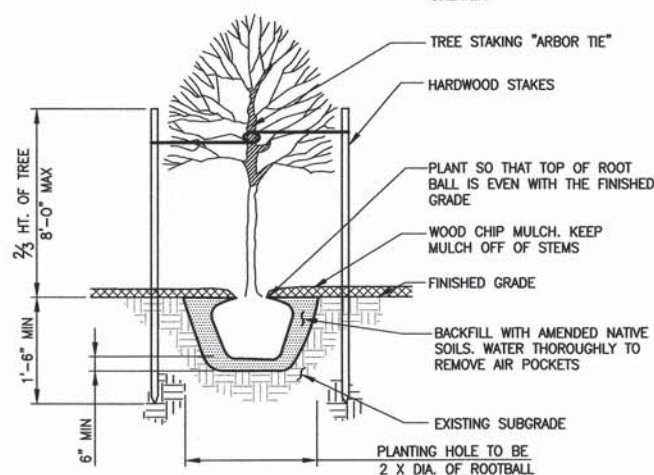

## DECIDUOUS TREE PLANTING

## DETAIL

NO SCALE

## MITIGATION AREA PLANT MATERIAL LIST

QUANTITY	BOTANICAL NAME	COMMON NAME	MIN SIZE/CONDITION	NOTES/SPACING
	TREES			
38	ACER CIRCINATUM	VINE MAPLE	1" CALIPER	SPACE 8' O.C.
51	ACER MACROPHYLLUM	BIG LEAF MAPLE	1" CALIPER	
75	AMELANCHIER ALNIFOLIA	WESTERN SERVICEBERRY	1" CALIPER	
72	CORNUS NUTTALLII	PACIFIC DOGWOOD	1" CALIPER	
72	PRUNUS EMARGINATA	BITTER CHERRY	1" CALIPER	
66	PSEUDOTSUGA MENZIESII	DOUGLAS FIR	3' HT	
12	SALIX SCOULERIANA	SCOUERS WILLOW	1" CALIPER	
59	THUJA PLICATA	WESTERN RED CEDAR	3' HT	
24	TSUGA HETEROPHYLLA	WESTERN HEMLOCK	3' HT	
	SHRUBS			
215	CORYLUS CORNUTA	WESTERN HAZEL	12" HT/ #1 CONT	SPACE 4' O.C.
120	PHILADELPHUS LEWISII	MOCK ORANGE	12" HT/ #1 CONT	
372	PHYSOCARPUS CAPITATUS	PACIFIC NINEBARK	12" HT/ #1 CONT	
291	OEMLERIA CERASIFORMIS	INDIAN PLUM	12" HT/ #1 CONT	
695	RIBES SANGUINEUM	FLOWERING RED CURRANT	12" HT/ #1 CONT	
849	ROSA NUTKANA	NOOTKA ROSE	12" HT/ #1 CONT	
856	SYMPHORICARPOS ALBUS	SNOWBERRY	12" HT/ #1 CONT	
	LIVE STAKE CUTTINGS			
47	SALIX LUCIDA	PACIFIC WILLOW	1/2"x 3' LIVE STAKE	SPACE 4' O.C.
47	SALIX SITCHENSIS	SITKA WILLOW	1/2"x 3' LIVE STAKE	

## TEMPORARY IRRIGATION IMPROVEMENTS - GENERAL NOTES:

1. VERIFY LOCATION OF EXISTING UTILITIES PRIOR TO CONSTRUCTION.
2. ALL WORK SHALL BE IN ACCORDANCE WITH SPECIFICATIONS SECTION 8-03 "IRRIGATION SYSTEMS".
3. CONTRACTOR SHALL PROTECT ALL EXISTING IMPROVEMENTS. DAMAGE TO THE EXISTING IMPROVEMENTS SHALL BE REPAIRED OR REPLACED TO THE SOLE SATISFACTION OF THE OWNER AT NO COST.
4. CONTRACTOR SHALL BE RESPONSIBLE FOR PROVIDING A SCALED IRRIGATION PLAN AND APPLICABLE CONSTRUCTION DETAILS WHICH GRAPHICALLY IDENTIFIES THE LOCATION, SIZES, AND TYPES OF IRRIGATION EQUIPMENT PROPOSED FOR REVIEW AND APPROVAL BY OWNER'S REPRESENTATIVE. CONTRACTOR SHALL ALSO FIELD VERIFY STATIC PRESSURE PRIOR TO DESIGN PREPARATION.
5. ALL WORK SHALL BE IN COMPLIANCE WITH STATE AND LOCAL CODES.
6. CONTRACTOR SHALL USE THE CONTRACTOR DESIGNED SYSTEM WHERE SHOWN ON PLANS OR WATERING TRUCK TO PROVIDE ADEQUATE WATER TO ALL PLANT MATERIAL BASED UPON ACTUAL FIELD CONDITIONS. THE AUTOMATIC TEMPORARY IRRIGATION SYSTEM SHALL PROVIDE A MINIMUM OF 1-INCH OF WATER PER WEEK FROM JULY 1ST THROUGH SEPTEMBER 30TH.
7. CONTRACTOR SHALL BE RESPONSIBLE FOR MAINTAINING IRRIGATION SYSTEM IN PROPER WORKING ORDER THROUGHOUT THE WARRANTY PERIOD AND MAKE REPAIRS AT NO ADDITIONAL COST TO CLIENT DURING 1-YR PLANT ESTABLISHMENT PERIOD. AFTER THE FIRST YEAR, THE COUNTY WILL MAKE PROVISIONS TO MAINTAIN THE TEMPORARY IRRIGATION SYSTEM.
8. LOCATE ALL VALVES WITHIN ONE (1) FOOT OF THE MAINLINE.
9. FIELD VERIFY ALL SPRINKLER HEAD LOCATIONS (FLAGGING) FOR REVIEW AND APPROVAL BY OWNER'S REPRESENTATIVE BEFORE TRENCHING.
10. CONTRACTOR SHALL BE RESPONSIBLE FOR SYSTEM REMOVAL AT END OF WARRANTY PERIOD AND RETURNING ANY IRRIGATION SYSTEM TO THE CLIENT.

## CITY OF SAMMAMISH APPROVAL

City Engineer: [Signature] Date: 11-01-16  
Community Development: [Signature] Date: 11-01-16

DPER ACTIVITY NUMBER  
GRDE14-0052 / SHORE14-0022  
FEDERAL AID # CM-2017(133)

PROJECT NAME

EAST LAKE SAMMAMISH  
MASTER PLAN TRAIL  
SOUTH SAMMAMISH SEGMENT A  
SAMMAMISH, WA

## LANDSCAPE DETAILS

SHEET NO.  
73 OF 78

LD1

## STEP 1

TILL, DISC OR RIP SOIL IN PLANTING AREAS TO 10" DEPTH. PLACE 3" OF SOIL AMENDMENT OVER SOIL SURFACE.

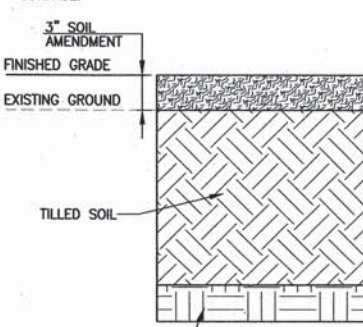

## STEP 2

TILL SOIL AMENDMENT INTO TOP 10" OF ENTIRE PLANTING ZONES NATIVE SOIL AFTER CLEARING AND GRUBBING.

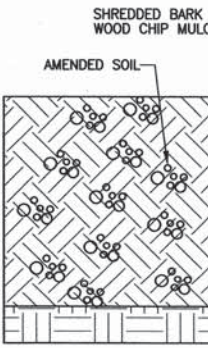

## PLANTING AREA SOIL AMENDMENT-SEQUENCE OF WORK

## DETAIL

NO SCALE

## STEP 3

INSTALL PLANTS FOLLOWED BY 3" WOOD CHIP MULCH.

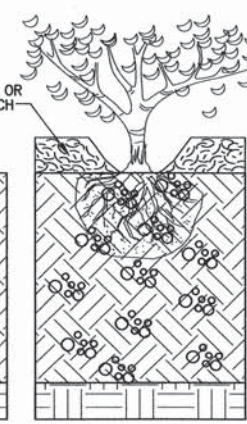

## TRAILSIDE RESTORATION PLANT MATERIAL LIST

QUANTITY	BOTANICAL NAME	COMMON NAME	MIN SIZE/CONDITION	NOTES/SPACING
TREES				
19	PSEUDOTSUGA MENZIESII	DOUGLAS FIR	6' HT	AS SHOWN ON PLAN
18	THUJA PLICATA	WESTERN RED CEDAR	6' HT	
13	THUJA PLICATA 'EXCELSA'	EXCELSA WESTERN RED CEDAR	6' HT	SPACE 6' TO 7' O.C.
SHRUBS				
38	ARBUTUS UNEDO 'COMPACTUS'	COMPACT STRAWBERRY TREE	36" HT/ #5 CONT	SPACE 5' O.C.
70	MYRICA CALIFORNICA	PACIFIC WAX MYRTLE	36" HT/ #5 CONT	SPACE 5' O.C.
22	MAHONIA AQUIFOLIUM	TALL OREGON GRAPE	36" HT/ #2 CONT	SPACE 5' O.C.
92	PHILADELPHUS LEWISII	MOCK ORANGE	36" HT/ #2 CONT	SPACE 5' O.C.
64	RIBES SANGUINEUM	FLOWERING RED CURRANT	36" HT/ #2 CONT	SPACE 5' O.C.
7	VIBURNUM DAVIDII	DAVIDS VIBURNUM	36" HT/ #2 CONT	SPACE 5' O.C.
12	VIBURNUM OPULUS	CRANBERRY BUSH	36" HT/ #2 CONT	SPACE 5' O.C.
LOW SHRUBS AND GROUND COVER				
2,983	GAULTHERIA SHALLON	SALAL	12" HT/ #1 CONT	
2,231	MAHONIA REPENS	CREeping OREGON GRAPE	12" HT/ #1 CONT	
2,231	POLYSTICHUM MUNITUM	SWORD FERN	12" HT/ #1 CONT	



STATE OF WASHINGTON  
LICENSED LANDSCAPE ARCHITECT  
JENNIFER SWENSON  
LICENSE NO. 956  
EXPIRES ON 10/31/17

## Parametrix

ENGINEERING, PLANNING, ENVIRONMENTAL SCIENCES

719 2ND AVENUE, SUITE 200 | SEATTLE, WA 98104  
P 206.394.3700  
WWW.PARAMETRIX.COM

REVISIONS	DATE	BY	DESIGNED
2	11/7/16	JS	J. SWENSON
			B. PURGANAN
			Y. HO
			O. KIKUTA

ONE INCH AT FULL SCALE, IF NOT, SCALE ACCORDINGLY
FILE NAME: BL1521075P20T03LD-01
DRAWN NO: 554-1521-075 P20T03
DATE: JANUARY 2016

1 MITIGATION GOALS, OBJECTIVES, AND PERFORMANCE STANDARDS

THE OVERALL GOAL OF THE MITIGATION IS TO REPLACE THE HABITATS AND FUNCTIONS LOST AS A RESULT OF THE PROJECT. SPECIFIC GOALS AND OBJECTIVES FORMULATED TO ACHIEVE THIS RESULT ARE PRESENTED BELOW.

1.1 MITIGATION GOALS

THE MITIGATION GOALS ARE:

- INCREASE AND ENHANCE THE BUFFER OF TWO WETLANDS (WETLANDS 12A AND 13A) BY 0.27 ACRE.
- ENHANCE 0.25 ACRE WITHIN THE EXISTING REGULATORY BUFFER OF TWO WETLANDS (WETLANDS 13A AND 14A).
- ENHANCE 0.02 ACRE OF EXISTING WETLAND (WETLAND 13A).
- ENHANCE 0.15 ACRE OF EXISTING STREAM BUFFER (SOUTH FORK OF STREAM 0163).

ACHIEVEMENT OF THESE GOALS IS EXPECTED TO PROVIDE THE FOLLOWING IMPROVEMENTS TO WETLAND, WETLAND BUFFER, AND STREAM BUFFER FUNCTIONS:

- INCREASE THE PRODUCTION OF ORGANIC MATTER BY PLANTING TREES AND SHRUBS IN WETLAND, WETLAND BUFFER, AND STREAM BUFFER AREAS.
- INCREASE FISH AND WILDLIFE HABITAT AND IMPROVE BIOLOGICAL DIVERSITY BY INSTALLING HABITAT FEATURES (HABITAT LOGS AND BRUSH PILES) AND PLANTING WITH A VARIETY OF NATIVE PLANT SPECIES THAT WILL CREATE MULTIPLE VEGETATION STRATA AS THEY MATURE.
- INCREASE VISUAL AND AURAL SCREENING OF EAST LAKE SAMMAMISH PARKWAY SE AND THE TRAIL FOR WILDLIFE PROTECTION AND HABITAT CONNECTIVITY.

1.2 MITIGATION OBJECTIVES AND PERFORMANCE STANDARDS

BUFFER PLANT COMMUNITIES

OBJECTIVE 1: ESTABLISH A MINIMUM OF 0.52 ACRE NATIVE FOREST AND SHRUB WETLAND BUFFER (AT THE INCREASED WETLAND BUFFER AND EXISTING WETLAND BUFFER AREAS) AND 0.15-ACRE NATIVE FOREST AND SHRUB STREAM BUFFER.

PERFORMANCE STANDARDS:

- YEAR 1 SURVIVAL OF PLANTED WOODY SPECIES IN THE ENHANCED WETLAND BUFFER AND ENHANCED STREAM BUFFER WILL BE AT LEAST 100 PERCENT.
- YEAR 3 NATIVE WOODY SPECIES WILL ACHIEVE A MINIMUM OF 35 PERCENT AERIAL COVER IN THE ENHANCED WETLAND BUFFER AND ENHANCED STREAM BUFFER.
- YEAR 5 NATIVE WOODY SPECIES WILL ACHIEVE A MINIMUM OF 60 PERCENT AERIAL COVER IN THE ENHANCED WETLAND BUFFER AND ENHANCED STREAM BUFFER.

OBJECTIVE 2: LIMIT INVASIVE NON-NATIVE SPECIES THROUGHOUT THE ENHANCED WETLAND BUFFER AND ENHANCED STREAM BUFFER MITIGATION PLANTING AREAS.

PERFORMANCE STANDARD:

- YEARS 1-5 KING COUNTY LISTED CLASS A AND REGULATED CLASS B AND C NOXIOUS WEEDS AND HIMALAYAN BLACKBERRY, CUTLEAF BLACKBERRY, SCOTCH BROOM, BUTTERFLY BUSH (BUDDLEIA DAVIDII), ENGLISH IVY, AND REED CANARYGRASS WILL NOT EXCEED 20 PERCENT AERIAL COVER IN THE PLANTING AREA.

YEARS 2-5 SURVIVAL OF PLANTED WOOD SPECIES SHALL BE AT LEAST 80%. REPLACEMENT PLANTINGS SHALL OCCUR AS NEEDED TO MEET THIS REQUIREMENT.

OBJECTIVE 3: ESTABLISH A MINIMUM OF 0.02 ACRE NATIVE SHRUB WETLAND.

PERFORMANCE STANDARDS:

- YEAR 1 SURVIVAL OF PLANTED WILLOW STAKES IN THE ENHANCED WETLAND WILL BE AT LEAST 100 PERCENT.
- YEAR 3 NATIVE WOODY SPECIES WILL ACHIEVE A MINIMUM OF 35 PERCENT AERIAL COVER IN THE ENHANCED WETLAND.
- YEAR 5 NATIVE WOODY SPECIES WILL ACHIEVE A MINIMUM OF 60 PERCENT AERIAL COVER IN THE ENHANCED WETLAND.

OBJECTIVE 4: LIMIT INVASIVE NON-NATIVE SPECIES COVER THROUGHOUT THE MITIGATION SITE PLANTING AREA.

PERFORMANCE STANDARD:

- YEARS 1-5 KING COUNTY LISTED CLASS A AND REGULATED CLASS B AND C NOXIOUS WEEDS AND HIMALAYAN BLACKBERRY, CUTLEAF BLACKBERRY, SCOTCH BROOM, BUTTERFLY BUSH (BUDDLEIA DAVIDII), ENGLISH IVY, AND REED CANARYGRASS WILL NOT EXCEED 10 PERCENT AERIAL COVER IN THE PLANTING AREA.

YEARS 2-5 SURVIVAL OF PLANTED WILLOW STAKES SHALL BE AT LEAST 80%. REPLACEMENT PLANTINGS SHALL OCCUR AS NEEDED TO MEET THIS REQUIREMENT.

WILDLIFE HABITAT

OBJECTIVE 5: PROVIDE ENHANCED WETLAND, RIPARIAN, AND UPLAND WILDLIFE HABITAT.

PERFORMANCE STANDARD:

- YEARS 1, 3, 5 THE INCREASE IN AERIAL COVER OF NATIVE WOODY SPECIES IN THE INCREASED WETLAND BUFFER, ENHANCED WETLAND BUFFER, ENHANCED STREAM BUFFER, AS MEASURED IN OBJECTIVES 1 AND 3, WILL BE USED AS A SURROGATE TO INDICATE INCREASING HABITAT FUNCTIONS.
- YEARS 1, 3, 5 THE INSTALLED HABITAT FEATURES (E.G. HABITAT LOGS AND BRUSH PILES) ARE TO BE PRESENT AND FUNCTIONAL.
- YEAR 5 THE HABITAT STRUCTURE WILL PROVIDE MULTIPLE LAYERS BY AS TREES AND SHRUBS GROW IN ENHANCED WETLAND BUFFER, ENHANCED WETLAND, AND ENHANCED STREAM BUFFER.

ANTHROPOGENIC DISTURBANCE

OBJECTIVE 6: PROTECT THE MITIGATION SITE FROM ANTHROPOGENIC DISTURBANCE.

PERFORMANCE STANDARD:

- YEARS 1-5 CONDUCT QUALITATIVE MONITORING TO ASSESS THE STATUS OF THE SITE ANNUALLY DURING THE 5-YEAR MONITORING PERIOD TO MONITOR FOR HUMAN DISTURBANCE, INCLUDING BUT NOT LIMITED TO FILLING, TRASH, AND VANDALISM.
- YEARS 1-5 INSTALL AND MAINTAIN FENCES AND APPROPRIATE SIGNS ALONG THE TRAIL AND ADJACENT TO EACH SITE TO IDENTIFY THEIR PROTECTED STATUS.

PHOTO-DOCUMENTATION OF SITE DEVELOPMENT

OBJECTIVE 7: DOCUMENT SITE DEVELOPMENT WITH PHOTOGRAPHS.

PERFORMANCE STANDARD:

PERMANENT PHOTOGRAPHIC STATIONS WILL BE ESTABLISHED TO MONITOR THE DEVELOPMENT OF THE ENHANCED WETLAND BUFFER AND ENHANCED STREAM BUFFER MITIGATION SITES. PHOTOGRAPHS WILL BE TAKEN FROM TRANSECT END POSTS AND FROM VANTAGE POINTS THAT CAPTURE THE GENERAL MITIGATION AREAS. ALL PHOTOGRAPHS WILL BE LABELED TO IDENTIFY LOCATIONS.

2 MONITORING AND MAINTENANCE

2.1 MONITORING

THE MITIGATION AREAS WILL BE MONITORED DURING AND AFTER CONSTRUCTION. DURING CONSTRUCTION, MONITORING WILL ENSURE THAT THE BMPs ARE OBSERVED TO MINIMIZE IMPACTS, AND THE ON-SITE CONSTRUCTION WORK (INCLUDING SITE PREPARATION AND PLANTING) WILL BE COORDINATED TO ENSURE THAT THE SITE IS CONSTRUCTED AS DESIGNED.

AFTER CONSTRUCTION IS COMPLETED, MONITORING WILL BE PERFORMED ANNUALLY TO ENSURE THAT THE GOALS AND OBJECTIVES OF THE MITIGATION EFFORTS ARE BEING MET. MONITORING OF THE MITIGATION AREAS WILL BE PERFORMED OVER A 5-YEAR PERIOD BY A QUALIFIED PROFESSIONAL (SMC 21A.50.145; 21A.50.350). A COMBINATION OF QUANTITATIVE AND QUALITATIVE MONITORING METHODS WILL BE USED TO ASSESS THE MANAGEMENT OBJECTIVES AND ASSOCIATED PERFORMANCE STANDARDS DESCRIBED IN THE MITIGATION PLAN. ACTIVITIES WILL INCLUDE SITE VISITS TO MONITOR UNNATURAL SITE DISTURBANCE, PHOTOGRAPHIC EVIDENCE TO DOCUMENT SITE DEVELOPMENT, AND DATA COLLECTION FOR THE QUANTITATIVE EVALUATION OF PERFORMANCE STANDARDS. THE RESULTS OF THE MONITORING WILL BE SUBMITTED TO APPLICABLE PERMITTING AGENCIES.

APPROPRIATE CONTINGENCY MEASURES WILL BE DEVELOPED, AS NEEDED, BY A QUALIFIED PROFESSIONAL TO ENSURE THAT THE SITE DEVELOPS HEALTHY VEGETATION THAT MEETS THE OBLIGATIONS DESCRIBED IN THIS MITIGATION PLAN AND THE ASSOCIATED PERMITS.

2.1.1 QUANTITATIVE MONITORING

THE FOLLOWING BULLETED ITEMS DESCRIBE THE METHODS TO BE USED FOR THE QUANTITATIVE MONITORING (YEARS 1, 3, AND 5), MONITORING SCHEDULE, AND REPORT DEADLINES:

- THE MITIGATION SITES WILL BE ASSESSED BY AN APPROPRIATE QUANTITATIVE FIELD METHODOLOGY TO EVALUATE VEGETATIVE COVER (E.G., THE LINE INTERCEPT METHOD) FOR DETERMINING THE PERCENT OF AERIAL COVER FOR DESIRABLE WOODY SPECIES AND INVASIVE SPECIES.
- THE PRESENCE OF INSTALLED HABITAT FEATURES WILL BE ASSESSED EACH YEAR DURING VEGETATION MONITORING.
- QUANTITATIVE VEGETATION ASSESSMENTS WILL FOLLOW THE SAME METHOD IN EACH CONSECUTIVE MONITORING YEAR.
- QUANTITATIVE VEGETATION ASSESSMENTS WILL BE PERFORMED BETWEEN JUNE 15 AND SEPTEMBER 15 OF EACH MONITORING YEAR.
- MONITORING REPORTS WILL BE SENT TO AGENCIES REQUIRING MONITORING REPORTS BY FEBRUARY 15 OF THE FOLLOWING YEAR.
- QUANTITATIVE MONITORING WILL INCLUDE PHOTOGRAPHIC DOCUMENTATION OF THE SITE FROM PERMANENT PHOTOGRAPH STATIONS.

2.1.2 QUALITATIVE MONITORING

QUALITATIVE ASSESSMENTS WILL BE PERFORMED YEARLY TO VISUALLY ASSESS THE HEALTH OF PLANTS AND IDENTIFY AREAS THAT MAY NEED CONTROL OF NON-NATIVE INVASIVE SPECIES OR OTHER MAINTENANCE ACTIVITIES.

2.2 MAINTENANCE

THE PROPOSED MITIGATION IS INTENDED TO ACHIEVE THE PERFORMANCE STANDARDS WITH MINIMAL ONGOING MAINTENANCE. HOWEVER, KING COUNTY WILL MANAGE AND MAINTAIN THE SITE FOR 5 YEARS, OR UNTIL ALL PERFORMANCE STANDARDS ARE MET AND THE SITE IS CLOSED WITH THE APPROVAL OF PERMITTING AGENCIES.

THE PLANTED VEGETATION SPECIES SHOULD BE ADAPTED TO VARYING SITE CONDITIONS IN THE PUGET SOUND LOWLAND; HOWEVER, SUPPLEMENTAL IRRIGATION MAY BE NEEDED DURING THE FIRST TWO GROWING SEASONS AFTER INSTALLATION TO ENSURE THE LONG-TERM SURVIVAL OF THE PLANTS. THE NEED FOR IRRIGATION WILL BE EVALUATED BASED ON THE CONDITIONS OBSERVED DURING THE ESTABLISHMENT PERIOD.

TO ENSURE RAPID ESTABLISHMENT OF THE PLANT COMMUNITY, TREES AND SHRUBS WILL BE PLANTED CLOSER TOGETHER THAN THE DISTANCES GENERALLY FOUND IN NATURAL MATURE STANDS. SOME NATURAL MORTALITY IS EXPECTED TO OCCUR DURING THE MONITORING PERIOD. ALL DEAD AND DOWNED WOODY MATERIAL WILL BE LEFT IN PLACE TO PROVIDE MICROHABITATS FOR WILDLIFE. PLANTS WILL BE REPLACED AS NEEDED TO MEET PERFORMANCE STANDARDS.

MAINTENANCE TO CONTROL NUISANCE PLANT SPECIES IN THE MITIGATION AREAS MAY BE NECESSARY. DURING THE MONITORING PERIOD, IF IT BECOMES EVIDENT THAT INVASIVE SPECIES ARE IMPEDING ESTABLISHMENT OF DESIRABLE NATIVE PLANTS, MEASURES WILL BE IMPLEMENTED TO CONTROL NUISANCE SPECIES. A PROGRESSIVELY AGGRESSIVE APPROACH WILL BE USED TO CONTROL NUISANCE SPECIES. CONTROL MEASURES WILL FIRST INCLUDE HAND CUTTING AND/OR GRUBBING AND REMOVAL; IF THIS FAILS, AN ENVIRONMENTALLY SENSITIVE HERBICIDE (E.G., RODEO OR EQUIVALENT) MAY BE APPLIED.

ADDITIONALLY, APPLICATION OF AN HERBIVORE REPELLENT (E.G., PLANTSKYDD®) MAY BE NECESSARY FOR ALL PLANTS WITHIN THE SITE UPON COMPLETION OF PLANT INSTALLATION TO MINIMIZE BROWSE AND OTHER DAMAGE TO PLANTS FROM WILDLIFE DURING THE ESTABLISHMENT PERIOD.

2.3 CONTINGENCY MEASURES

IF MONITORING INDICATES THAT THE SITE IS NOT MEETING PERFORMANCE STANDARDS, CONTINGENCY MEASURES WILL BE IMPLEMENTED (TABLE 2-1). SITE CONDITIONS WILL BE EVALUATED TO DETERMINE THE CAUSE OF THE PROBLEM AND THE MOST APPROPRIATE COUNTERMEASURES.

TABLE 2-1. CONTINGENCY MEASURES FOR THE MITIGATION SITE

PROBLEM	CONTINGENCY MEASURE
LESS THAN 80% OF PLANTED WOODY SPECIES SURVIVE IN YEAR 1	KING COUNTY BIOLOGISTS (OR OTHER QUALIFIED BIOLOGIST) WILL ASSESS THE SITES TO DETERMINE WHAT CONDITIONS ARE PREVENTING THE PLANTS FROM THRIVING. APPROPRIATE MEASURES WILL BE TAKEN TO CORRECT ANY CONDITIONS THAT ARE LIMITING GROWTH. LOST PLANTS WILL BE REPLACED WITH APPROPRIATE NATIVE SPECIES UNLESS APPROPRIATE NATIVE WOODY SPECIES ARE VOLUNTEERING AT A RATE SUFFICIENT TO REPLACE THEM. ADDITIONAL MEASURES (SUCH AS PROVIDING ADDITIONAL PROTECTION) WILL BE CONSIDERED IF NECESSARY.
PERCENT COVER FOR WOODY SPECIES NOT MET DURING YEARS 3 OR 5	KING COUNTY BIOLOGISTS (OR OTHER QUALIFIED BIOLOGIST) WILL ASSESS THE SITES TO DETERMINE WHAT CONDITIONS ARE PREVENTING THE PLANTS FROM THRIVING. APPROPRIATE MEASURES WILL BE TAKEN TO CORRECT ANY CONDITIONS THAT ARE LIMITING GROWTH.
INVASIVE SPECIES EXCEED PERCENT COVER THRESHOLD	IMPLEMENT/REVISE INVASIVE SPECIES CONTROL PLAN.
PERFORMANCE STANDARDS NOT MET AT YEAR 5	CONTINUE THE MONITORING REGIME FOR 1 ADDITIONAL YEAR. THE SITES WILL CONTINUE TO BE EVALUATED EVERY YEAR UNTIL THEY HAVE MET THE STATED PERFORMANCE STANDARDS ASSOCIATED WITH MANAGEMENT OBJECTIVES. OTHER CONTINGENCY MEASURES MAY BE IMPLEMENTED DURING THIS PERIOD.

INFORMATION FROM THE ANNUAL MONITORING PROGRAM WILL BE USED TO IDENTIFY ANY MAINTENANCE AND/OR CORRECTIVE ACTIONS. IF PROBLEMS ARE IDENTIFIED IN MONITORING, KING COUNTY BIOLOGISTS WILL DETERMINE THE CAUSE OF THE PROBLEM AND IMPLEMENT PROPER MAINTENANCE OR CORRECTIVE ACTIVITIES. THESE ACTIVITIES WILL BE DISCUSSED IN THE ANNUAL MONITORING REPORT.

NOTE: THE CONTRACTOR IS RESPONSIBLE FOR THE FIRST YEAR PLANT ESTABLISHMENT AND OTHER ASSOCIATED MAINTENANCE PER WSDOT SPECIFICATIONS. AFTER THE FIRST YEAR THE COUNTY WILL MAKE PROVISIONS TO MAINTAIN THE MITIGATION SITES. THE COUNTY WILL PERFORM THE ANNUAL MONITORING PROGRAM DESCRIBED ON THIS PLAN SHEET TO ASSESS ACHIEVEMENT OF PERFORMANCE STANDARDS.

PATH: U:\P50\Projects\Clients\1521-KingCo\554-1521-075-ELST\98Svcs\CADD\Phase 20\Task 03\DWG\ PLOTTED BY: purganan DATE: Thursday, November 03, 2016 10:15:52 AM LAYOUT: LD2

REVISIONS	DATE	BY	DESIGNED
2	CHANGE ORDER	11/7/16	JS
			J. SWENSON
			DRAWN
			B. PURGANAN
			CHECKED
			Y. HO
			APPROVED
			O. KIKUTA

ONE INCH AT FULL SCALE, IF NOT, SCALE ACCORDINGLY
FILE NAME
BL1521075P20T03LD-01
JOB No.
554-1521-075 P20T03
DATE
JANUARY 2016



STATE OF WASHINGTON  
LICENSED  
LANDSCAPE ARCHITECT  
J. SWENSON  
LICENSE NO. 656  
EXPIRES ON 10/31/17

Parametrix

ENGINEERING, PLANNING, ENVIRONMENTAL SCIENCES

719 2ND AVENUE, SUITE 200 | SEATTLE, WA 98104  
P 206.394.3700  
WWW.PARAMETRIX.COM

PROJECT NAME

EAST LAKE SAMMAMISH  
MASTER PLAN TRAIL  
SOUTH SAMMAMISH SEGMENT A  
SAMMAMISH, WA

DPER ACTIVITY NUMBER  
GRDE14-0052 / SHORE14-0022  
FEDERAL AID # CM-2017(133)

CITY OF SAMMAMISH APPROVAL	
	Date 11-10-16
	Date 11-10-16

LANDSCAPE DETAILS

SHEET NO.  
74 OF 78

LD2